

GOVERNMENT CORNER RESTORATION FORM

Township 28S Range 1W Sec. 18 County DOUGLAS

State OREGON Date 8-4-82 No. _____

Corner Designation

$\frac{1}{4}$ $\frac{S 18}{S 19}$

- _____ Condition Report Only
- _____ Not Found
- Renewed
- _____ Unrecorded
- _____ Surveyed In
- _____ Referenced Out

Previous Renewals

MONUMENT DETAIL

Monument(s) Found: (Condition and Source)

FD A 15" X 12" X 5" BASALT STONE
 BURIED 6 IN IN THE GROUND,
 NO VISIBLE MARKS AS RECORDED
 IN 1902 SURVEY, AT RECORD
 BRG AXIS DIST. FROM NW BT.

FROM WHICH:

Accessories Found:

AN ORIGINAL 14 IN. DIAM. FIR, NOW H 22 IN. DIAM.
 HEMLOCK BEARS N. 30° W. 11.9' FT. DIST WITH PARTIALLY
 HEHEED SINGLE PLAZE. VISIBLE SCRIBE "C"

AN ORIGINAL 24 IN. DIAM. FIR NOW H 43 IN. DIAM. BEARS
 S 48 1/2° E. 36.3 FT. DIST. (REC SE.) WITH PREVIOUSLY CHOPPED
 SINGLE PLAZE NOW HEHEED OVER

#374

RENEWAL

Monument Set (Procedure and Description)

Monument Detail

SINCE NO MARKINGS WERE FOUND ON STONE, I PULLED RECORD DISTANCES FROM BOTH ORIGINAL BT'S AT THIS POINT THE BEARING FOR THE NW TRBB WAS GOOD. HOLDING THIS POSITION I SET 1 1/2" x 30" IRON PIPE WITH BRASS CAP STAMPED "DOUGLAS CO. SURVEYOR T28S R1W 1/4 S18 1982" PROTRUDING 6 IN. ABOVE GROUND WITH 1.5 FT. DIAM. MOUND OF STONE. PLACED ORIGINAL STONE SOUTH SIDE OF CAP BENEATH SURFACE ON THIS POSITION FALLS AT THE FOUND STONE.

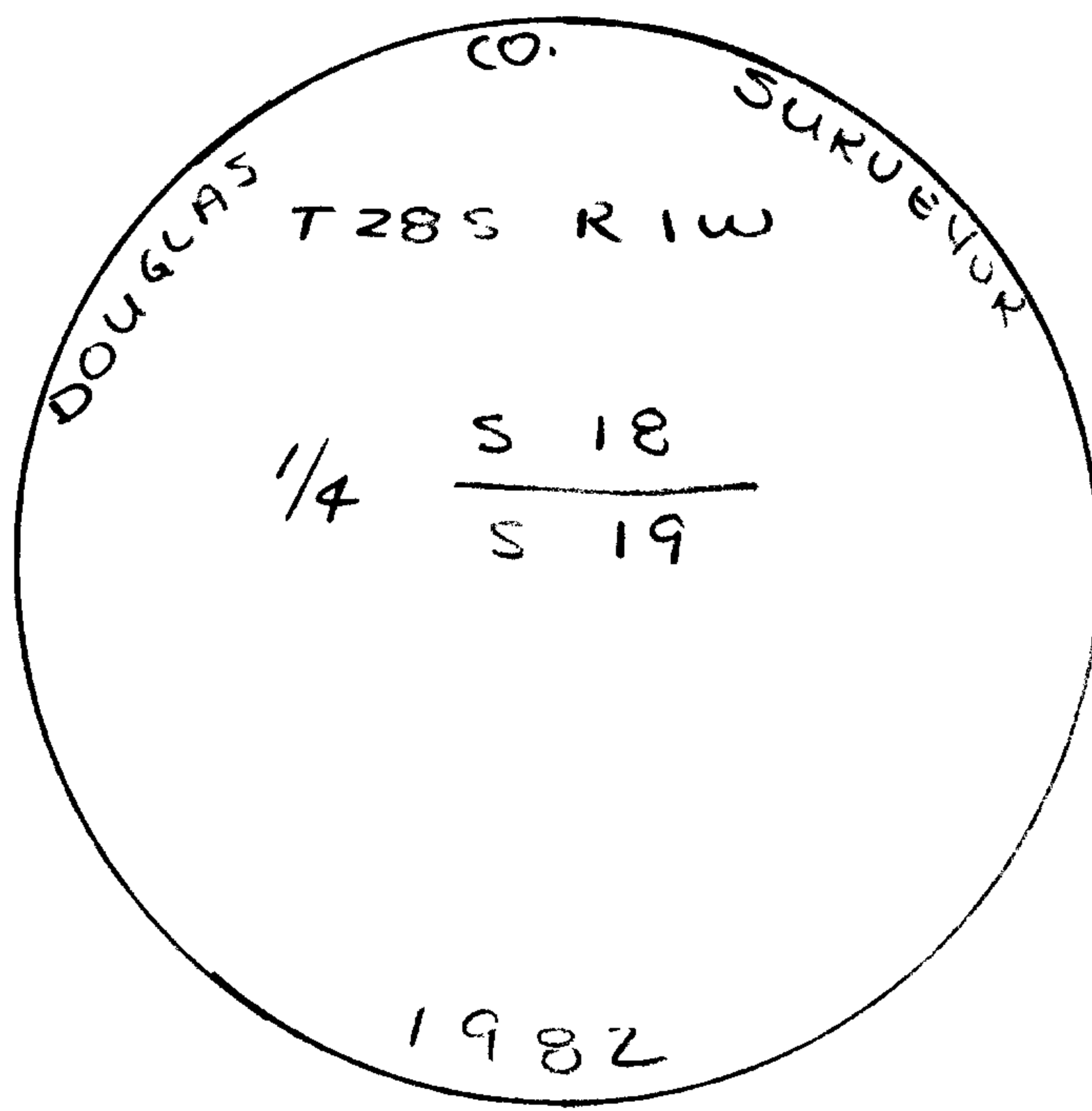

New Accessories

- A 7 IN. DIAM. HEMLOCK BEARS N 29 1/2° E, 25.3 FT. DIST. SCRIBED "1/4 S 18 CS BT" IN A DOUBLE CLASH
- A 14 IN. DIAM. HEMLOCK BEARS S. 86 1/2° W, 23.0 FT. DIST. SCRIBED "1/4 S 19 CS BT" IN A DOUBLE CLASH.

Sketch of Monument, Accessories, and General Area

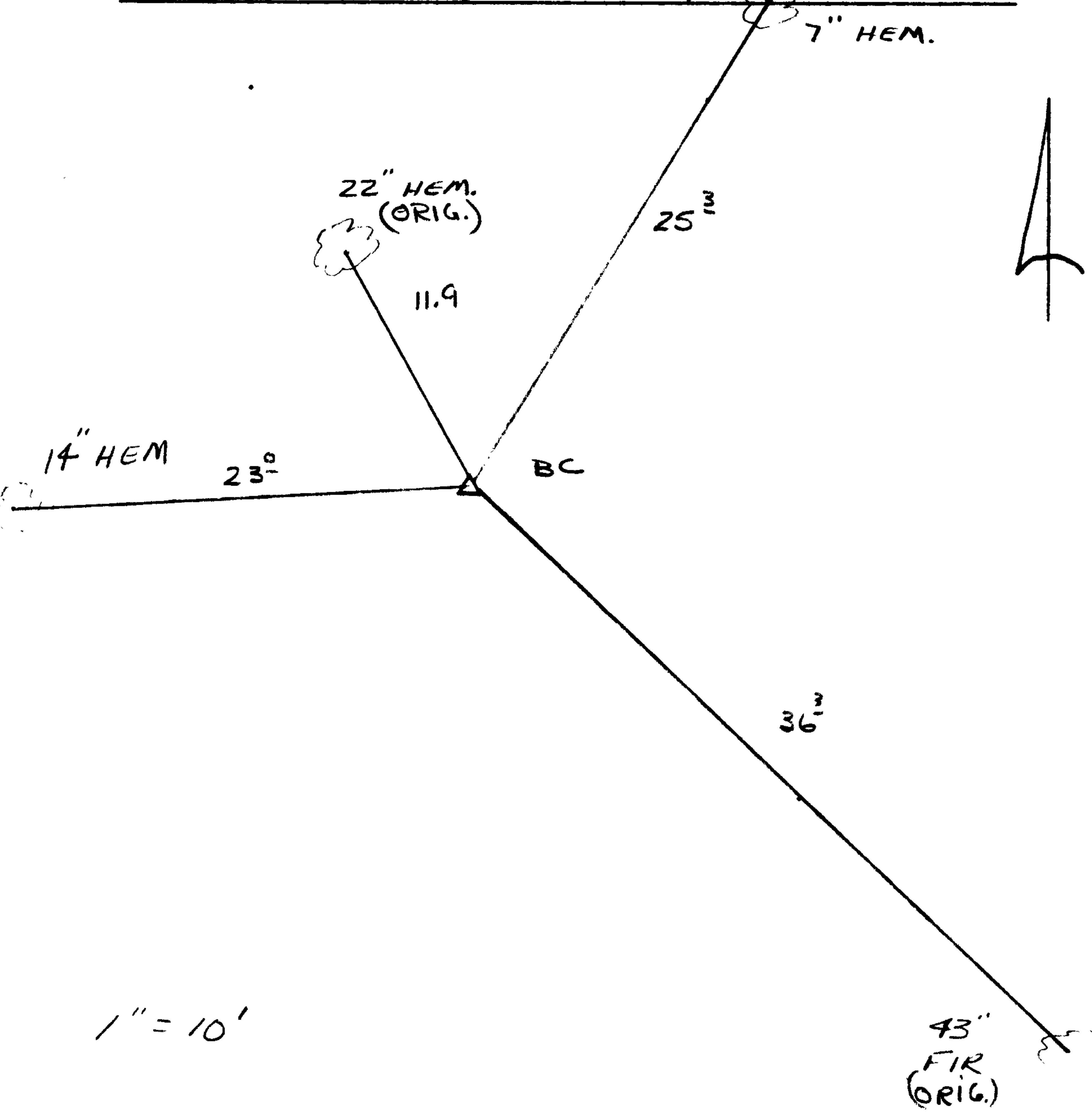

Location & Comments

CORNER FALLS ON A SW SLOPE APPROX 26°

Comp. Declin. 19° EAST
 Agency DCSD
 Party Chief KAREN P...
 Notekeeper KAREN ROED
 Witnesses TERRIE PLOUFF

OK JEM

Surveyor's Seal

REGISTERED
PROFESSIONAL
LAND SURVEYOR

Larry E. Monrean

OREGON
JULY 13, 1979
LARRY E. MONREAN
#1830

1" = 10'

43"
FIR
(ORIG.)