

GOVERNMENT CORNER RESTORATION FORM

Township 225 Range 6W Sec. 25 County DOUGLAS

State OR Date 8-3-82 No. _____

Corner Designation

T 225 R 6W
1/4 S 25
S 36

- _____ Condition Report Only
- _____ Not Found
- Renewed
- _____ Unrecorded
- _____ Surveyed In
- _____ Referenced Out

Previous Renewals #55

MONUMENT DETAIL

Monument(s) Found: (Condition and Source)

FD. 1/2 IP PER REN. #55 FIRMLY SET, FLUSH WITH GROUND, WITH 3/8" IR ALONGSIDE PROTRUDING 18" ABOVE GROUND.

Accessories Found:

FD. ORIG. 30" BLACK OAK NOW 48" ROTTED SNAG APPROX. 25' TALL WITH SCAIRED "1/1" VISIBLE ON PREVIOUSLY OPENED FACE, BEARS N 87 1/2° E 330± (REC. N 89° E 330±)

26" B. OAK PER REN #55 NOW 36" WITH GOOD SCARS BEARS S 20 E 223± (REC. S 19 E)

15" B. OAK PER REN. #55 NOW 24" WITH GOOD SCARS BEARS N 81 1/2 E 218± (REC. N 83 E)

#1424

C. S. File No. 62/1-2 C

RENEWAL

Monument Set (Procedure and Description)

Monument Detail

AT THE LOCATION OF FD. 1/2" IR I
 SET A 1" x 30" IP WITH BRASS CAP
 ATTACHED PROTRUDING 10" OUT OF GROUND.
 I PLACE 1/2" IP ALONGSIDE. 3/8" IR
 ALSO PLACED ALONGSIDE.

DOUGLAS T225 CO
 1/4 S 25
 4 S 36
 R 6 W SURVEYOR

1982

New Accessories

38" CEDAR SCRIBED "1/4 S 36 CS BT" IN DOUBLE BLAZE BEARS S 56 1/2 E 222 1/2.

Sketch of Monument, Accessories, and General Area

Location & Comments

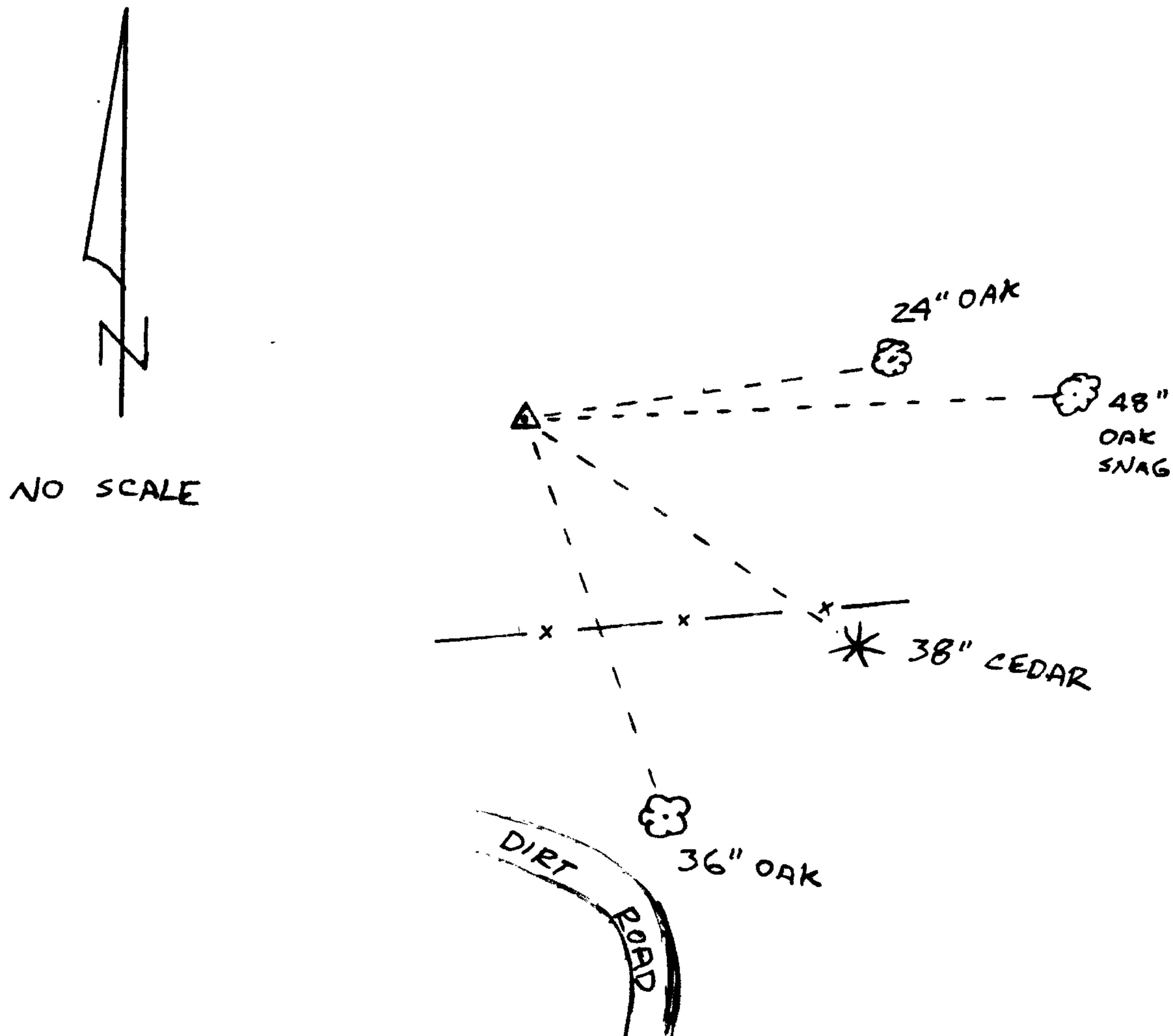

BT TAG PUT ON ALL
 TREES

Comp. Declin. 19°E
 Agency DCSO
 Party Chief GREGORY E. QUIBELL
 Notekeeper Gregory E. Quibell
 Witnesses KAREN REEP
 JOHN POWELL

Surveyor's Seal

REGISTERED
 PROFESSIONAL
 LAND SURVEYOR

Gregory E. Quibell

OREGON
 JULY 13, 1979
 GREGORY E. QUIBELL
 1874