

GOVERNMENT CORNER RESTORATION FORM

Township 26 S Range 9 W Section 23

County DOUGLAS State OR.

Date 5-26-82 No. _____

Corner Designation

T26S R9W

23	24
26	25

Condition Report Only
 Not Found
 Renewed
 Unrecorded
 Surveyed In
 Referenced Out

Previous Renewals _____

Monument(s) Found: (Condition and Source)

Accessories Found:

FD. ORIG. 50" FIR, NOW 76" STUMP WITH GOOD SCAR.
 FD. A TRIANGULAR SHAPED CEDAR STUMP, WHICH MEASURES 44" FROM CORNER TO CORNER, AT THE LOCATION OF THE ORIG. 10" CEDAR BT. THE STUMP IS CUT OFF TO LOW TO SHOW A FACE OR SCAR.
 FD. ORIG. 12" HEMLOCK, NOW 30" STUMP. I OPEN FACE AND FIND SCRIBED "R".
 ORIG. 16" HEMLOCK TAKEN OUT BY CAT ROAD.

Detail Found Monument

Detail Set Monument

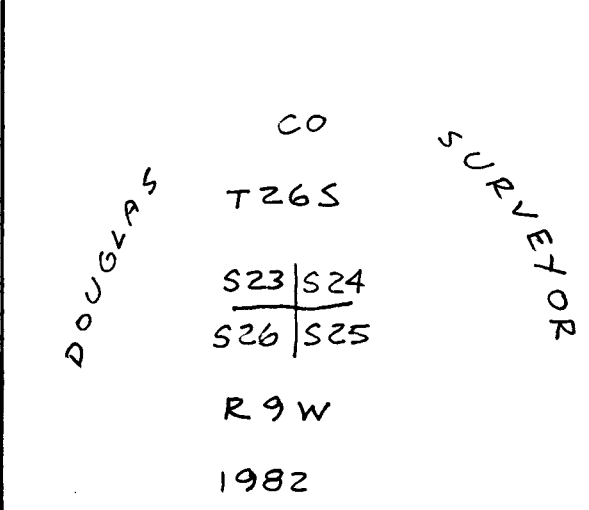

Monument Set (Procedure and Description)

USING RECORD DISTANCES FROM THE FACES OF THE FOUND BT'S I SET A 1" x 30" IP WITH BRASS CAP ATTACHED FOR THE SECTION COR. RECORD DISTANCE FROM THE CENTER OF THE 76" FIR WOULD NOT MEET THE INTERSECTION OF THE DISTANCES FROM THE OTHER 2 BT'S IT ALSO WOULD HAVE PLACED THE COR ON TOP OF AN APPROX. 8' x 8' BOUNDER. ORIG. NOTES SAY THAT A CEDAR POST WAS SET 24" INTO THE GROUND. THIS WOULD BE POSSIBLE ONLY BY USING THE FACE FOR DISTANCE.

New Accessories
 ORIG 50" FIR NOW 76" STUMP BEARS S16°E 44³ TO FACE & 42° TO "W" NAZ.
 ORIG. 10" CEDAR NOW 44" STUMP BEARS S33°W 36⁵ TO SPIKE IN TOP.
 ORIG. 12" HEMLOCK, NOW 30" STUMP BEARS N61°W 49⁵ TO FACE & 50° TO SPIKE IN TOP.
 SPIKE IN TOP OF 30" HEMLOCK STUMP BEARS N29°E 53³.

Location & Comments

Comp. Dec. 19° E
 Agency DCSO
 Party Chief GREGORY E. QUIBELL
 Notes Gregory E. Quibell
 Witnesses JOHN POWELL

Surveyor's Seal
 REGISTERED PROFESSIONAL LAND SURVEYOR
Gregory E. Quibell
 OREGON
 JULY 13, 1979
 GREGORY E. QUIBELL
 1834

~~3-5-82~~ 6/36-15

C

