

GOVERNMENT CORNER RESTORATION FORM

Township 27S Range 8W Section 16

County DOUGLAS State OR.

Date 5-13-82 No. _____

Corner Designation T 27S 8W

$\frac{1}{4}$ $\frac{S16}{S21}$

Condition Report Only
Not Found
 Renewed
Unrecorded
Surveyed In
Referenced Out

Previous Renewals _____

Monument(s) Found: (Condition and Source)

Accessories Found:

FD. ORIG. 10" NOW 15" STANDING, DEAD CEDAR WITH ROTTED OUT FACES IN UNHEALED DOUBLE BLAZE.

FD. ORIG. 15" NOW 17" CEDAR WINDFALL WITH ROTTED OUT FACES IN UNHEALED DOUBLE BLAZE.

Detail Found Monument

Detail Set Monument

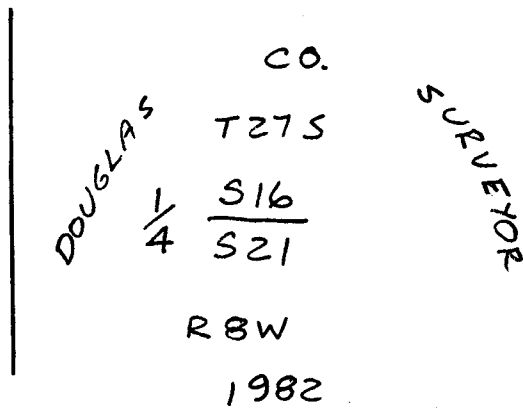

Monument Set (Procedure and Description)

USING THE RECORD DISTANCES FROM THE TWO ORIG. BT'S. I SET A 1"x30" IP WITH BRASS CAP ATTACHED APPROX 12" INTO THE GROUND AND THEN PLACE PILE OF ROCK AROUND IP.
BEARING & DISTANCES USED ARE AS FOLLOWS:
10" NOW 15" CEDAR BEARS N77W 35' (REC. N78W)
STUMP HOLE FROM 15" NOW 17" CEDAR BEARS S54W 35' (REC S67W)

New Accessories

9" HEMLOCK WITH "W" NAIL IN FACE SCRIBED "1/4 S21 CS BT" IN DOUBLE BLAZE BEARS S45W 33' TO NAIL.
10" HEMLOCK SCRIBED "1/4 S21 CS BT" IN DOUBLE BLAZE BEARS S8 1/2 W 11 1/2 FT.
48" FIR WITH "W" NAIL IN FACE BEARS N10°E 11 1/2 FT. TO NAIL.
10" HEMLOCK SCRIBED "1/4 S16 CS BT" IN DOUBLE BLAZE BEARS N53E 21 1/2 FT.

Location & Comments

Comp. Dec.

19° E

Agency

DCSO

Party Chief

GREGORY E. QUIBELL

Notes

Gregory E. Quibell

Witnesses

JOHN POWELL

Surveyor's Seal

REGISTERED PROFESSIONAL LAND SURVEYOR

Gregory E. Quibell

OREGON
JULY 13, 1979
GREGORY E. QUIBELL
1834

#67 ✓
G.E. Quibell 6/1/36-10

