

GOVERNMENT CORNER RESTORATION FORM

Township 27 S Range 8 W Section 15

County DOUGLAS State OR

Date 5-12-82 No. \_\_\_\_\_

Corner Designation T27S RBW

16 | 15  
21 | 22

Condition Report Only  
Not Found  
 Renewed  
Unrecorded  
Surveyed In  
Referenced Out

Previous Renewals \_\_\_\_\_

Monument(s) Found: (Condition and Source)

FD. UNRECORDED 3/4" IP FIRMLY SET PROTRUDING 10" OUT OF GROUND

Accessories Found:

1. FD. ORIG. 18" CEDAR, NOW 24" STUMP WITH SCRIBED "BT" VISIBLE IN PARTIALLY HEALED BLAZE.
2. FD. STUMP HOLE FROM ORIG. 16" CEDAR. POTTED REMAINS OF TREE LIES DOWNHILL APPROX 10' FROM HOLE. AN OLD TAG IS STILL ON TREE BUT NO FACE VISIBLE.
3. FD. ORIG. 20" FIR, NOW 25" STUMP SHOWS GOOD SCAR.
4. ORIG. 6" MADRONE IS COMPLETELY GONE.

Detail Found Monument

Detail Set Monument

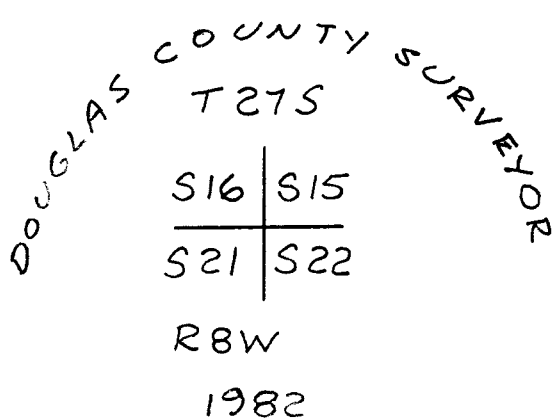

Monument Set (Procedure and Description)

USING THE THREE ORIG. BT'S FOUND, I SET A 1" x 30" IP WITH BRASS CAP ATTACHED. THE BEARINGS & DISTANCES USED ARE AS FOLLOWS:

- ORIG. 18" NOW 24" CEDAR STUMP BEARS N31°E 20<sup>±</sup>.
- ORIG. 16" CEDAR NOW STUMP HOLE BEARS S81°E 10<sup>±</sup>.
- ORIG. 20" NOW 25" FIR STUMP BEARS N52°W 25<sup>±</sup> (REG. N48°W)

FD. 3/4" IP BEARS S46°W 1<sup>±</sup> FT

New Accessories

- SPIKE IN TOP OF 36" CEDAR STUMP BEARS S43°E 5<sup>±</sup> FT. TO SPIKE
- SPIKE IN TOP OF 38" FIR STUMP BEARS S28<sup>±</sup>W 50<sup>±</sup> FT. TO SPIKE
- SPIKE IN TOP OF ORIG. 18" NOW 24" CEDAR STUMP BEARS N31°E 20<sup>±</sup> FT TO SPIKE.
- SPIKE IN TOP OF ORIG. 20" NOW 25" FIR STUMP BEARS N52°W 23<sup>±</sup> TO SPIKE.

Location & Comments

\_\_\_\_\_  
 \_\_\_\_\_  
 \_\_\_\_\_  
 \_\_\_\_\_  
JOHN POWELL  
TERRIE PLOUFF

Comp. Dec.

19°E  
 Agency DCSO  
 Party Chief GREGORY E. QUIBELL  
 Notes Gregory E. Quibell  
 Witnesses \_\_\_\_\_

Surveyor's Seal

REGISTERED  
 PROFESSIONAL  
 LAND SURVEYOR

Gregory E. Quibell

OREGON  
 JULY 13, 1979  
 GREGORY E. QUIBELL  
 1834

#691X  
 G.S. No. 61/36-9

