

GOVERNMENT CORNER RESTORATION FORM

Township 275 Range 8W Sec. 21 County DOUGLAS

State OR Date 5-3-82 No. _____

Corner Designation T 275 R 8W

$\frac{1}{4}$ $\frac{521}{528}$

- Condition Report Only
- Not Found
- Renewed
- Unrecorded
- Surveyed In
- Referenced Out

Previous Renewals _____

MONUMENT DETAIL

Monument(s) Found: (Condition and Source)

FD. UNRECORDED 3/4" IP FIRMLY SET
PROTRUDING 13" OUT OF GROUND.

FROM WHICH:

Accessories Found:

FD. ORIG. 18" NON 30" FIR STUMP WITH GOOD SCAR BEARS
332W 44¹ FT (REC. 42²)

FD. ORIG. 12" MAPLE STUMP, ROTTED AND BROKEN APART WITH POSSIBLE
REVERSE SCRIBED "B" SHOWING INSIDE STUMP BEARS N 60W 48¹.

RENEWAL

Monument Set (Procedure and Description)

Monument Detail

SINCE THE FD. 3/4" IP DID NOT FIT THE FIR BT WELL FOR DISTANCE AND SINCE THE MAPLE BT IS JUST BELOW AN OLD CAT RD AND LOOKS LIKE IT COULD POSSIBLY HAVE BEEN PUSHED OVER OR SLID OVER DUE TO THE ROAD WORK, I SET A 1" x 30" IP WITH BRASS CAP ATTACHED AT RECORD BEARING & DIST. FROM FIR BT. (N32E 422). THIS POSITION ALSO FITS THE MAPLE BT FAIRLY WELL (N58W 481) (REC N60W 481)

I LEAVE THE FD. 3/4" IP IN THE POSITION I FOUND IT (N32E 1/2 FROM SET BRASS CAP)

DOUGLAS CO. SURVEYOR
 T27S
 S21
 S28
 R8W
 1982

New Accessories ^{FACE OF}

"W" NAIL IN 30" FIR STUMP (ORIG BT) BEARS S32°W 41 1/2 FT.

"W" NAIL IN 17" HEMLOCK STUMP BEARS N6°W 13 1/2 FT.

"PK" NAIL IN TOP OF 15" HEMLOCK STUMP BEARS N89°W 7° FT.

Sketch of Monument, Accessories, and General Area

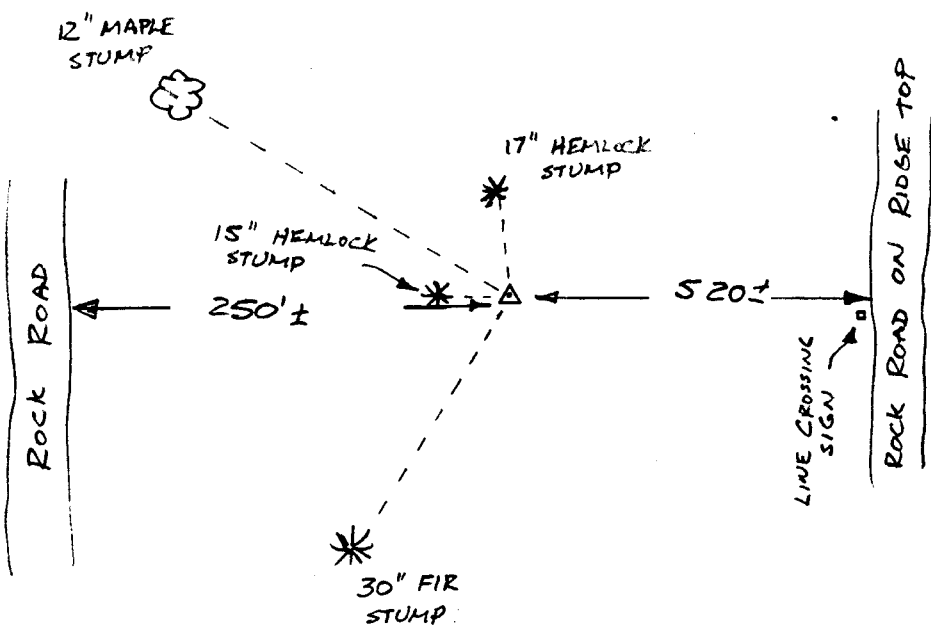

Location & Comments

Comp. Declin. 19° E
 Agency DC SO
 Party Chief GREGORY E. QUIBELL
 Notekeeper Gregory E. Quibell
 Witnesses JOHN POWELL

ok Jim

Surveyor's Seal

REGISTERED
 PROFESSIONAL
 LAND SURVEYOR

Gregory E. Quibell

OREGON
 JULY 13, 1979
 GREGORY E. QUIBELL
 1834