

GOVERNMENT CORNER RESTORATION FORM

Township 27S Range 8W Sec. 28 County DOUGLAS

State OR. Date 4-27-82 No. \_\_\_\_\_

Corner Designation T27S R8W

S29	S28
S32	S33

- Condition Report Only
- Not Found
- Renewed
- Unrecorded
- Surveyed In
- Referenced Out

Previous Renewals \_\_\_\_\_

MONUMENT DETAIL

Monument(s) Found: (Condition and Source)

Fd. UNRECORDED 1/2" x 24" IP LYING ON GROUND.

Accessories Found:

Fd. ORIG. 12" NOW 28" HEMLOCK STUMP. I CUT OPEN AND FIND SCRIBED "STR" POSITIONED AS PER DETAIL BELOW.

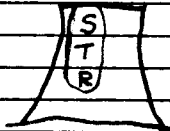

Fd. ROTTED REMAINS OF TWO STUMPS PROBABLY THE ORIG. NE & SE TREES. DUE TO THEIR CONDITION PLUS DISTURBANCE BY PAST LOGGING I CAN NOT DETERMINE THE EXACT LIMITS OF EITHER STUMP.

ORIG. SW TREE IS GONE

Fd. UNRECORDED 15" HEMLOCK STUMP WITH WEYERHAEUSER "W" NAIL.

Fd. UNRECORDED 38" HEMLOCK STUMP WITH WEYERHAEUSER "W" NAIL.

#594

C561/30-28 U

RENEWAL

Monument Set (Procedure and Description)

AT REC. BEARING AND DIST. FROM  
 FD. ORIG. 12" NOW 28" HEMLOCK  
 (S 65° E 31' FT) I SET A 1" X 30" IP  
 WITH BRASS CAP ATTACHED. RECORD  
 BEARING & DIST. FOR NE BT (N 30° E 33')  
 HITS DECAYED WOOD. RECORD BEARING &  
 DIST. FOR SE BT (S 46° E 85') HITS  
 DECAYED WOOD.

I PLACE UNRECORDED 1/2" IP ALONGSIDE  
 BRASS CAP.

Monument Detail

DOUGLAS COUNTY SURVEYOR

T 27 S

S 29	S 28
S 32	S 33

R 8 W

1982

New Accessories

FACE OF  
 "W" NAIL IN A 15" HEMLOCK STUMP BEARS N 4° E 24' TO NAIL.

"W" NAIL IN FACE OF 38" HEMLOCK STUMP BEARS S 60° E 10' TO NAIL.

"W" NAIL IN SIDE OF ORIG. NW BT (28" HEMLOCK STUMP) BEARS N 65° W 29'

Sketch of Monument, Accessories, and General Area

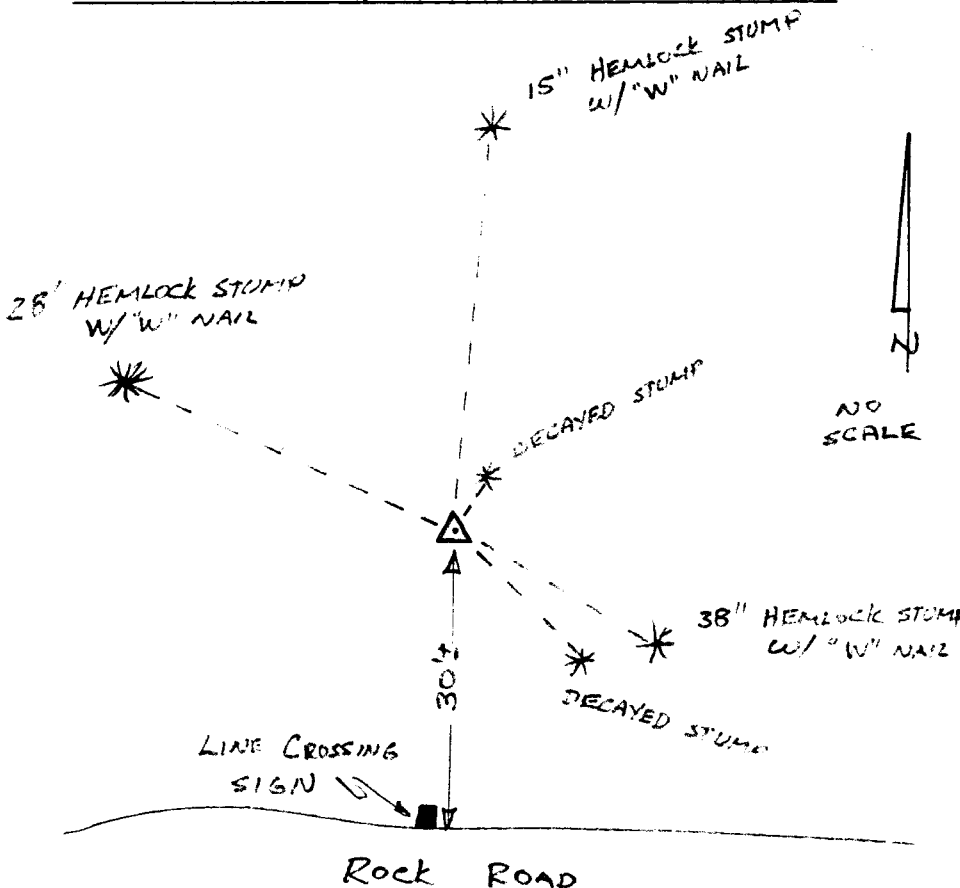

Location & Comments

Comp. Declin. 19° E  
 Agency DCSC  
 Party Chief GREGORY E. QUIBELL  
 Notekeeper Gregory E. Quibell  
 Witnesses KAREN REED  
 TERRY FLOUFF

Surveyor's Seal

REGISTERED  
 PROFESSIONAL  
 LAND SURVEYOR

*Gregory E. Quibell*

OREGON  
 JULY 13, 1979  
 GREGORY E. QUIBELL  
 1834

OK  
 JEM