

RENEWAL

Monument Set (Procedure and Description)

Monument Detail

I SET A 1" x 30" IP. WITH BRASS CAP ATTACHED AT REC. BEARING & DIST. FROM THE 14" CHINQUAPIN WINDFALL. N 85° E 152 FT. (23 LINKS) THE 14" CHINQUAPIN SNAG MATCHES REC. FOR BEARING (S TO E) BUT NOT FOR DIST. 238 FT. (36 links) REC. 56 links. IF ORIG. NOTES HAVE A 20 LINK ERROR, THEN THIS TREE WOULD ALSO MATCH REC.

THE TWO FIR BT'S MENTIONED IN REN. # 171 PLUS THE 10" HEMLOCK STUMP MENTIONED IN REN. #171 DO NOT FIT WITH THIS COR., BUT INSTEAD FIT WITH A 1 1/2" FIR STAKE WHICH BEARS S 70° E 8 3/4 FT. FROM SET BRASS CAP. I SCRATCH "VOID" ACROSS EXISTING BT TAGS ON THESE TREES.

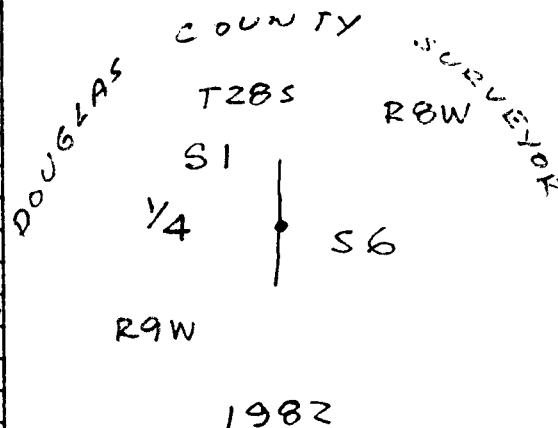

New Accessories

7" FIR SCRIBED "1/4 S BT" (PER REN. 171) BEARS N 53 1/2° E 11° FT (SCRIBING DOES NOT FACE COR.)
 8" FIR SCRIBED "1/4 S BT" (PER REN. 171) BEARS S 54° E 4 3/4 FT. (SCRIBING DOES NOT FACE COR.)

7" FIR SCRIBED "1/4 S | CS BT" IN DOUBLE BLAZE BEARS N 28 1/2° W 6 3/4 FT.
 8" FIR SCRIBED "1/4 S | CS BT" IN DOUBLE BLAZE BEARS S 4° W 18 1/2 FT.

10" HEMLOCK STUMP WITH "W" NAIL IN FACE BEARS N 66° E 45° FT.

Sketch of Monument, Accessories, and General Area

Location & Comments

NO SCALE

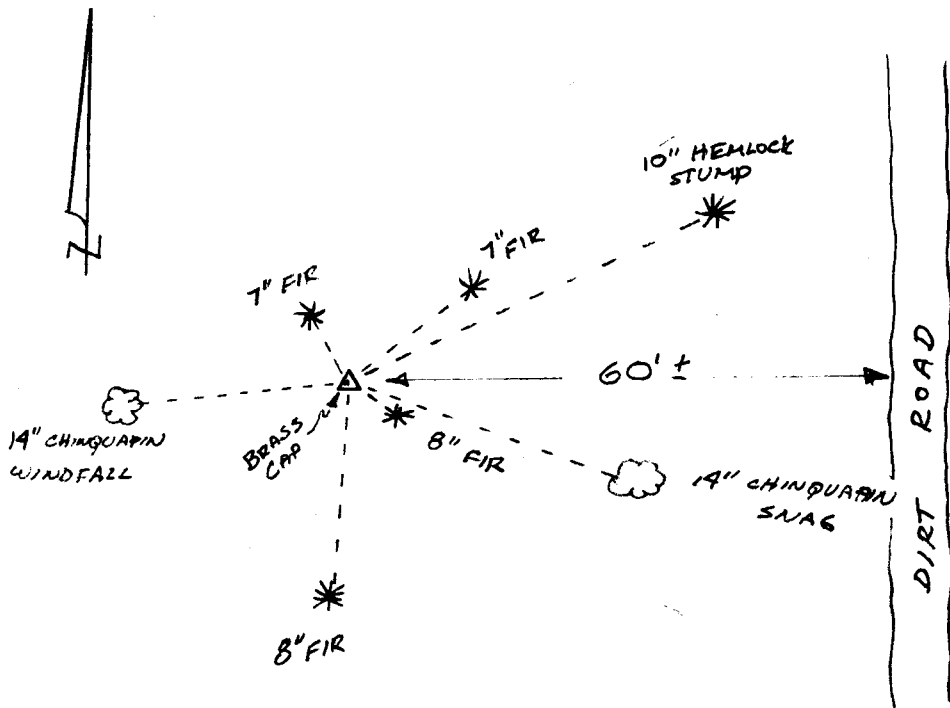

BRUSHED LINE RUNS NORTH & SOUTH OUT OF COR. LINE CROSSING TAG SOUTH APPROX 500 FT.

Comp. Declin. 19° E
 Agency DCSO
 Party Chief GREGORY E. QUIBELL
 Notekeeper Gregory E. Quibell
 Witnesses KAREN REED

Surveyor's Seal

REGISTERED PROFESSIONAL LAND SURVEYOR
Gregory E. Quibell
 OREGON
 JULY 13, 1979
 GREGORY E. QUIBELL
 1834

Section 6 Twp 28 S Rge 8 W W

Date: 3-26-82

How was corner identified? Original ~~chinquapin~~ rotting snag with scribing inside

Condition of corner: One chinquapin BT is down and rotted out.

Other BT still has scribing inside but is now a 12' rotting snag.

Best route to reach corner: _____

Also found 10" Hemlock stump N 57E 392' w/wegachawasser Tag & nail

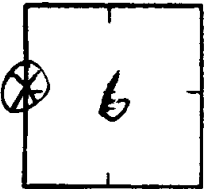

Quadrant	NE	NW	SE	SW
Species & Size	7" FIR		14" chinquapin	8" FIR
Dist. & Bearing	N 04° E 9 1/2'			S 89-30 W 4 1/2'
Condition of Scribe	1/4 S BT			1/4 S BT
Original or Resurvey				
Appearance of B.T.				
Tags, Marks, etc.	Painted Red BT TAG			BT TAG Paint Red

Other Remarks:

I scribed 2 additional BTs which had wegachawasser
Nails (W) in them. Old BT still remaining.

Corner is 2" stake
Joyd Wandersulden
Signed.

LS 1047

CS 61/30-21