

RENEWAL

Monument Set (Procedure and Description)

Monument Detail

AT RECORD BEARING & DIST. FROM ORIG.
 20" SPRUCE (N18 1/2 E 44 1/2 FT) I SET
 A 1" x 30" IP, WITH BRASS CAP
 ATTACHED, PROTRUDING 7" OUT OF
 GROUND. CAP IS MARKED AS PER
 DETAIL ON RT.

DOUG. COUNTY SURVEYORS OFFICE
 T22S R12W
 58
 517 1/4
 1982

New Accessories

30" DOUBLE SPRUCE WITH SCRIBED "1/4 S8CS BT" IN DOUBLE BLAZE BEARS N16°E 17 1/2 FT.
 20" SPRUCE SCRIBED "1/4 S8CS BT" IN DOUBLE BLAZE BEARS N67°E 32 1/2 FT.
 17" SPRUCE SCRIBED "1/4 S17CS BT" IN DOUBLE BLAZE BEARS S23°E 27 1/2 FT.
 15" FIR SCRIBED "1/4 S17CS BT" IN DOUBLE BLAZE BEARS S53°W 19 1/2 FT.

Sketch of Monument, Accessories, and General Area

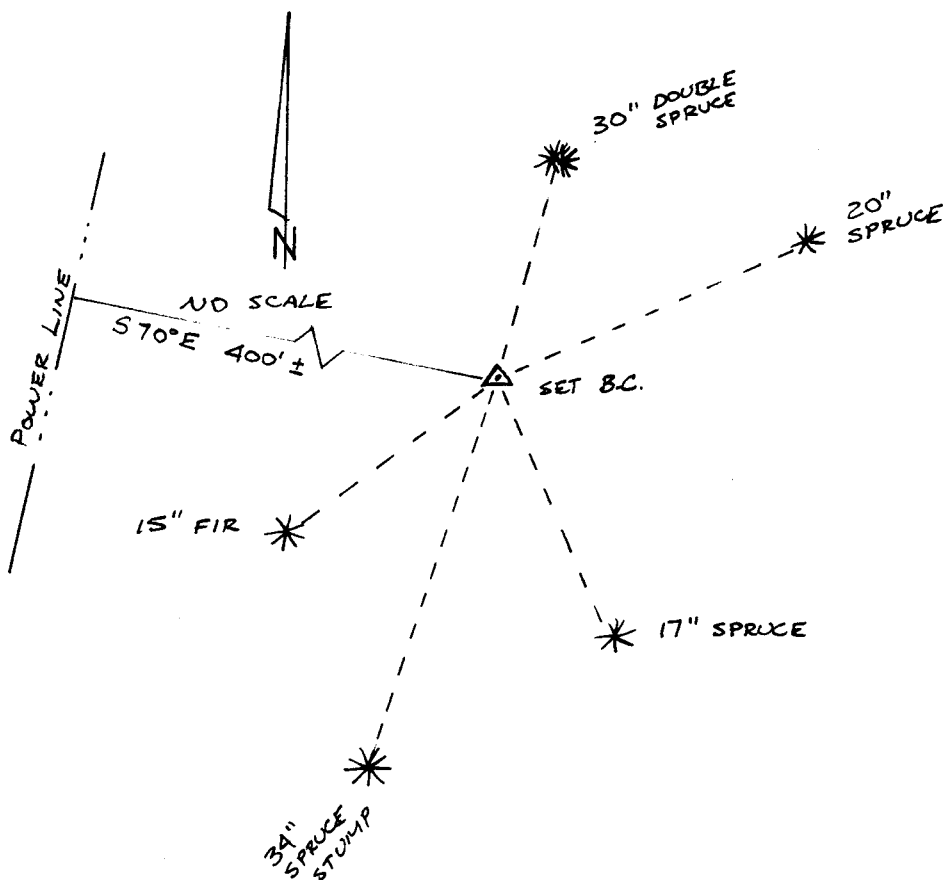

Location & Comments

Comp. Declin. 19° E
 Agency DC SO
 Party Chief LARRY E. MONREAN
 Notekeeper Gregory E. Zwickell
 Witnesses KAREN REED
 JOHN POWELL

Surveyor's Seal

REGISTERED
 PROFESSIONAL
 LAND SURVEYOR

Larry E. Monrean

OREGON
 JULY 13, 1979
 LARRY E. MONREAN
 #1830