

GOVERNMENT CORNER RESTORATION FORM

Township 22S Range 12W Sec. 33 County DOUGLAS (COUNTY LINE)

State OR. Date 2-23-82 No. _____

Corner Designation

T 22S

S33	S34	R
		12
S4		W

T 23S

- _____ Condition Report Only
- _____ Not Found
- Renewed
- _____ Unrecorded
- _____ Surveyed In
- _____ Referenced Out

Previous Renewals #145

MONUMENT DETAIL

Monument(s) Found: (Condition and Source)

FD. 2" x 36" GALVANIZED I.P. PER REN. #145
FIRMLY SET PROTRUDING 8" OUT OF GROUND.

Accessories Found:

- ① FD. 20" CHERRY (NOW DEAD) PER REN. #145, WITH SCRIBED "BT S T"
VISIBLE IN PARTIALLY BURNED UNHEALED FACE, BEARS N 33 E 19.2 FT.
(REC. 18.4 FT)
- ② FD. 70" HEMLOCK PER REN. #145, NOW 48" STUMP WITH SCRIBED
"BT S4 T23 R12" VISIBLE IN UNHEALED FACE BEARS S53°E 70³ FT
(REC. 75⁴)
- ③ FD. 34" HEMLOCK PER REN. #145, NOW 65" STUMP WITH SCRIBED
"S33 T22 R12" VISIBLE IN UNHEALED FACE, BEARS S79°30'W 40⁶ FT.
(REC. 38°)

NOTE: REC. DISTANCES WERE POSSIBLY TAKEN TO FACE
 OF TREE INSTEAD OF CENTER.

#154+

RENEWAL

Monument Set (Procedure and Description)

Monument Detail

AFTER REFERENCING FD. 2" IP. I SET A 1"x36" IP WITH BRASS CAP ATTACHED IN ITS PLACE. BRASS CAP IS MARKED AS PER DETAIL ON RT. THE FD. 2" IP WAS BURIED ALONG NORTH EDGE OF BRASS CAP. A GREEN METAL FENCE POST WAS ALSO PLACED JUST NORTH OF COR.

DOUGLAS CO SURVEYOR
 T22 S
 S33 | S34
 S4 R
 T23 S 12 W
 1982

New Accessories

- ① SET BOAT SPIKE STAMPED "B01" IN FACE OF 20" CHERRY BT. PER REN. 145, BEARS N33E 18² FT.
- ② SET BOAT SPIKE STAMPED "B02" IN TOP OF 72" HEMLOCK STUMP, BEARS ~~N~~ 69° E 143² FT.
- ③ SET BOAT SPIKE STAMPED "B03" IN FACE OF 48" HEMLOCK BT. PER REN 145, BEARS S 53° 30' E 75² FT.
- ④ SET BOAT SPIKE STAMPED "B04" IN TOP OF 36" HEMLOCK STUMP, BEARS S 37¹/₂ W 87² FT.
- ⑤ SET BOAT SPIKE STAMPED "B05" IN TOP OF 65" HEMLOCK (STUMP) BT PER REN. 145, BEARS S81W 39² FT.

METAL FENCE POST WITH SURVEY MARKER SIGN \perp LINE CROSSING TAG BEARS SOUTH 25² FT.

Sketch of Monument, Accessories, and General Area

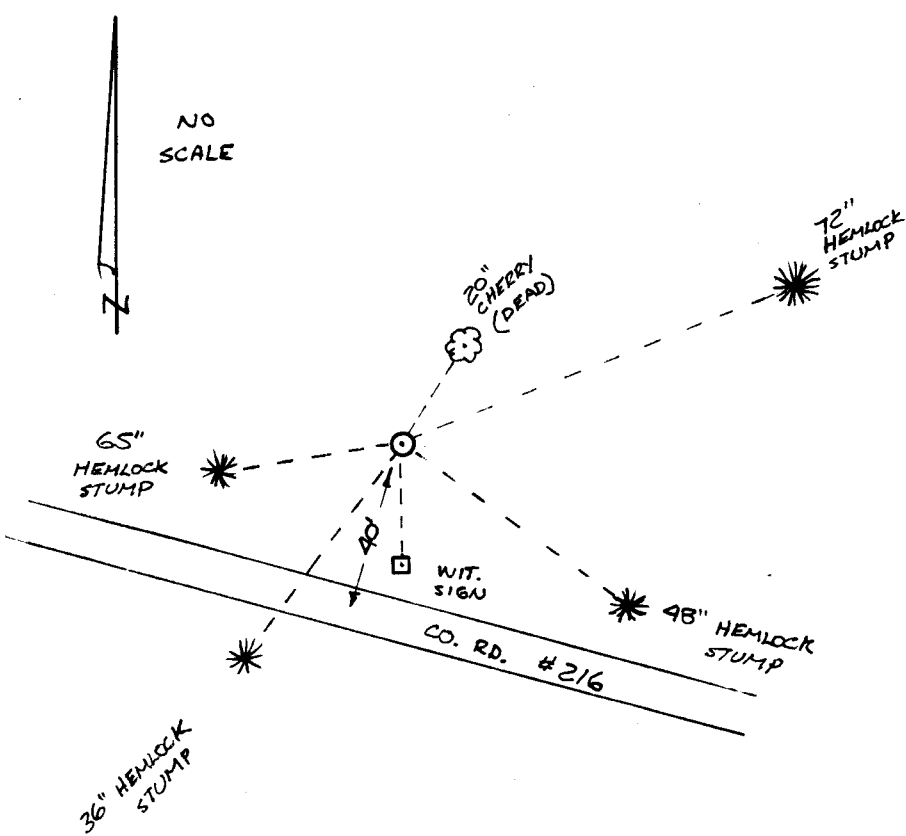

Location & Comments

BT. TAGS ON ALL STUMPS.
 COR LIES IN NEW CLEARCUT.

Comp. Declin. 19° E
 Agency DCSO
 Party Chief GREG QUIBELL
 Notekeeper Gregory E. Quibell
 Witnesses TERRIE PLOUFF

[Handwritten signature]

Surveyor's Seal

REGISTERED PROFESSIONAL LAND SURVEYOR

Gregory E. Quibell

OREGON
 JULY 13, 1979
 GREGORY E. QUIBELL
 1834