

DATE: Nov. 24, 1981

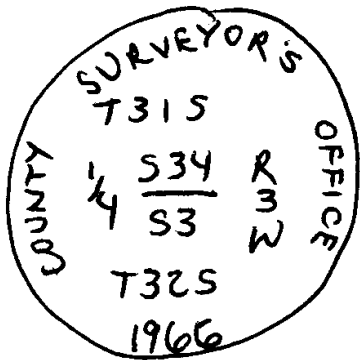

- Condition Report Only
- Not Found
- Renewed
- Unrecorded
- Surveyed In
- Referenced Out

Previous Renewal #'s T325 47 T315 13, 168 (168)

Monument(s) Found: (Condition and Source) \_\_\_\_\_  
1 1/4" I.P., FIRMLY SET, PROJECTING 8" ABOVE GROUND,  
WITH BRASS CAP MARKED AS ABOVE, SET  
BY JOHN POWELL, DOUGLAS COUNTY SURVEYOR'S  
OFFICE, IN 1966. 1 1/2" I.P. ALONGSIDE. (OUTSIDE DIAMETER)

Accessories Found: (Condition and Source) \_\_\_\_\_  
BTS MARKED BY WENDEROTH IN 1947:  
A ROOT HOLE, N39 1/2° E, 182 FT. WITH 12" O. FIX LOG ALONGSIDE,  
WITH FRAGMENTARY  
SCRIBE MARKS VISIBLE ON PARTLY HEALED DOUBLE  
BLAZE.  
A ROOT HOLE, S71 1/2° E, 123 FT. WITH ROTTEN LOG ALONGSIDE  
WITH NO MARKS VISIBLE.

# 244 (T31-3) ✓  
 # 210 (T32-3) ✓

AND BTS MARKED BY POWELL IN 1966:

A 10" D. FIR, N 28° W, 23<sup>8</sup> FT., WITH HEALED DOUBLE BLAZE.

A 9" W. FIR, S 71<sup>1</sup>/<sub>2</sub>° W, 18<sup>8</sup> FT., WITH HEALED DOUBLE BLAZE.

RENEWAL

Monument Set: (Procedure and Description)

New Accessories: (Description)

Location and Comments:

U.S.F.S.  
LEONARD HERZSTEIN  
JIM HAMILTON

Compass Declination  
Agency  
Party Chief  
Notekeeper  
Witnesses

OK 