

GOVERNMENT CORNER RESTORATION FORM

Township 28 S Range 3 W Sec. 28 County DOUGLAS

State OREGON Date 11-23-81 No. _____

Corner Designation

T 28 S R 3 W
1/4 S 28
S 33

- Condition Report Only
- Not Found
- Renewed
- Unrecorded
- Surveyed In
- Referenced Out

Previous Renewals # 48

Monument(s) Found: (Condition and Source)

FOUND BRASS CAP PER RENEWAL #48 PROTRUDING 18" ABOVE GROUND. ALSO FOUND ORIG. 6"X8"X14" STONE NOW 6"X11"X12" STONE WITH FAINT "1/4" ON NORTH FACE LYING ALONG SIDE OF BRASS CAP.

MONUMENT DETAIL

COUNTY SURVEYORS OFFICE
T 28 S R 3 W
1/4 S 28
S 33
1962

Accessories Found:

- ① FOUND ORIG. 12" (NOW 17") CEDAR, BEARS S 22° E 17.5 FT (REC. 16.5 FT) WITH PARTIALLY HEALED BLAZE, WITH "S3" VISIBLE.
- ② FOUND ORIG. 24" (NOW ROTTEN 24") HEMLOCK SNAG APPROX. 20 FT TALL, BEARS N 14° E 9.6 FT (REC. 9.2 FT), WITH NO FACE VISIBLE.
- ③ FOUND 6" (NOW 13") FIR PER RENEWAL #48, BEARS N 42° E 14 FT WITH GOOD SCAR.

#155 ✓

C. S. File No. 61/22-31 C

Monument Set (Procedure and Description)

Monument Detail

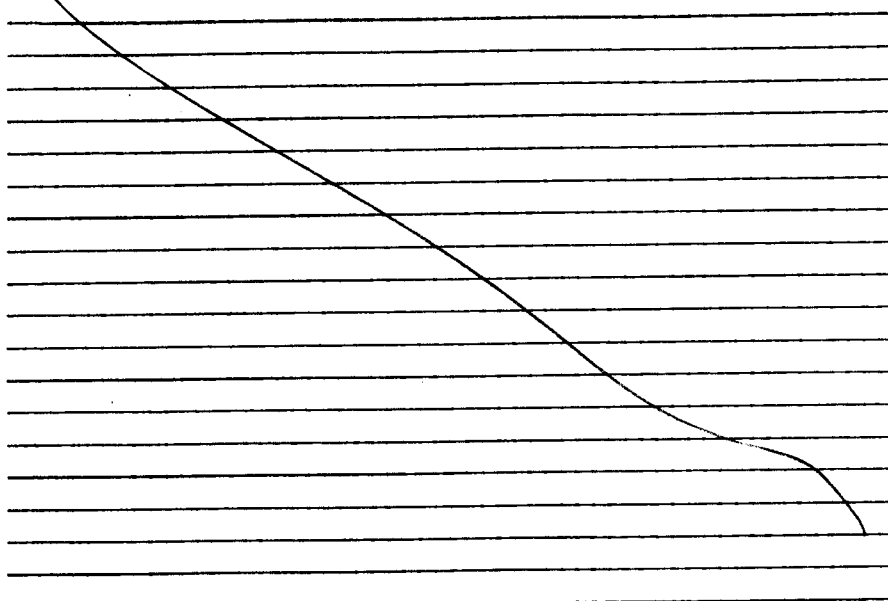

New Accessories

① 7" FIR SCRIBED "1/4 S 28 CS BT" IN DOUBLE BLAZE, BEARS
 N50°W 26.3 FT.

② 10" FIR SCRIBED "1/4 S 33 CS BT" IN DOUBLE BLAZE, BEARS
 S77°E 10.4 FT.

Sketch of Monument, Accessories, and General Area

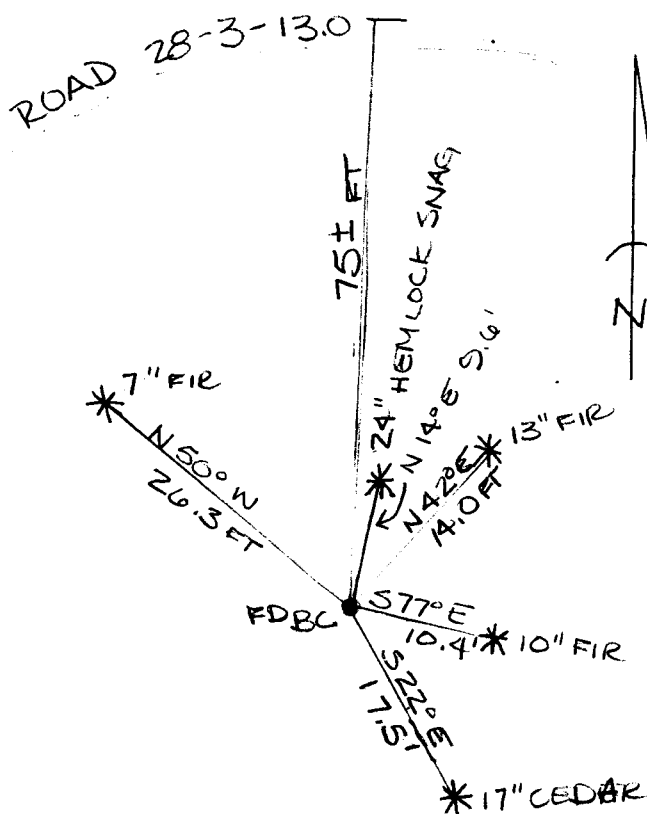

Location & Comments

Comp. Declin. 19° EAST
 Agency DCSO
 Party Chief GREGORY E. QUIRKE
 Notekeeper JONAS L. BULEY
 Witnesses TERESA L. BULEY

Surveyor's Seal