

DATE: SEPT. 30, 1981

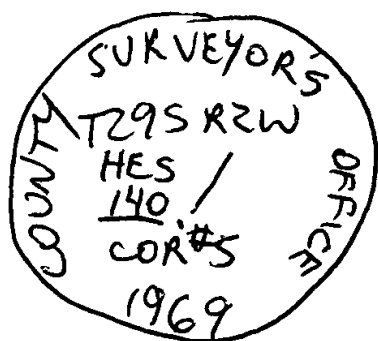

Condition Report Only  
 Not Found  
 Renewed  
 Unrecorded  
 Surveyed In  
 Referenced Out

Previous Renewal #'s 61

Monument(s) Found: (Condition and Source) \_\_\_\_\_

1/4" I.P. ~~FIR~~ FIRMLY SET, PROJECTING 8" ABOVE GROUND, WITH BRASS CAP MARKED AS ABOVE; SET BY JOHN POWELL, DOUGLAS COUNTY SURVEYOR'S OFFICE, IN 1969. ORIGINAL STONE IS ALONGSIDE WITH MARKS "+" ON NORTH SIDE AND "5 HES 140" ON TOP.

Accessories Found: (Condition and Source) ORIGINAL, BTS:

A 21" D. FIR, S82°W, 15<sup>8</sup> FT. WITH HEALED BLAZE, AND RESCRIBED BY POWELL IN 1969, WITH HEALED BLAZE.

A 24" D. FIR, N41°W, 71<sup>6</sup> FT. WITH HEALED BLAZE. AND BT MARKED BY POWELL IN 1969:

A 14" D. FIR, N38°W, 8° FT, WITH HEALED BLAZE.

RENEWAL

Monument Set: (Procedure and Description) \_\_\_\_\_

New Accessories: (Description) \_\_\_\_\_

Location and Comments: \_\_\_\_\_ Compass Declination

U.S. F.S. Agency  
LEONARD HERTZSTEIN Party Chief  
Notekeeper

JIM LANDRUM Witnesses

JERRY PIERCE.

OK  
JEP