

T 22 S R 12 W

W.C. TO

1/4 S1
S12

DATE: 7-29-81

Condition Report Only
Not Found
 Renewed
Unrecorded
Surveyed In
Referenced Out

WITNESS CORNER

Previous Renewal #'s 82

Monument(s) Found: (Condition and Source) ORIGINAL CORNER POST NOT

FOUND FROM RENEWAL #82 FOUND A 1" IRON PIPE WITH ATTACHED BRASS
" COUNTY SURVEYORS OFFICE "
T 22 S R 12 W
CAP STAMPED W.C. TO THIS MONUMENT SET IN CONCRETE.
1/4 S1
S12
1971

A REVIEW OF THE SURVEY NOTES FILED IN THE COUNTY SURVEYORS OFFICE
SHOWS THIS CORNER MONUMENT NOT SET ON SECTION LINE.

Accessories Found: (Condition and Source) QUARTER CORNER
ORIGINAL BT'S NOT FOUND

BT'S FROM RENEWAL #82. 1) A P. CEDAR 5 NOW 1 1/2 INCH DIAMETER
WITH WELL HEALED BLAZE BEARS S 18 1/2° W (REC. S 20° W) 141 2 FEET.

2) A 1" I. BOLT AT S.W. CORNER OF BRIDGE BEARS N 31 1/2° E 38 2 FEET.
(REC. N 33° E 38 45 FEET).

3) A 1" I BOLT AT S.E. CORNER OF BRIDGE BEARS N 57 1/2° E 44 5 FT
(REC. N 59° E 44 74 FT.).

153 ✓

C.S. File No. 61/27-27 Page 1 of 3
C

4) A DRILL STEEL 1" DIA. BEARS N 87 1/2° E 32 10 FT. (REG. 589-04
 N 88° 47' E
 32 16 FT.)

RENEWAL

Monument Set: (Procedure and Description) AT TRUE POSITION OF
WITNESS CORNER AS DETERMINED BY SURVEY (SEE DOUGLAS Co. SURVEYORS

FILES CS 5/5 M42-27) WE SET A 1" X 30" IRON PIPE WITH ATTACHED
" DOUGLAS COUNTY SURVEYOR "
T 22 S R 12 W
BRASS CAP STAMPED W C TO
1/4 S1
S12

FROM WHICH THE 1/4 CORNER S1 1981
S12 BEARS S 88° 47' W 170.57 FT PER SURVEY M42-27
 New Accessories: (Description)

WE LEAVE THE 1971 BRASS CAP MONUMENT SET ~~WITNESS~~ FIRMLY
" DOUGLAS COUNTY SURVEYOR "
SEE AND RESTAMP, IT IS MARKED
SC 7
RESTAMP
1981
1971

THIS MONUMENT BEARS N 27 1/2° E OF THE WITNESS CORNER.
(30.09 FT)

Location and Comments: 19° EAST Compass Declination
DOUG Co. SURV. OFF. Agency
LARRY E. MONBEAN Party Chief
Larry E. Monbean Notekeeper
T.R. FLOUR Witnesses
T.R. Flour

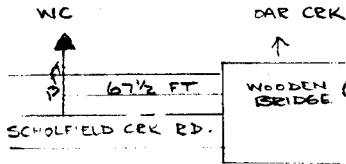

CONTINUED
T 22 S R 12 W
W.C. TO
 $\frac{1}{4}$ $\frac{S1}{S12}$

DATE: 7-29-81

- Condition Report Only
- Not Found
- Renewed
- Unrecorded
- Surveyed In
- Referenced Out

~~Previous Renewal #'s~~ _____

~~Monument(s) Found: (Condition and Source)~~ ACCESSORIES

~~(FROM RENEWAL # 82 - BEARINGS AND DISTANCES FROM 1981 MONUMENT)~~

1) 1" DRILL STEEL BEARS N 60° E 53² FEET

2) A 13" DIA. R. CEDAR WITH HEALED BLAZE BEARS S 17° W 111⁸ FT.

Accessories Found: (Condition and Source) _____

RENEWAL

Monument Set: (Procedure and Description) _____

New Accessories: (Description) _____

| | | |
|------------------------|-------|---------------------|
| Location and Comments: | _____ | Compass Declination |
| | _____ | Agency |
| | _____ | Party Chief |
| | _____ | Notekeeper |
| | _____ | Witnesses |
| | _____ | |
| | _____ | |

T 22 S R 12 W

7-29-81

W.C. TO

LEM TRP

$\frac{1}{4}$ $\frac{S1}{S12}$

SKETCH TO SHOW COMPASS BEARING
ROTATION TO MATCH SURVEY BEARINGS

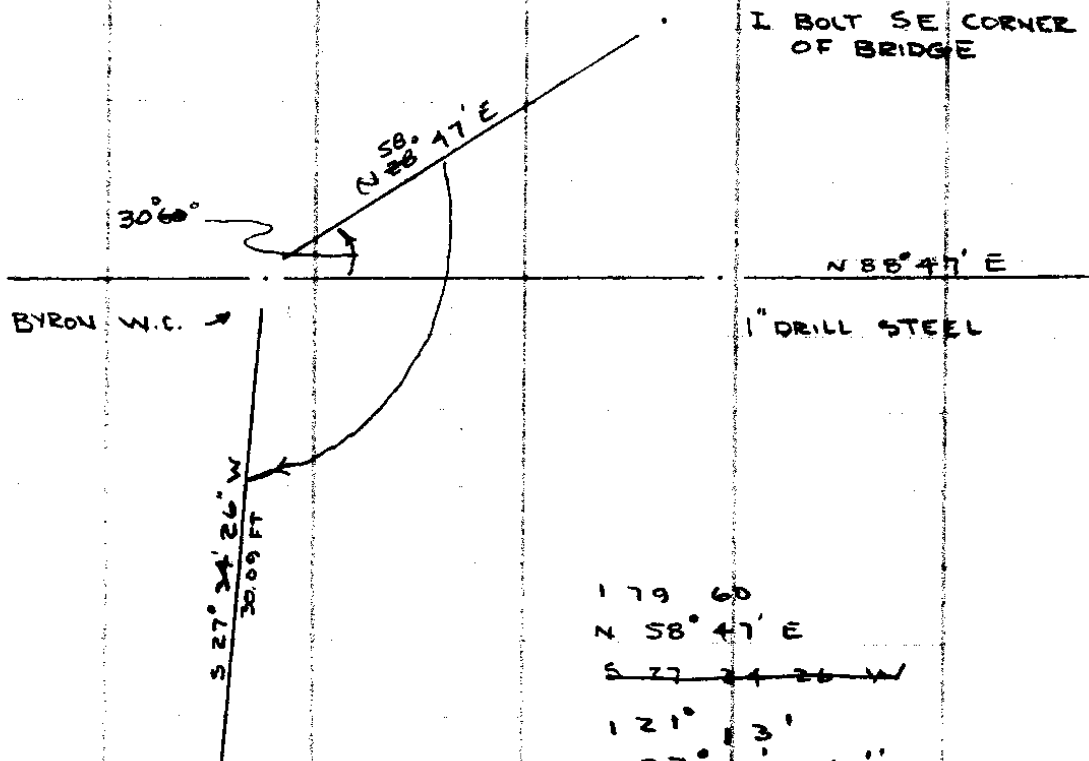

TRUE POSITION
OF W.C.

179 60
 N 58° 47' E
 S 77 24 26 W
 121° 3'
 27° 34' 26"

148° 47' 26" RT

~~N 57 1/2° E~~

N 57° 30' E COMPASS TO I. BOLT

148° 47' 26" RT

206 17 26

S 26° 17' 26" W COMPASS TO
W.C.