

T325 R5W

1/4 S15
S22

DATE: April 22, 1980

- Condition Report Only
- Not Found
- Renewed
- Unrecorded
- Surveyed In
- Referenced Out

Previous Renewal #'s 184

Monument(s) Found: (Condition and Source) 1 1/2" iron pipe

protruding 0[±] ft from ground and firmly set. Originally set by proportionate measurement, see renewal #184.

Accessories Found: (Condition and Source) Searched for original

bearing trees thoroughly, none found. From Carlile survey

DCSO map file M48-71 a 5/8" iron rod firmly set and

flush with surface of ground bears S 89 1/2° E, 703[±] ft

(record S 88° 11' 14" E, 706[±] ft) from this iron rod

another 5/8" iron rod firmly set and flush with ground

from Riley survey CS. 55/189 bears S 37° W, 2⁵ ft

REC. DIST AS PER M 48-71 300.00 FT FROM CARAXLE
 TO ~~AND~~ $\frac{1}{4}$ S15/S22¹ S88°11'14"E.
 WE FIND THE DIST. TO BE
 278.29 FT. (SEE ATTACHMENTS)

RENEWAL

Monument Set: (Procedure and Description)

New Accessories: (Description) A 7" Ash bears N85½°E, 37⁹ ft
 scribed "¼ S15 CS BT" on a double blaze. An 8" Ash (most
 westerly of trunk of tripple trunk tree) bears S 72½°E, 11° ft.
 (bearing and dist. to center of root crown of tripple trunk)
 scribed "¼ S22 CS BT" on a double blaze. A 10" Ash (most east-
 erly trunk of tripple trunk tree) bears S 73°W, 36³ ft. (bearing and
 distance taken to center of root crown of tripple trunk) scribed

Location and Comments:

"¼ S22 CS BT" on
 a double blaze,
 A 12" Ash bears N29°W
 49½ ft. scribed "¼ S
 15 CS BT" on a double
 blaze. We tag all trees with DC50 BT tags.

19°E
DC50
Deputy Stephen J. Flouse
Stephen John Flouse
TERRIE PLOWFF
SAAWN MEANS

Compass Declination
 Agency
 Party Chief 363 573W
 Notekeeper
 Witnesses 49 4/8 N29W

OK *[Signature]*

DIETZGEN NO. 385-6

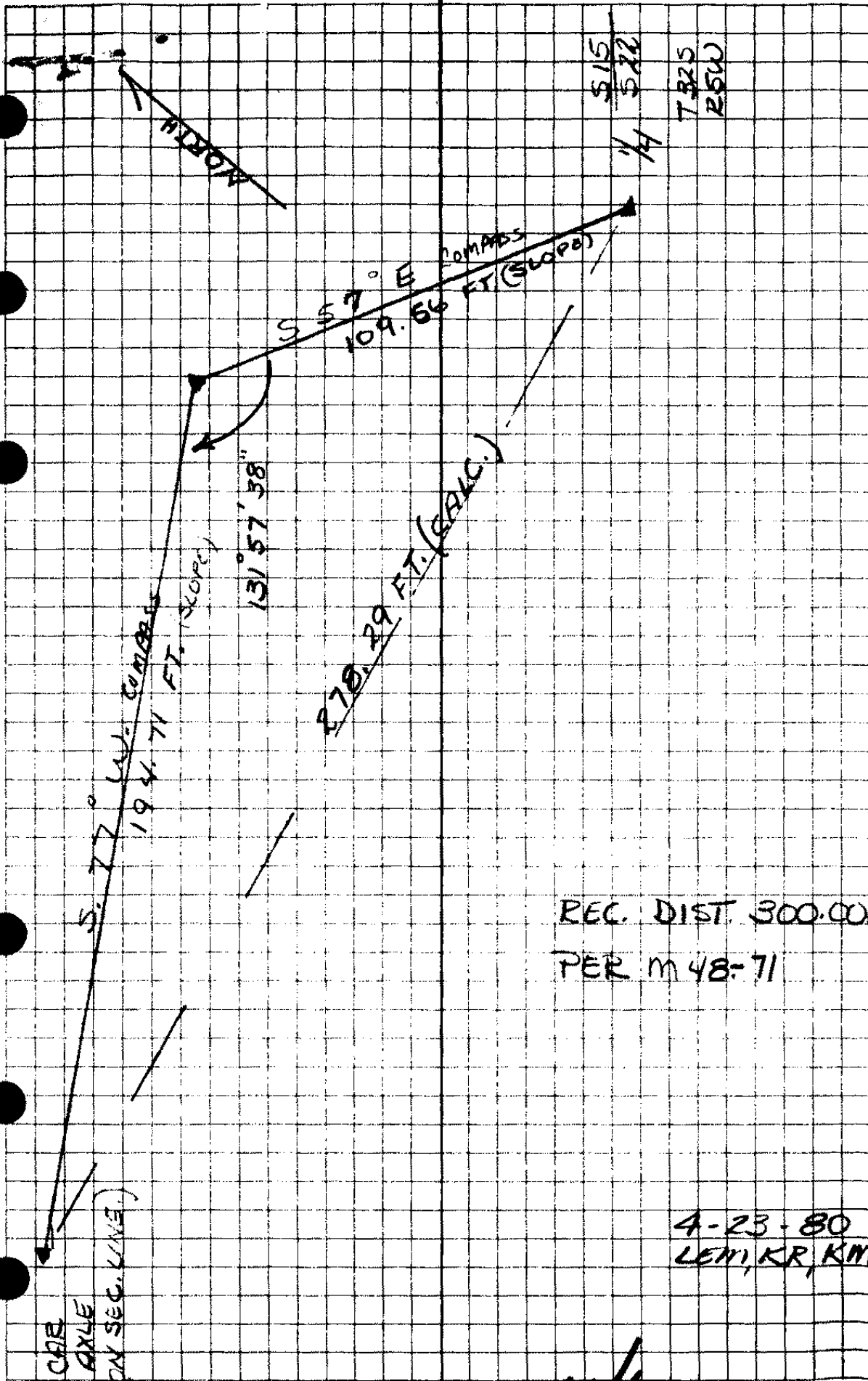

REC. DIST. 300.00 FT
PER M 48-71

4-23-80
LEM, KR, KM

C. S. File No. 6116-33

COMP.

1/4

100°

51

41

90

COE

10

54

41

UA

X

109.56

=

107.58

AXLE

89

57

60

89

09

16

COE

1

50

44

UA

X

174.71

=

194.61

1/5 STA "PT A" KM 270878 4-23-80

D 0 00 30.0

1/4 515
522 R 180 00 22.3

52.3 26.2

D 131 58 04.2

CAR AXLE R 311 58 04.2

(ON LANE) 08.4 04.2

MEAN = 131° 57' 38.0"

ZEN: D 100 54 44 MEAN:

R 259 05 22

1/4 COR 360 00 06 100° 54' 41"

D 88 09 11

R 271 50 39

AR AXLE 359 59 50 88° 09' 16"

DIST. FT M PC 2

1/4 109.56 33.399 PPM 0

CAR AXLE 194.71 59.352