

DATE: 12-6-79

Condition Report Only  
 Not Found  
 Renewed  
 Unrecorded  
 Surveyed In  
 Referenced Out

Previous Renewal #'s 19 & M 56-26, CS 59/30

Monument(s) Found: (Condition and Source) ORIGINAL CORNER  
STONE, WITH ILLEGIBLE MARKS VISIBLE, AND  
BRASS CAPPED IRON PIPE, # SET IN 1969  
BY COUNTY SURVEYOR, WERE FOUND LYING  
ALONGSIDE THE R.M. I SET IN  
JULY 1978. THE BRASS CAP IS STAMPED  
AS SHOWN ABOVE.

Accessories Found: (Condition and Source) 26"  
16" CEDAR BT  
SET IN 1959 (WITH SCRIBING "S 143 CS BT"  
VISIBLE) BEARS N70°E, 52 4/5' 5/8" IRON  
ROD WITH A 1 1/2" ALUM. CAP (MARKED <sup>R.M.</sup> 18)  
IS SET ON LINE 13-14 & IS 80.00  
FT. FROM COR # 14. THIS R.M. IS  
WITNESSED WITH A BOAT SPIKE SET IN THE

# 165 ✓

Page 1 of 1

G.S. File No. 6034-24 C

BASE OF A 5" FIR WHICH BEARS  $S 85^{\circ} W, 30.5$  FT.  
THE ORIGINAL FIR STUMP B.T., WHICH  
WAS FOUND ( $N 40^{\circ} E, 25$  FT) BY LANGLITZ  
ON 3-19-79, WAS DESTROYED DURING  
ROAD CONSTRUCTION.

RENEWAL

Monument Set: (Procedure and Description) I OCCUPIED THE  
R.M. & BACKSIGHTED COR #13, REVERSED MY  
STAFF COMPASS BEARING  $180^{\circ}$  & CHAINED TO A  
POINT (ON THE LEFT SHOULDER OF THE NEW  
ROAD) 80.00 FT,  $N 19^{\circ} E$ . I THEN OCCUPIED  
THE CORNER POINT (COR #14) AND VERIFIED BY  
TAKING THE COURSE & DISTANCE TO THE CEDAR B.T.  
~~Notes: Accessories. (Description)~~

I BURIED THE CORNER STONE & IRON  
PIPE AT THIS POINT. TOP OF BRASS CAP IS  
6" UNDER THE ROAD SURFACE.

NEW ACCESSORY: A 12" WHITE FIR BEARS  
 $N 23^{\circ} W, 90.3$  FT, SCRIBED "#14 HES 143CS BT"  
ON ~~#14~~ <sup>DOUBLE</sup> BLAZES.

|                        |                          |                     |
|------------------------|--------------------------|---------------------|
| Location and Comments: | <u>18° 30' E</u>         | Compass Declination |
|                        | <u>U.S. F.S.</u>         | Agency              |
|                        | <u>DENNIS GAYLORD</u>    | Party Chief         |
|                        | " "                      | Notekeeper          |
|                        | <u>LEONARD HERZSTEIN</u> | Witnesses           |
|                        | _____                    |                     |
|                        | _____                    |                     |

OK  
*[Signature]*

93.1 @ 25%

T295 R1E

HES 143

COR. # 14

Now Renew #  
CS 6034  
1/65

DATE: 3-19-79

- Condition Report Only
- Not Found
- Renewed
- Unrecorded
- Surveyed In
- Referenced Out

Previous Renewal #'s #19, M56-26, CS 59/30

Monument(s) Found: (Condition and Source) REMAINS OF THE ORIGINAL CORNER STONE WITH ILLEGIBLE MARKINGS VISIBLE ON THE STONE AND NEARBY FRAGMENTS, AND A 1" IRON PIPE WITH BRASS CAP ATTACHED, SET BY ~~THE~~ THE DOUGLAS COUNTY SURVEYOR IN 1969 AND MARKED AS DESCRIBED IN RENEWAL # 19.

Accessories Found: (Condition and Source) THE ONLY REMAINING ORIGINAL BEARING TREE, AN ORIG. 14" D. FIR, NOW A 16" STUMP WITH SCRIBING "143 BT" VISIBLE BEARS N 40° E 25<sup>1</sup> FT. (REC. N 39° 55' E 25<sup>1</sup> FT.).

THE ORIGINAL SW BEARING TREE HAS BEEN REMOVED BY PRELIMINARY ROAD CONSTRUCTION. FROM REN. # 19, AN 18" NOW 20" I. CEDAR WITH

SCRIBING "S 143 CSBT" VISIBLE ON A PARTIALLY-HEALED  
SINGLE BLAZE BEARS N 70° E 52 1/2 FT. (REG. N 70° E 54 1/2 FT.)

THIS CORNER AND IT'S PREVIOUSLY DESCRIBED ACCESSORIES WILL  
BE DESTROYED BY ROAD CONSTRUCTION. WE REFERENCE  
IT'S PRESENT LOCATION AS FOLLOWS:

RENEWAL

~~Monument Set: (Procedure and Description)~~ WE FIND A 3/8" IRON ROD  
WITH ALUMINUM CAP, MARKED R/M SET 80°° FT FROM COR. #14  
ON LINE BETWEEN CORNERS # 13 AND 14. (THIS R/M SET BY GAYLORD,  
USFS IN CS 59/30). WE SET A BEARING OBJECT FOR THIS  
R/M AS FOLLOWS:

~~New Accessories: (Description)~~ A BOAT SPIKE, MARKED "BO 1"  
SET IN THE BASE OF A 5" D. FIRE<sup>13</sup> LOCATED AS SHOWN ON

FOLLOWING DIAGRAM:

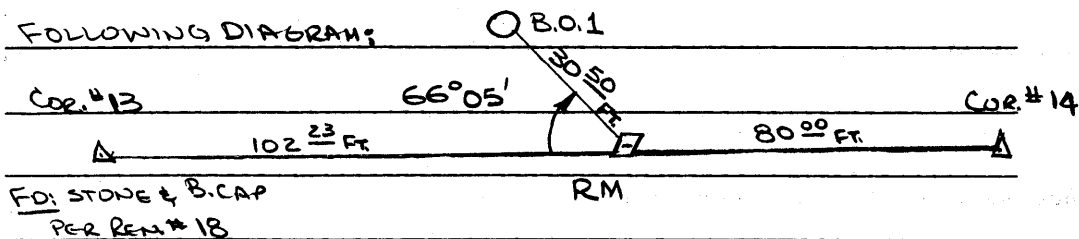

FD: STONE & B. CAP  
PER REM # 18

Location and Comments: 19° EAST Compass Declination

DOUGLAS CO. SURVEYORS Agency  
GARY L. LANGLITZ Party Chief  
Gary J. Langlitz Notekeeper  
FRANK C. SILAGY Witnesses

OK  
*[Signature]*

COUNTY SURVEYOR'S OFFICE  
T295  
COR # 14  
H.E.S. 143

DATE: 7-18-78

Condition Report Only  
 Not Found  
 Renewed  
 Unrecorded  
 Surveyed In  
 Referenced Out

Previous Renewal #'s RIE  
1969 #19

Monument(s) Found: (Condition and Source) 2 1/2" BRASS  
CAP ON 1" IRON PIPE SET SOLIDLY  
IN GROUND. BRASS CAP STAMPED AS  
SHOWN ABOVE.

Accessories Found: (Condition and Source) A 18" CEDAR  
BEARS N 70°E, 54.2' SCRIBING VISIBLE  
ON NEARLY HEALED BLAZE.

RENEWAL

Monument Set: (Procedure and Description) NONE

New Accessories: (Description) I BACKSIGHT COR

# 13 AND SET A 5/8" X 36" █

IRON ROD WITH A 1 1/2" ALUMINUM CAP

ON LINE BETWEEN CORNERS # 13

AND # 14, 80.00' FROM CORNER

# ~~13~~ 14. CAP IS MARKED:

(THE R.M. IS 102.23' FROM COR # 13)

Location and Comments:

RECORD BEARING

FROM CORNER # 14 TO

CORNER # 13 IS S 19°

00' 08" W PER

M-56-26

18 1/2° E

U.S.F.S.

DENNIS GAYLORD

" "

JIM SIMLNESS



Compass Declination

Agency

Party Chief

Notekeeper

Witnesses

ROAD CONSTRUCTION WILL TAKE CORNER OUT.  
(1 OR 2 YRS)