

DATE: 7-18-78

- Condition Report Only
- Not Found
- Renewed
- Unrecorded
- Surveyed In
- Referenced Out

SURVEYOR'S OFFICE
 T295
 COR # 14
 H.E.S. 143
 RIE
 1969 #19

Previous Renewal #s _____

Monument(s) Found: (Condition and Source) 2 1/2" BRASS

CAP ON 1" IRON PIPE SET SOLIDLY
IN GROUND. BRASS CAP STAMPED AS
SHOWN ABOVE.

Accessories Found: (Condition and Source) A 18" CEDAR

BEARS N 70°E, 54.2' SCRIBING VISIBLE
ON NEARLY HEALED BLAZE.

C.S. FILE NO. 59/30

DONÉ.
DEC.

1979

#165

RENEWAL

Monument Set: (Procedure and Description) NONE

New Accessories: (Description) I BACKSIGHT COR

13 AND SET A 5/8" X 36" █

IRON ROD WITH A 1 1/2" ALUMINUM CAP

ON LINE BETWEEN CORNERS # 13

AND # 14, 80.00' FROM CORNER

█ 14. CAP IS MARKED:

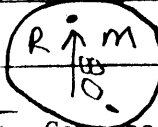

(THE R.M. IS 102.23' FROM COR #13)

Location and Comments:

18 1/2° E

Compass Declination

U.S.F.S.

Agency

RECORD BEARING

DENNIS GAYLORD

Party Chief

FROM CORNER # 14 TO

" "

Notekeeper

CORNER # 13 IS S 19°

JIM SIMLENESS

Witnesses

00' 08" W PER

M-56-26

ROAD CONSTRUCTION WILL TAKE CORNER OUT.
(OR 2 YRS)

T295 R1E

DATE: 3-19-79

HES 143

COR. # 14

Condition Report Only
 Not Found
 Renewed
 Unrecorded
 Surveyed In
 Referenced Out

Previous Renewal #'s #19, M56-26, CS 59/30

Monument(s) Found: (Condition and Source) REMAINS OF THE ORIGINAL
CORNER STONE WITH ILLEGIBLE MARKINGS VISIBLE ON THE
STONE AND NEARBY FRAGMENTS, AND A 1" IRON PIPE
WITH BRASS CAP ATTACHED, SET BY ~~BE~~ THE DOUGLAS COUNTY
SURVEYOR IN 1969 AND MARKED AS DESCRIBED IN RENEWAL
19.

Accessories Found: (Condition and Source) THE ONLY REMAINING
ORIGINAL BEARING TREE, AN ORIG. 14" D. FIR, NOW A
16" STUMP WITH SCRIBING "143 BT" VISIBLE BEARS
N 40° E 25¹ FT. (REC. N 39° 55' E 25² FT.).

THE ORIGINAL SW BEARING TREE HAS BEEN
 REMOVED BY PRELIMINARY ROAD CONSTRUCTION,
 FROM REN. # 19, AN 18" NOW 20" I. CEDAR WITH

Page 1 of 1

C.S. File No. 59/30

SCRIBING "S 143 CSBT" VISIBLE ON A PARTIALLY-HEALED
SINGLE BLAZE BEARS N 70° E 52 ⁴/₄ FT. (REG. N 70° E 54 ²/₄ FT.)

THIS CORNER AND IT'S PREVIOUSLY DESCRIBED ACCESSORIES WILL
BE DESTROYED BY ROAD CONSTRUCTION. WE REFERENCE
IT'S PRESENT LOCATION AS FOLLOWS:

RENEWAL

Monument Set: ~~(Procedure and Description)~~ WE FIND A ⁵/₈" IRON ROD
WITH ALUMINUM CAP, MARKED R/M SET 80°° FT. FROM COR. #14
ON LINE BETWEEN CORNERS # 13 AND 14. (THIS R/M SET BY GAYLORD,
USFS IN CS 59/30). WE SET AN BEARING OBJECT FOR THIS
R/M AS FOLLOWS:

New Accessories: ~~(Description)~~ A BOAT SPIKE, MARKED "BO 1"
SET IN THE BASE OF A 5" D. FIRE ¹³ LOCATED AS SHOWN ON

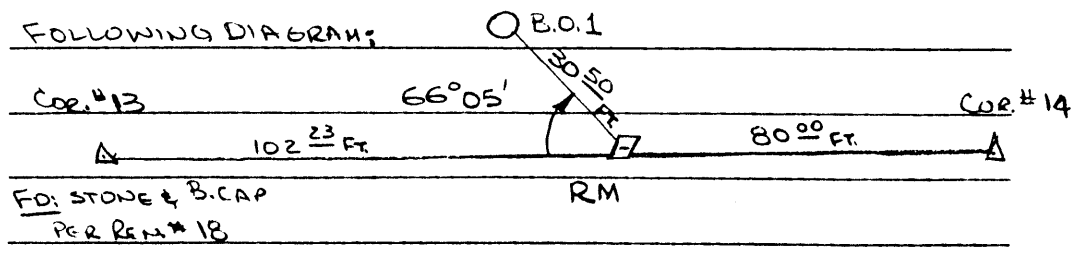

Location and Comments: 19° EAST Compass Declination
DOUGLAS Co. SUEVEROES Agency
GARY L. LANGLITZ Party Chief
Gary L. Langlitz Notekeeper
FRANK C. SILAGY Witnesses

OK *[Signature]*