

RENEWAL

11-4-76

VT 29 S R 3 W

S22	S23
S27	S26

SEE RENEWAL

3 AND # 60

FOUND

1. $\frac{3}{4}$ INCH DIAMETER IRON PIPE AT SECTION CORNER, PIPE LOOSE AND BADLY BENT.
2. ORIGINAL MAPLE, IS NOW 25 INCH DIAM. BEARS N 45° E, $6\frac{1}{2}$ FEET. TREE HAS OLD BLAZE.
3. ORIGINAL MAPLE 22 INCH DIAM BEARING S 35° W, $3\frac{1}{2}$ FEET IS DOWN AND ROTTED.
4. A CEDAR 12 NOW 20 INCH DIAM. BEARS S 63° E, $10\frac{1}{2}$ FEET (REC S 64 E). TREE HAS PARTIALLY HEALED BLAZE, IT OPEN AND FIND SCRIBING "CS BT".

#122 ✓

C.S. File No. 59/26-9 C

• ALL OTHER BEARING TREES ARE GONE.

RENEWAL

1. AS IRON PIPE IS BADLY BENT I
REPLACE MARKER WITH A 1" X 30" IRON
PIPE WITH BRASS CAP ATTACHED
AT SECTION CORNER. CAP IS
STAMPED

" DOUGLAS CO. SURVEYOR "

T 295 R 3W

S 22 / S 23
S 27 / S 26

1976

2. A D. FIR 10 INCH DIAM. BEARS
S 43° W, 62° FEET. TREE
IS DOUBLE BLADED AND SCRIBED
" T 295 R 3W S 27 C S B T "

NO TREES AVAILABLE FOR SCRIBING
IN N.W. QUADRANT

MAG. DEC. 20° E

11-4-76

L.E. MONREAU

K. CHENY

C.S. File No. ~~59/26~~
OK 

Section 23

Twp 295 Rge 3 W

Date: 8-3-76

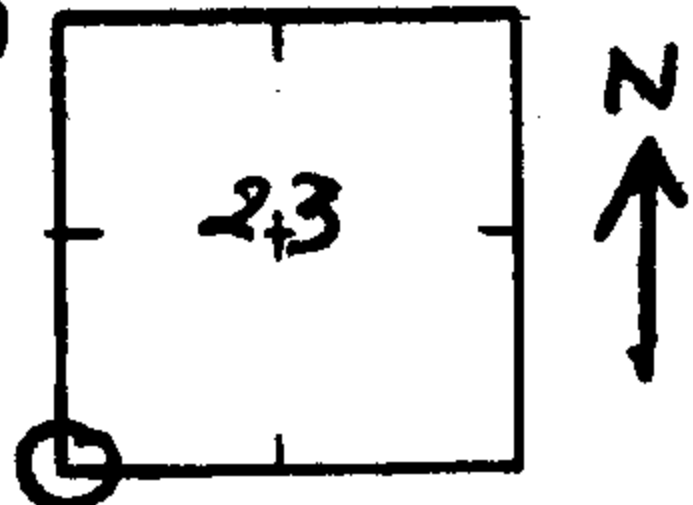

How was corner identified? 1" IRON PIPE

Condition of corner: BAD The IP is bent and the 23" DBH maple in the SW quad is on the ground now

Best route to reach corner: Go up Days Creek Rd until you cross the west section line of section 23 (location poster at road) The corner is on the south bank of the creek about 350' south of the road.

Quadrant	NE <u>23</u>	NW	SE	<u>SW</u>
Species & Size	<u>See #60</u>		<u>See #60</u>	<u>THIS</u>
Dist. & Bearing		<u>N</u>	<u>in county</u>	<u>ORIG.</u>
Condition of Scribe	<u>County records</u>	<u>0</u>	<u>records</u>	<u>BT is</u>
Original or Resurvey		<u>Ne</u>		<u>Now</u>
Appearance of B.T.				<u>down</u>
Flags, Marks, etc.				<u>///</u>

Other Remarks:
Please RENEW CORNER with BRASS CAP AND NEW BT in SW quad.

W. M. May (Bill May)
 Signed
 Forester BLM Bozeman

File No. 5926