

10-19-76

$\frac{522}{27} \frac{1}{4}$ T315 RBW

FOUND:

THE ORIGINAL NW BEARING TREE, AN ORIGINAL 12" NOW 22" D. FIR, ALIVE AND IN GOOD CONDITION, WITH SCRIBING $\frac{1}{4}$ " VISIBLE ON PREVIOUSLY OPENED BLAZE.

THE ORIGINAL CORNER MONUMENT, A CHINQUAPIN POST AND THE SW BEARING TREE ARE GONE.

AT THE CORNER POINT AS DETERMINED BY THE RECORDED MEASUREMENTS FROM THE FOUND ORIGINAL BT, AN ORIG. 12" NOW 22" D. FIR AS DESCRIBED ABOVE, BEARING N 45° W. 25 $\frac{3}{4}$ FT.,

WE SET A 1" X 30" I. PIPE, " IN THE GROUND WITH BRASS CAP ATTACHED, MARKED:

DOUGLAS CO. SURVEYOR

T315 RBW

$\frac{522}{27} \frac{1}{4}$
1976

38
59/29
C.S. FILE NO.

PAGE 1 C

#72
#~~116~~ ✓

DIETZGEN NO. 385-6

25° @ 13 1/2°

9723

24³ 414

0.61
4 | 2.77
24
—
37

NEW BT

52³ @ 29° .8746 = 45³

22" D. Fir

59° E

4527 CS BT

1254

1000

²
8746

1.25

66

52.3

52

26238

250

17492

25

43730

5.500

45.7 4158

52.3

458

RP

4 ¹³⁵

NAIL

3 ⁵⁰

PBOB

WE MARK A NEW BT AS FOLLOWS:

A 22" D. FIR BEARS S 9° E 45² FT.,
SCRIBED "1/4 S 27 CS BT" ON A
DOUBLE BLAZE.

COMPASS DECLINATION SETTING: 20° EAST

10-19-76

Gary J. Knight

PETER LEARLE

KAREN CHENEY

OK
[Signature]

DIETZGEN NO. 3655-6

Section 22

31S

MP-
Ege

ROSEBURG

Date: _____

How was corner identified?

old rotten laurel stump

+ 18" D. Fir (chopped out scribe)

Condition of corner:

Fair

Best route to reach corner:

Call 679-5997 Floyd White
after 5:00 P.M.

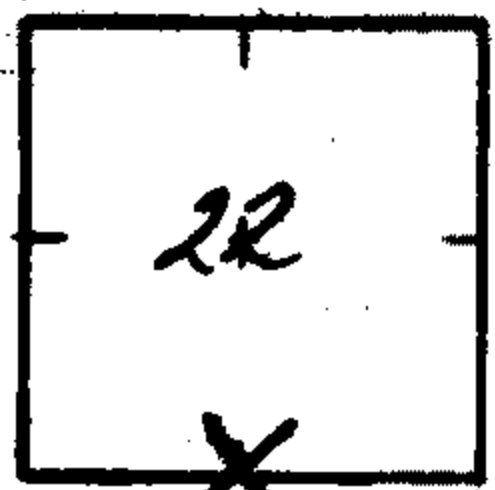

3133

C.S. File No. 59/29

Quadrant	NE	NW	SE	SW
Species & Size		18" D. Fir		Laurel
Dist. & Bearing		N45°W		S4°W
Condition of Scribe		Good		N/A
Original or Resurvey		Orig		Orig
Appearance of B.T.		Good		N/A
Tags, Marks, etc.		Red Ribbon		Red Ribbon

Other Remarks:

Floyd E. White
Signed
Roseburg Lumber