

M 97-48

FILED
RECEIVED

OREGON CORNER RESTORATION FORM

Section 32 Township 21S Range 5W

11/23 1984

County Douglas Date 11/2/1984

COUNTY SURVEYOR
DOUGLAS COUNTY, ORE.

Corner Designation

N $\frac{1}{4}$

- Condition Report Only
- Not Found
- Renewed
- Unrecorded
- Surveyed In
- Referenced Out

Previous Renewals/Surveys, etc. U.S. BLM survey 1981

Monument(s) & Accessories Found: (Condition and Source)

13" Fir S 8 E 30 lks (1981 USBLM) bears S 8 W 30 lks tag reads N 8 E 30 lks

11" Fir N 1 $\frac{1}{2}$ E 35 lks (1981 USBLM) bears N 1 $\frac{1}{2}$ E 35 lks tag reads S 1 $\frac{1}{2}$ W 30 lks

2 $\frac{1}{2}$ " Aluminum BLM Cap

1" Iron Pipe of unknown origin bears N 41° 37' E 0.383 chains with associated BTs 26" Cedar N 8 $\frac{1}{2}$ W 24 lks 26" Fir S 30 W 14 $\frac{1}{2}$ lks

Monument Detail

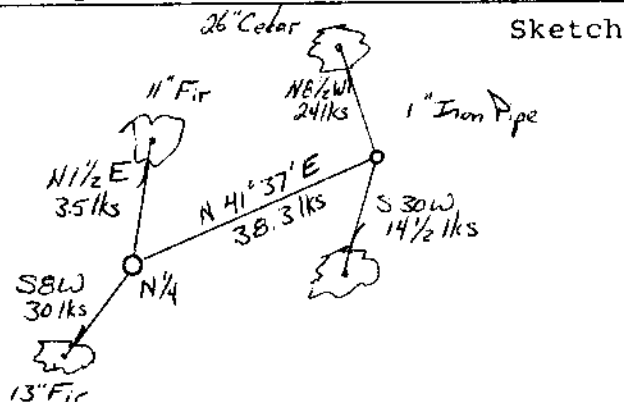

Monument Set (Procedures and Description)

Monument set by US BLM at proportionate distance

New Accessories

Location & Comments

Corner lies near top of ridge

Compass Declination 20° E
Firm/Agency Weyerhaeuser Company

Surveyor's Seal

Address P. O. Box 275
Springfield, Oregon 97477

Party Chief D. Wellman

Notes _____

Witness K. Perkins

REGISTERED
PROFESSIONAL
LAND SURVEYOR

Frank O. Williams

OREGON
JULY 12, 1968
FRANK O. WILLIAMS
0875

163 X

C.S. File No. 58/300-1 C