

M 96-64 A&B

FILED
RECEIVED AS

OREGON CORNER RESTORATION FORM

JUN 6 1984

Section 33 Township 21S Range 11W

COUNTY SURVEYOR
DOUGLAS COUNTY, ORE.

County Douglas Date 4-17-84

Corner Designation

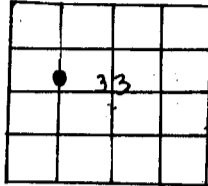

- Condition Report Only
- Not Found
- Renewed
- Unrecorded
- Surveyed In
- Referenced Out

Previous Renewals/Surveys, etc. _____

NONE

Monument(s) & Accessories Found: (Condition and Source)

NONE

Monument Detail

Set 2" alum. cap on 12" x 1/2" iron rod 9" in sandstone.

Sketch

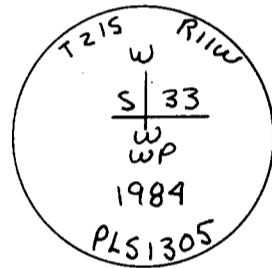

Monument Set (Procedures and Description)

Set by survey and subdivision of Section 33, on North bank of Umpqua River.

New Accessories

13" D. Fir bears N 16° W 8.8 ft., scribed X BT

6" R. Cedar bears N 47° E 21.3 ft., scribed X BT

Location & Comments

Set from survey for U.S. Forest Service Compass Declination 19°50'E

Firm/Agency Jackson & Prochnau, Inc.

Address P.O. Box 177
Albany, Ore. 97321

Party Chief K. Kendall

Notes _____

Witness Larry Griensewic

Surveyor's Seal

REGISTERED
PROFESSIONAL
LAND SURVEYOR

James W. Prochnau

OREGON
SEPTEMBER 21, 1977
JAMES W. PROCHNAU
1305