

M 96-62

FILED
RECEIVED *AS*

OREGON CORNER RESTORATION FORM

JUN 5 1984

Section 26 Township 21S Range 11W

COUNTY SURVEYOR
DOUGLAS COUNTY, ORE.

County Douglas Date 4-13-84

Corner Designation

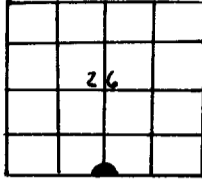

- Condition Report Only
- Not Found
- Renewed
- Unrecorded
- Surveyed In
- Referenced Out

Previous Renewals/Surveys, etc. _____

Original GLO 1891, Thiel

Monument(s) & Accessories Found: (Condition and Source)

NONE

Monument Detail

Sketch

Set 3" alum. cap in 2 1/2" x 30" alum. pipe with flared base.

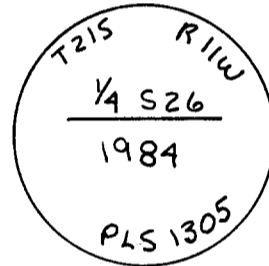

Monument Set (Procedures and Description)

Set by single proportion

New Accessories

26" D. Fir bears N 9° W, 55.8 ft., scribed 1/4 S26 BT

26" D. Fir bears N 60° W, 76.8 ft., scribed 1/4 S26 BT

Location & Comments

Surveyor's Seal

Set from survey for
U.S. Forest Service

Compass Declination 19°50'E

Firm/Agency _____

Jackson & Prochnau, Inc.

Address P.O. Box 177

Albany, Ore. 97321

Party Chief K. Kendall

Notes _____

Witness Larry Griensewic

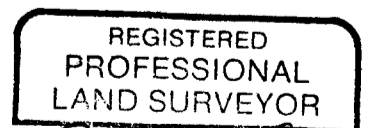

James W Prochnau

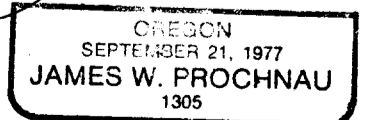

6 #176