

FILED
RECEIVED

APR 26 1984

OREGON CORNER RESTORATION FORM

Section 18 Township 19S Range 3W

County Douglas Date 04-11-84

COUNTY SURVEYOR
DOUGLAS COUNTY, ORE.

Corner Designation

N.E. 1/16 Corner
Section 18

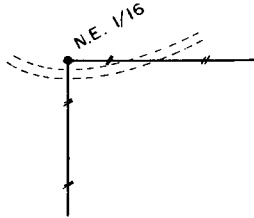

- Condition Report Only
- Not Found
- Renewed
- Unrecorded
- Surveyed In
- Referenced Out

Previous Renewals/Surveys, etc. See Survey M57-31 by Eugene District of Bureau of Land Management dated October 1974

Monument(s) & Accessories Found: (Condition and Source)

Found 3/4" Iron Rod set firmly in ground.

26" Cedar, S71 1/4°W, 47.4' (Scribe Vis.), 1974 B.T. Rec. S71 1/4°W, 47.4'

66" Fir, S33 1/4°E, 84.3' (Scribe Vis.), 1974 B.T. Rec. S33 1/4°E, 84.8'

Monument Detail

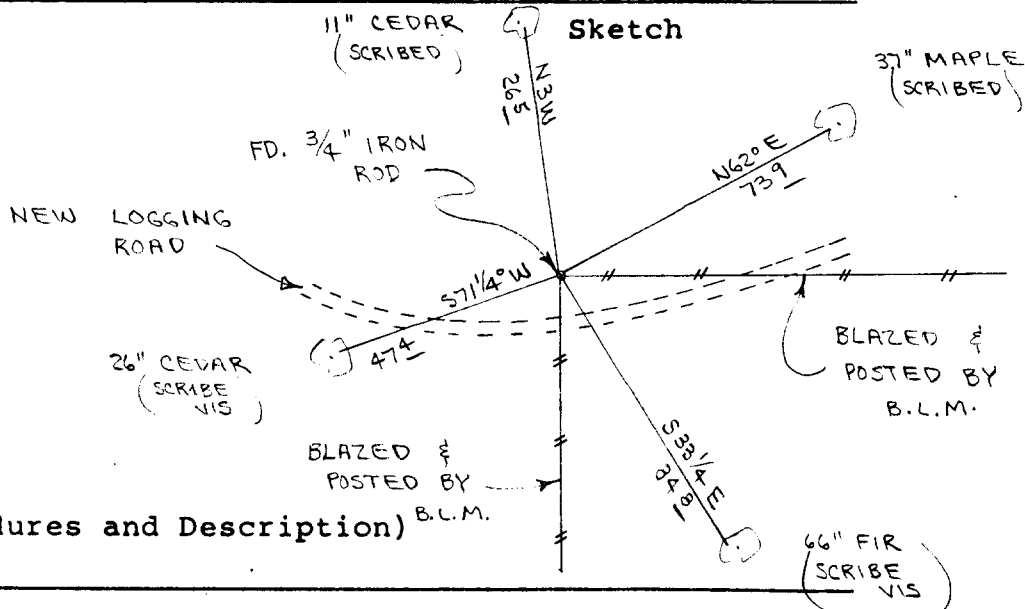

Monument Set (Procedures and Description)

New Accessories

11" Cedar, N03°W, 26.5' (Scribed/Painted/Brass Washer)

37" Maple, N62°E, 73.9' (Scribed/Painted/Brass Washer)

Set metal fence post beside iron rod. Wired land survey monument sign to metal fence post.

Location & Comments

New logging road is being built in area and S.W. Cedar B.T. will be destroyed.

Compass Declination 20 1/2

Firm/Agency Roberts Surveying Inc.

Address 29 West 29th St. Eugene, Oregon 97405

Party Chief Ted Baker

Notes Buzz Moisan

Witness _____

Surveyor's Seal

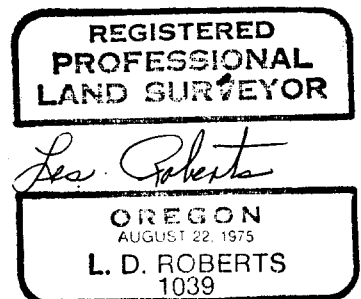

OK Ben C