

M 90-53

FILED  
RECEIVED *BS*

APR 11 1984

OREGON CORNER RESTORATION FORM

COUNTY SURVEYOR  
DOUGLAS COUNTY, ORE.

Section 34 Township 20S Range 9W

County Douglas Date 2-14-84

Corner Designation

South  $\frac{1}{4}$  Corner  
Section 34 Only 34

- Condition Report Only
- Not Found
- Renewed
- Unrecorded
- Surveyed In
- Referenced Out

Previous Renewals/Surveys, etc. Thomas A. Tillman and Joseph S. Gawron G.L.O. Survey in 1953-1954. Peterson's Cadastral Survey in 1966-1967.

Monument(s) & Accessories Found: (Condition and Source)

Found 1953 G.L.O. Brass Cap set loosely in the ground. I reset Brass Cap 12" deeper in the ground. I also buried purple magnetic marker under 36" pipe.

25" Fir Stump, N49E, 33.7' (Scar Vis.), 1953 BT. Rec. N49 $\frac{1}{4}$ E, 33.0' N.W. BT. set in 1953 has been destroyed by logging.

34" Cedar Stump, S46E, 76.6' (Scribe Vis.), Origin unknown.

N.E. Cedar BT. set by Theil in 1891 has been destroyed by logging.

Monument Detail

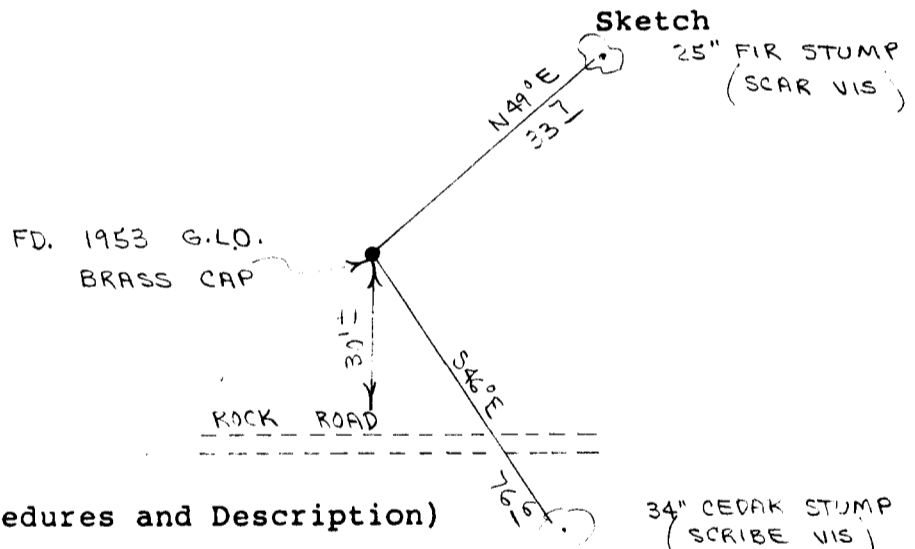

Monument Set (Procedures and Description)

\_\_\_\_\_  
\_\_\_\_\_  
\_\_\_\_\_

New Accessories

Set metal fence post beside brass cap. Wired survey attention sign to fence post.

\_\_\_\_\_  
\_\_\_\_\_

Location & Comments

Corner lies on flat ground about 30' North of B.L.M. rock Road. Corner lies in light stand of 10-15 year old reproduction.

Compass Declination 20 $\frac{1}{2}$   
Firm/Agency Roberts Surveying Inc.  
Address 29 West 29th St. Eugene, Oregon 97405  
Party Chief Les Roberts  
Notes Ted Baker  
Witness Stu Duce

Surveyor's Seal

