

M 96-31

FILED  
RECEIVED *BR*

OREGON CORNER RESTORATION FORM

APR 10 1984

Section 30 Township 20S Range 9W

COUNTY SURVEYOR  
DOUGLAS COUNTY, ORE.

County Douglas Date 3-28-84

Corner Designation

Witness Corner to  
C.S. 1/16 Corner  
Section 30

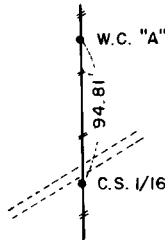

- Condition Report Only
- Not Found
- Renewed
- Unrecorded
- Surveyed In
- Referenced Out

Previous Renewals/Surveys, etc. See Survey M90-23 by Roberts  
Surveying Inc. dated October 3, 1982.

Monument(s) & Accessories Found: (Condition and Source)

Monument Detail

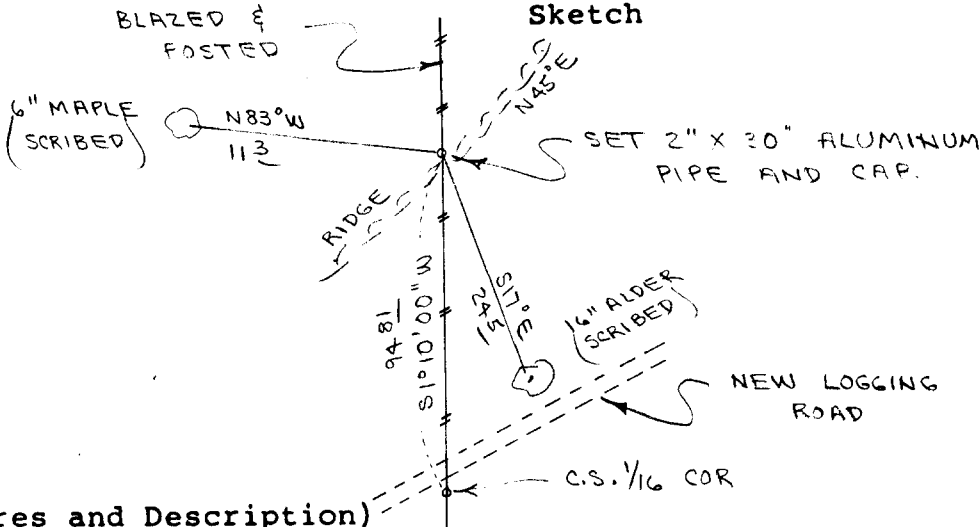

Monument Set (Procedures and Description)

Set 2" x 30" Aluminum Pipe and Cap. True C.S. 1/16 Corner bears  
S 1° 10' 00" W, 94.81'. Aluminum cap stamped S-T-R, date and  
P.L.S. No. 1039. Set metal fence post beside aluminum cap.  
wired land survey monument sign to fence post.

New Accessories

- 6" Maple, N83W, 11.3' (Scribed/Painted/Brass Washer)
- 16" Alder, S17E, 24.5' (Scribed/Painted/Brass Washer)

Location & Comments

Corner falls on  
narrow ridge sloping  
to N.E. Ridge bears  
N45E.

Compass Declination 20 1/2  
Firm/Agency Roberts  
Surveying Inc.  
Address 29 West 29th St.  
Eugene, Oregon 97405  
Party Chief Les Roberts  
Notes \_\_\_\_\_  
Witness Marion Hunter

Surveyor's Seal

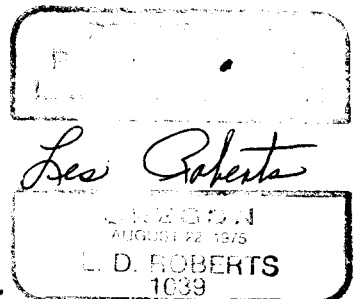

C.S. File No. 58/293(N)