

M 96-31

FILED
RECEIVED BS

OREGON CORNER RESTORATION FORM

APR 10 1984

Section 30 Township 20S Range 9W

COUNTY SURVEYOR
DOUGLAS COUNTY, ORE.

County Douglas Date 3-28-84

Corner Designation

C.S. 1/16 Corner
Section 30

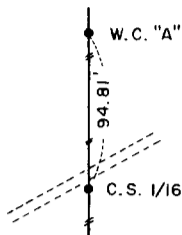

- Condition Report Only
- Not Found
- Renewed
- Unrecorded
- Surveyed In
- Referenced Out

Previous Renewals/Surveys, etc. See Survey M90-28 by Roberts
Surveying Inc dated October 8, 1982.

Monument(s) & Accessories Found: (Condition and Source)

Found 1 1/2" x 36" Iron Pipe and Brass Cap set in Survey M90-28

14" Maple, S43W, 21.3' (Scribe Vis.), 1982 BT. Rec. S43W, 21.3'

20" Fir, S82E, 29.1' (Scribe Vis.), 1982 BT. Rec. S82E, 29.1'

Monument Detail

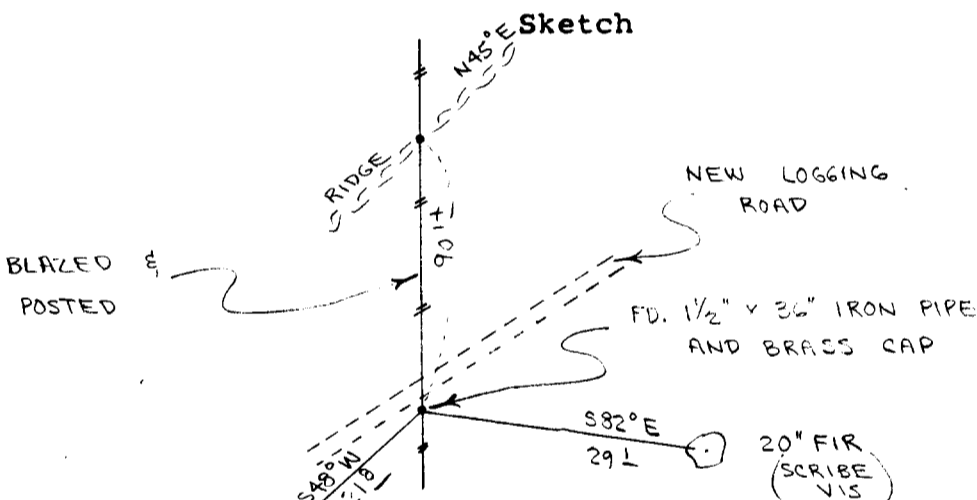

Monument Set (Procedures and Description)

14" MAPLE (SCRIBE VIS)

New Accessories

None

Location & Comments

Corner lies on steep S.E. slope about 90' South of ridge. Ridge bears N45E.

Compass Declination 20 1/2'

Firm/Agency Roberts Surveying Inc.

Address 29 West 29th St. Eugene, Oregon 97405

Party Chief Les Roberts

Notes

Witness Marion Hunter

Surveyor's Seal

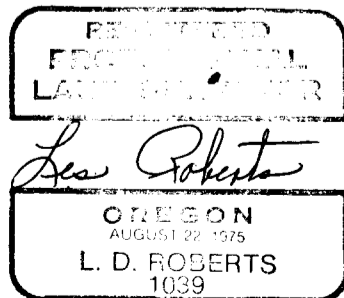

C.S. File No. 58/293 (2b)