

M 96-30

FILED
RECEIVED *BR*

OREGON CORNER RESTORATION FORM

APR 10 1984

Section 5 Township 21S Range 9W

COUNTY SURVEYOR
DOUGLAS COUNTY, ORE.

County Douglas Date 3-27-84

Corner Designation

Witness Corner
to $\frac{1}{4}$ Corner
Section 5

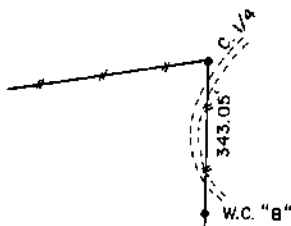

- Condition Report Only
- Not Found
- Renewed
- Unrecorded
- Surveyed In
- Referenced Out

Previous Renewals/Surveys, etc. See survey M90-30 by Roberts
Surveying dated December 21, 1982

Monument(s) & Accessories Found: (Condition and Source)

Monument Detail

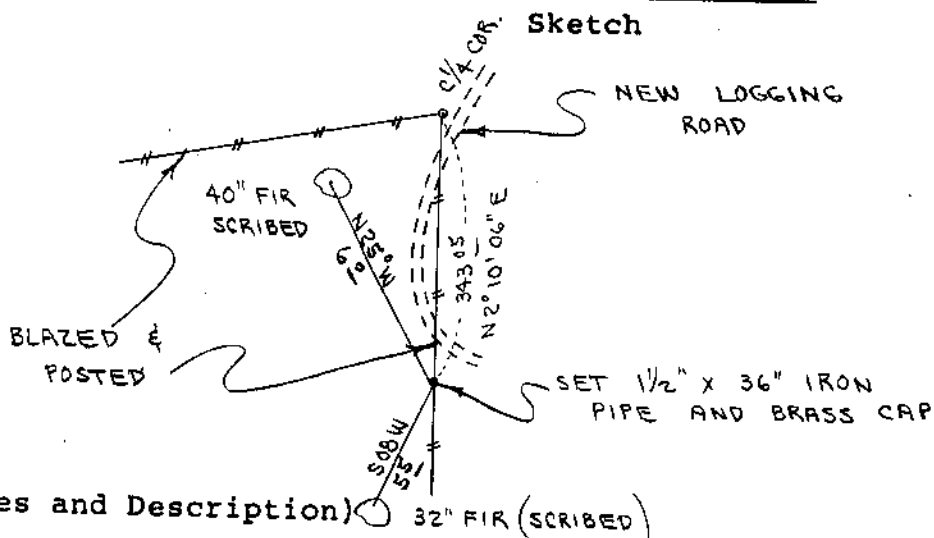

Monument Set (Procedures and Description)
Set $1\frac{1}{2}$ " x 36" Iron Pipe and Brass Cap. Buried orange magnetic
marker under 36" pipe. True center $\frac{1}{4}$ corner bears N 2° 10' 06" E,
343.05'. Brass Cap stamped S-T-R, date and P.L.S. No. 1039.

New Accessories

- 32" Fir, S08W, 5.5' (Scribed/Painted/Brass Washer)
- 40" Fir, N25W, 6.0' (Scribed/Painted/Brass Washer)

Location & Comments

Corner falls on N.E. slope in light stand of 150 year old green timber
Compass Declination $20\frac{1}{2}$
Firm/Agency Roberts
Surveying Inc,
Address 29 West 29th St.
Eugene, Oregon 97405
Party Chief Les Roberts
Notes Stu Duce
Witness Marion Hunter

Surveyor's Seal

