

M 96-30

FILED
RECEIVED *BS*

APR 10 1984

OREGON CORNER RESTORATION FORM

Section 5 Township 21S Range 9W

COUNTY SURVEYOR
DOUGLAS COUNTY, ORE.

County Douglas Date 3-27-84

Corner Designation

C.S. 1/16 Corner
Section 5

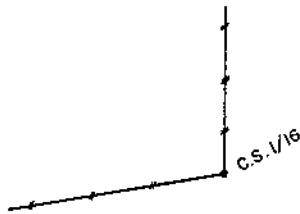

- Condition Report Only
- Not Found
- Renewed
- Unrecorded
- Surveyed In
- Referenced Out

Previous Renewals/Surveys, etc. See survey M90-30 by Roberts
Surveying dated December 21, 1982

Monument(s) & Accessories Found: (Condition and Source)

Found 1 1/2" Iron Pipe and Brass Cap set in Survey M90-30

9" Fir, N01W, 51.4' (Scribe Vis.), 1982 BT. Rec. N01W, 51.4'

41" Fir, S69W, 11.2' (Scribe Vis.), 1982 BT. Rec. S69W, 11.2'

Monument Detail

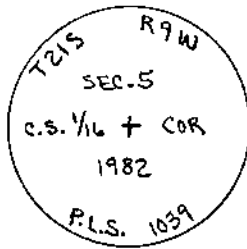

9" FIR
(SCRIBE
VIS)

BLAZED &
POSTED

41" FIR
(SCRIBE
VIS)

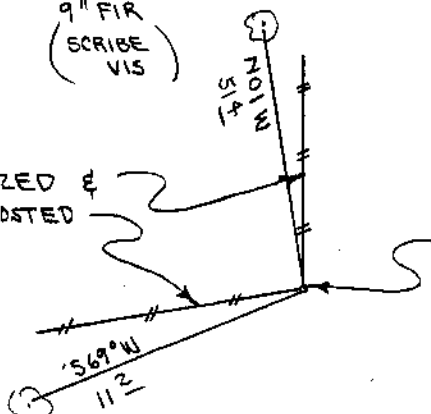

Sketch

FD. 1 1/2" X 36" IRON
PIPE & BRASS CAP

Monument Set (Procedures and Description)

New Accessories

None

Location & Comments

Corner falls on S.W.
slope in light stand
of 150 year old
green timber

Compass Declination 20 1/2

Firm/Agency Roberts

Surveying Inc.

Address 29 West 29th St.

Eugene, Oregon 97405

Party Chief Les Roberts

Notes Stu Duce

Witness Marion Hunter

Surveyor's Seal

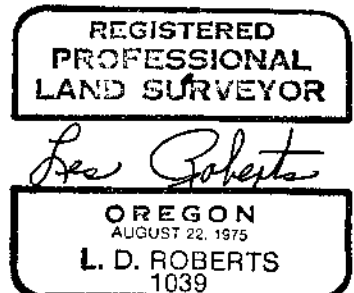

C.S. File No. 58/293¹⁰(N)