

M 96-26

FILED RECEIVED *BS*

MAR 29 1984

OREGON CORNER RESTORATION FORM

Section 35 Township 20S Range 9W

COUNTY SURVEYOR
DOUGLAS COUNTY, ORE.

County Douglas Date 3-06-84

Corner Designation

North 1/16 Corner
Section 35

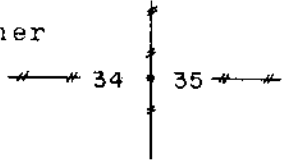

- Condition Report Only
- Not Found
- Renewed
- Unrecorded
- Surveyed In
- Referenced Out

Previous Renewals/Surveys, etc. None

Monument(s) & Accessories Found: (Condition and Source)

Monument Detail

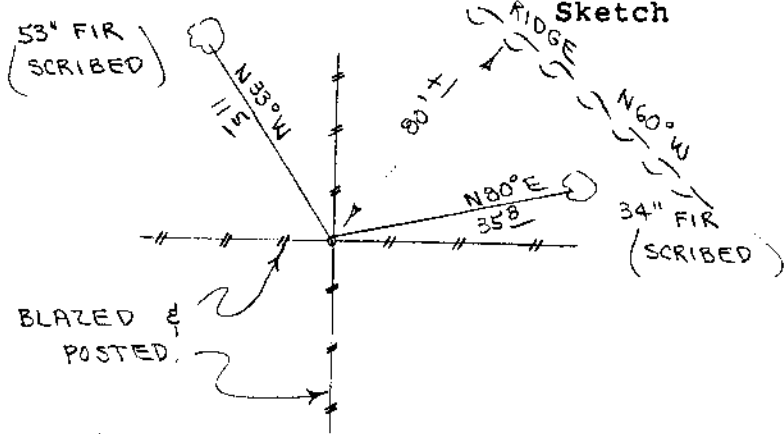

Monument Set (Procedures and Description)

Set 2" x 36" Aluminum pipe and cap. Cap stamped S-T-R, date and P.L.S. No. 1039. Buried purple magnetic marker under 36" pipe. See filed survey for survey procedures.

New Accessories

- 34" Fir, N80E, 35.8' (Scribed/Painted/Brass Washer)
- 53" Fir, N33W, 11.5' (Scribed/Painted/Brass Washer)
- Set metal fence post, with land monument survey sign wired to, beside aluminum pipe.

Location & Comments

Corner lies on Southwest slope about 80 feet below top of narrow ridge. Compass Declination 20 1/2

Firm/Agency Roberts Surveying Inc.

Address 29 West 29th Street Eugene, Oregon 97405

Party Chief Ted Baker

Notes Stu Duce

Witness Buzz Moisan

Surveyor's Seal

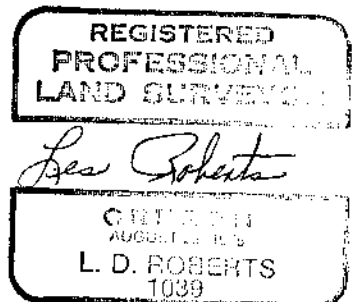

2 *✓*

C