

M 96-26

FILED
RECEIVED BS

MAR 29 1984

OREGON CORNER RESTORATION FORM

Section 35 Township 20S Range 9W

COUNTY SURVEYOR
DOUGLAS COUNTY, ORE.

County Douglas Date 3-06-84

Corner Designation

C.N. 1/16 Corner
Section 35



- Condition Report Only
- Not Found
- Renewed
- Unrecorded
- Surveyed In
- Referenced Out

Previous Renewals/Surveys, etc. None

Monument(s) & Accessories Found: (Condition and Source)

Monument Detail

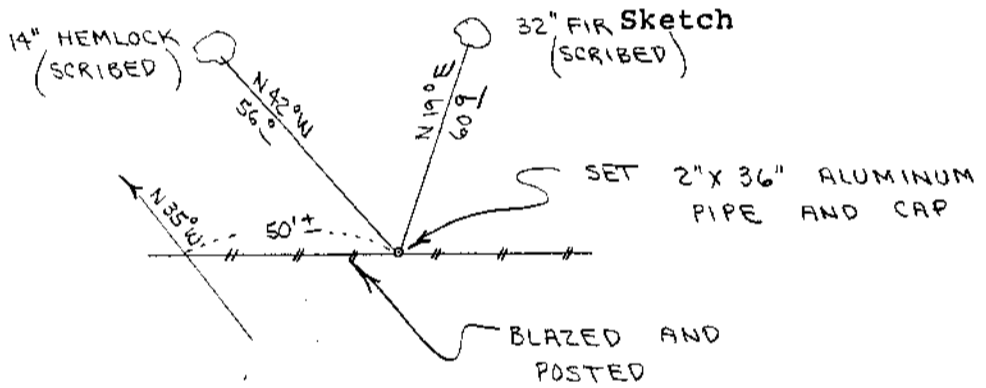

Monument Set (Procedures and Description)

Set 2" x 36" Aluminum pipe and cap. Cap stamped S-T-R, date and P.L.S. No. 1039. Buried purple magnetic marker under 36" pipe. See filed survey for survey procedures.

New Accessories

- 14" Hemlock, N42W, 56.0' (Scribed/Painted/Brass Washer)
- 32" Fir, N19E, 60.9' (Scribed/Painted/Brass Washer)
- Set metal fence post, with land survey monument sign wired to, beside aluminum pipe.

Location & Comments

Corner lies on steep Northwest slope about 50 feet East of draw. Compass Declination 20 1/2
Firm/Agency Roberts Surveying Inc.
Address 29 West 29th St. Eugene, Oregon 97405
Party Chief Ted Baker
Notes Stu Duce
Witness Buzz Moisan

Surveyor's Seal

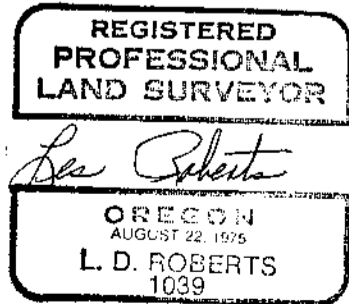

C.S. File No. 58/280 (with handwritten notes '6F OK' and 'fsm')

C