

M 96-26

FILED
RECEIVED BS

MAR 29 1984

OREGON CORNER RESTORATION FORM

Section 35 Township 20S Range 9W

COUNTY SURVEYOR
DOUGLAS COUNTY, ORE.

County Douglas Date 2-15-84

Corner Designation

East $\frac{1}{4}$ Corner
Section 35

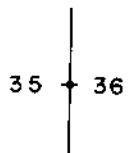

- Condition Report Only
- Not Found
- Renewed
- Unrecorded
- Surveyed In
- Referenced Out

Previous Renewals/Surveys, etc. Thomas A. Tillman and Joseph S. Gavron G.L.O. Survey in 1953-1954.

Monument(s) & Accessories Found: (Condition and Source)

No evidence found of Brass Cap or Bt's set by G.L.O. in 1954.
Corner falls in steep and narrow creek bottom. Creek has been
torn up by old logging.

Monument Detail

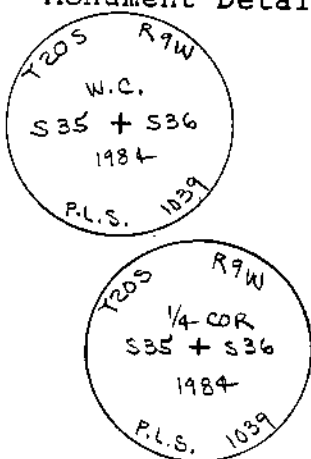

Sketch

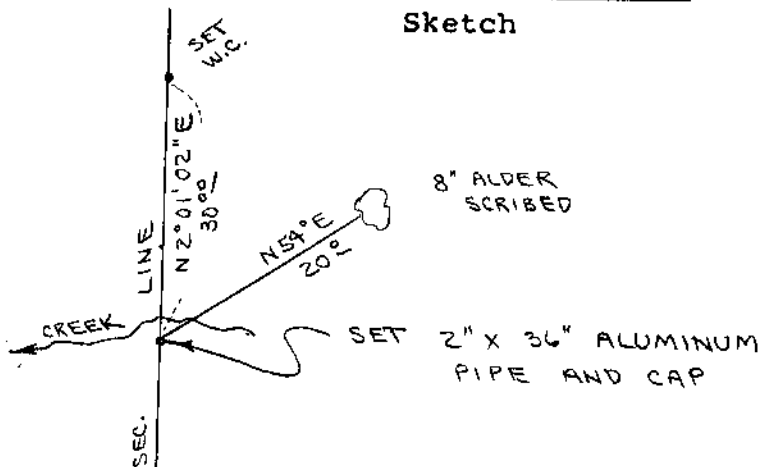

Monument Set (Procedures and Description)

Set 2" x 36" aluminum pipe and cap by proportionate measure.
Buried purple magnetic marker under cap.
8" Alder, N54E, 20.0' (Bark Scribed/Painted/Washer)
Also set 2" x 36" aluminum pipe and cap for witness corner. W.C.
bears N 2° 01' 02" E, 30.00' from $\frac{1}{4}$ Corner. Buried purple M.M.
New Accessories under 36" aluminum pipe.

8" Alder, N54E, 20.0' (bark Scribed/Painted/Brass Washer)
Set metal fence post beside brass cap. Wired survey monument
sign to fence post.

Location & Comments

Corner lies 8' South Compass Declination 20 $\frac{1}{2}$
of 2' Creek in steep Firm/Agency Roberts
narrow canyon. Surveying Inc.
Address 29 West 29th St.
Eugene, Oregon 97405
Party Chief Les Roberts
Notes Ted Baker
Witness Stu Duce

Surveyor's Seal

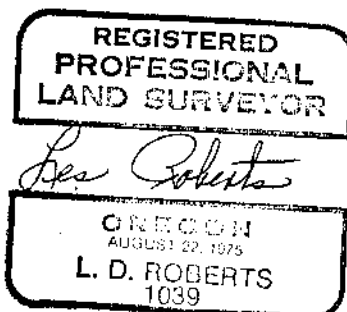

#53 X

c