

M 90-52

FILED  
RECEIVED *BS*

MAR 22 1984

OREGON CORNER RESTORATION FORM

Section 22 Township 22S Range 9W

County Douglas Date 9-16-83

COUNTY SURVEYOR  
DOUGLAS COUNTY, ORE.

Corner Designation

N.E. 1/16 Corner  
Section 22



- Condition Report Only
- Not Found
- Renewed
- Unrecorded
- Surveyed In
- Referenced Out

Previous Renewals/Surveys, etc. None

Monument(s) & Accessories Found: (Condition and Source)

Monument Detail

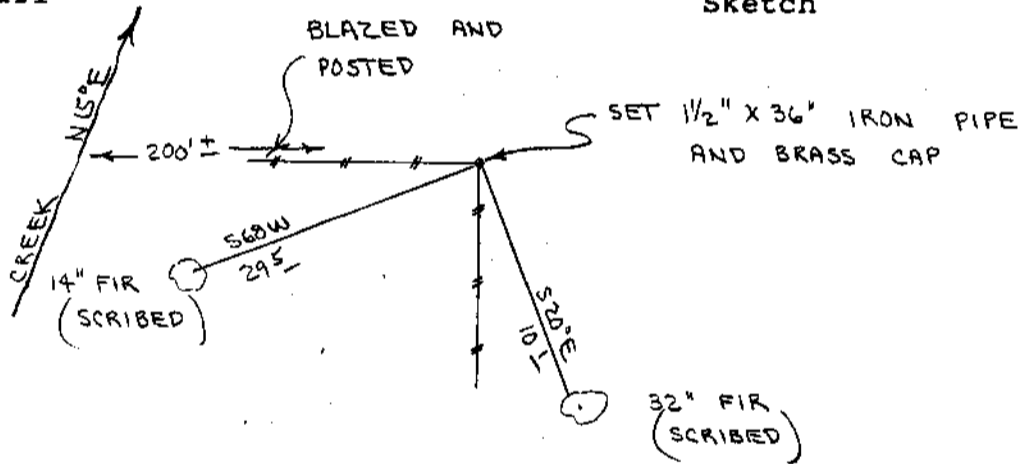

Sketch

Monument Set (Procedures and Description)

Set 1 1/2" x 36" Iron Pipe and Brass Cap. Cap stamped S-T-R, date and P.L.S. No. 1039. Buried orange magnetic marker under 36" pipe. See filed survey for survey procedures.

New Accessories

14" Fir, S68W, 29.5' (Scribed/Painted/Brass Washer)

32" Fir, S20E, 10.1' (Scribed/Painted/Brass Washer)

Location & Comments

Corner lies on gentle North slope about 200' East of creek. Creek bears N15E & S15W

Compass Declination 20 1/2

Firm/Agency Roberts Surveying Inc.

Address 29 West 29th St. Eugene, Oregon 97405

Party Chief Ted Baker

Notes Stu Duce

Witness

Surveyor's Seal

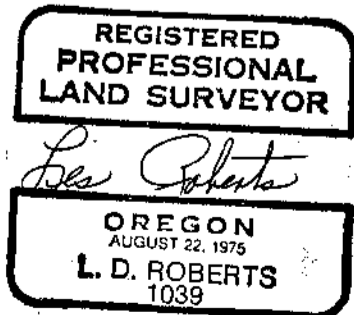

C.S. File No. 58/280-5