

M 90-52

FILED  
RECEIVED *BS*

MAR 22 1984

OREGON CORNER RESTORATION FORM

Section 22 Township 22S Range 9W  
County Douglas Date 3-25-83

COUNTY SURVEYOR  
DOUGLAS COUNTY, ORE.

Corner Designation

N.W. Corner Section 22	16	15
	21	22

- Condition Report Only
- Not Found
- Renewed
- Unrecorded
- Surveyed In
- Referenced Out

Previous Renewals/Surveys, etc. Wofford, Rogers and Chatters  
Cadastral Survey dated 1973-1979. Harvey Wofford's Cadastral  
Survey dated 1983 (Unapproved). Milo Godfrey, D.C.S., in 1962.

Monument(s) & Accessories Found: (Condition and Source)

- Found 1973 B.L.M. Brass Cap set firmly in ground.
- 18" Fir, S85E, 11.1' (Scar Vis.), 1939 BT. Rec. S84E, 11.2'
- 18" Fir, N43E, 9.0' (Scar Vis.), 1939 BT. Rec. N45E, 9.9'
- 38" Fir, N40W, 54.4' (Scar Vis.), 1939 BT. Rec. N40W, 54.1'
- 32" Fir, S66W, 32.6' (Scar Vis.), 1962 BT. Rec. S66W, 33.7'
- 12" Fir, N85E, 11.1' (Scar Vis.), 1973 BT. Rec. N85E, 11.9'

Monument Detail

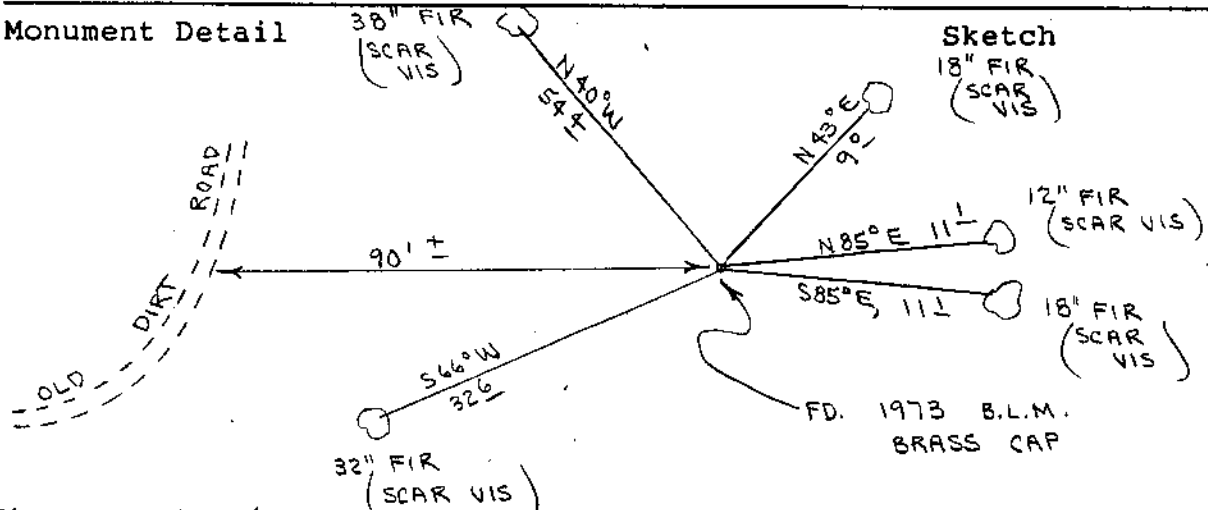

Monument Set (Procedures and Description)

\_\_\_\_\_  
\_\_\_\_\_  
\_\_\_\_\_

New Accessories

None

Location & Comments

Corner lies on gentle West slope about 90'  
East of a old dirt logging road.  
Compass Declination 20 1/2  
Firm/Agency Roberts  
Surveying Inc.  
Address 29 West 29th St.  
Eugene, Oregon 97405  
Party Chief Les Roberts  
Notes Ted Baker  
Witness Stu Duce

Surveyor's Seal



*old  
fem*

C.S. File No. 58/280-5C