

M 96-24

FILED
RECEIVED BS

OREGON CORNER RESTORATION FORM

MAR 28 1984

Section 21 Township 22S Range 9W

COUNTY SURVEYOR
DOUGLAS COUNTY, ORE.

County Douglas Date 10-11-83

Corner Designation

S.E. 1/16 Corner
Section 21

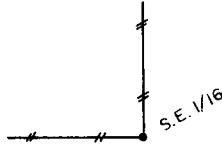

- Condition Report Only
- Not Found
- Renewed
- Unrecorded
- Surveyed In
- Referenced Out

Previous Renewals/Surveys, etc. None

Monument(s) & Accessories Found: (Condition and Source)

Monument Detail

Sketch

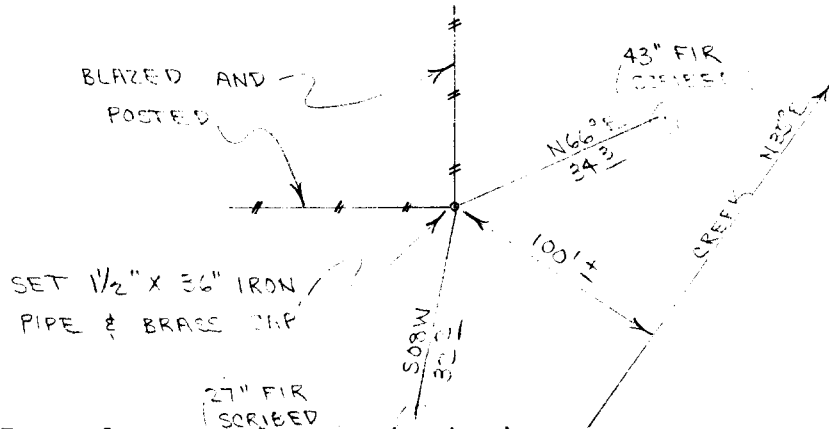
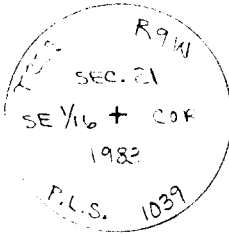

Monument Set (Procedures and Description)

Set 1 1/2" x 36" Iron Pipe and Brass Cap. Cap stamped S-T-R, date and P.L.S. No. 1039. Buried orange magnetic marker under 36" pipe. See filed survey for survey procedures.

New Accessories

- 27" Fir, S03E, 32.2' (Scribed/Painted/Brass Washer)
- 43" Fir, N66E, 34.3' (Scribed/Painted/Brass Washer)

Location & Comments

Surveyor's Seal

Corner lies on S.E. slope about 100' Northwestery of creek. Creek bears N35E.

Compass Declination 20 1/2

Firm/Agency Roberts Surveying Inc.

Address 29 West 29th St. Eugene, Oregon 97405

Party Chief Ted Baker

Notes Stu Duce

Witness _____

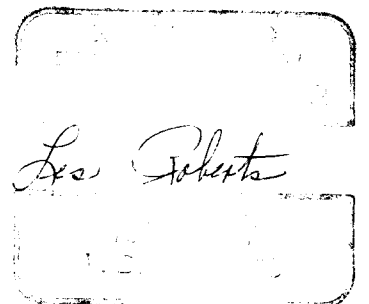

C.S. File No. 58/280(N)