

M 96-24

FILED
RECEIVED *BJ*

OREGON CORNER RESTORATION FORM

MAR 28 1984

Section 21 Township 22S Range 9W

COUNTY SURVEYOR
DOUGLAS COUNTY, ORE.

County Douglas Date 4-01-83

Corner Designation

East 1/16 Corner
Section 21
21
+
28

- Condition Report Only
- Not Found
- Renewed
- Unrecorded +
- Surveyed In
- Referenced Out

Previous Renewals/Surveys, etc. Wofford, Rogers and Chatters
Cadastral Survey dated 1973-1979.

Monument(s) & Accessories Found: (Condition and Source)

Found 1975 B.L.M. Brass Cap set firmly in ground.
20" Fir, N33E, 33.9' (Scar Vis.), 1975 B.T. Rec. N31E, 33.0'
45" Fir, S67E, 81.0' (Scar Vis.), 1975 B.T. Rec. S63E, 80.5'

Monument Detail

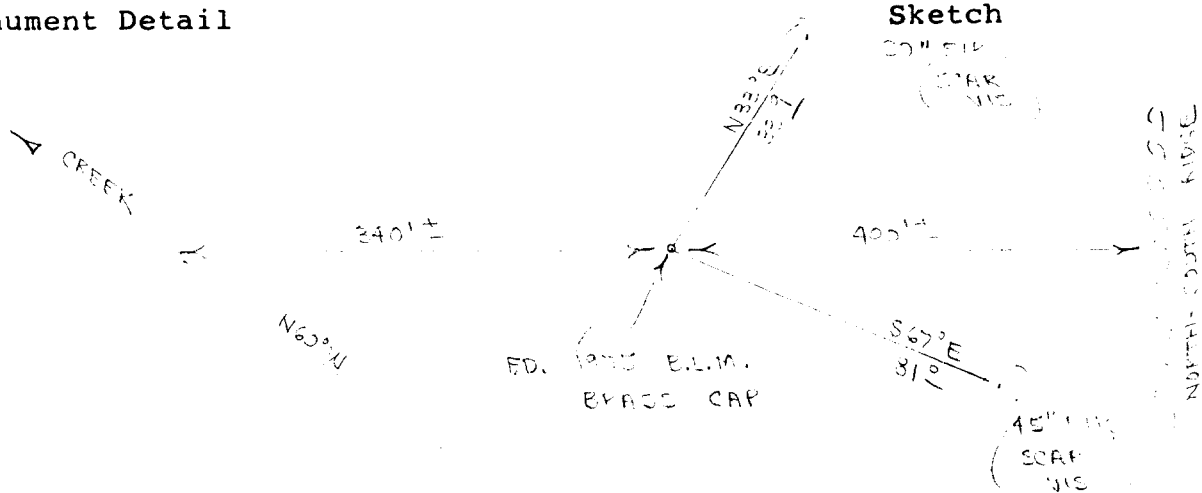

Monument Set (Procedures and Description)

New Accessories

None

Location & Comments

Corner lies on West Compass Declination 20 1/2
slope about 400' West Firm/Agency Roberts
of ridge. Ridge bears Surveying Inc.
North - South. Address 29 West 29th St.
Corner also lies Eugene, Oregon 97405
about 340' East of Party Chief Les Roberts
creek. Creek bears Notes Ted Baker
N60W. Witness Stu Duce

Surveyor's Seal

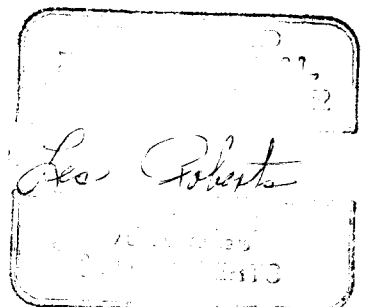

C.S. File No. CS. 58/280 (u)