

FILED ✓
RECEIVED BS

JAN 14 1982

PROPERTY SURVEY FOR INTERNATIONAL PAPER CO. ✓

COUNTY SURVEYOR
DOUGLAS COUNTY, ORE.

NE 1/4, SECTION 23, T21S, R12W

DEC. 1981 SCALE 1" = 300'

COUNTY SURVEYORS FILE DATA
DO NOT REMOVE FROM OFFICE

I.P.

THE BEARING OF THE SECTION LINE HAD BEEN PREVIOUSLY ESTABLISHED. THE BASIS IS TRUE FROM SOLAR OBSERVATION. SEE M84-24A FOR MY NOV. 1980 SURVEY.

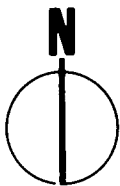

LEGEND

- CORNER FOUND 
- SET 1 1/4 x 36" I.P. / STAMPED BRASS CAP  P.L.S. 497
- PROPERTY LINE ESTABLISHED, 1/2 x 60" I.R.'S WITH ATTACHED ALUMINUM SIGNS 

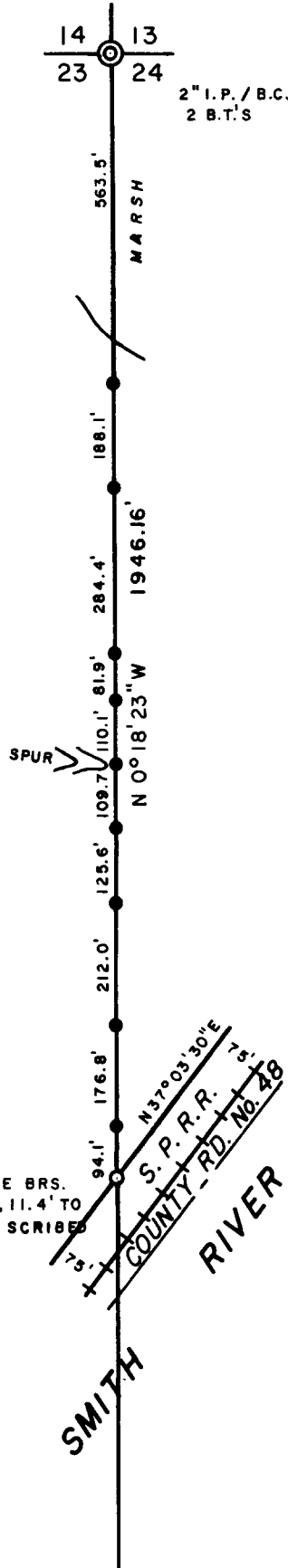

REGISTERED
PROFESSIONAL
LAND SURVEYOR

Richard J. Hintz

OREGON
MAY 13, 1960
RICHARD J. HINTZ
497

RICHARD J. HINTZ
1890 N. 14th ST.
COOS BAY, OREGON