

T 30 - 5

Information of

$\frac{1}{4}$  (Quarter) corners and  
 $\frac{1}{16}$  (Sixtieth) corners  
(SIXTEENTH)

As determined by the Survey  
of Glenn Hills Subdivision

See Plat Recorded in  
Douglas County Surveyor's Office

Vol. 16 , Page 74

FILED  
RECEIVED

JAN 17 1983

COUNTY SURVEYOR  
DOUGLAS COUNTY, ORE.

File No. 58/229-19

Oct 20, 1982

N 1/16 "CC" corn Sec 30, Township  
30 South, Range 5 West, W.M

BT corn pt. set 1/2" x 3/8" galv. pipe  
with Brass Cap mkd. LS 1261

N 1/16 | S 30  
|  
C  
1982

from which

A 10" Madrona bears S 75° W 25<sup>20</sup> ft  
dist mkd. N 1/16 Sec 30 BT

A 20" madrona bears N 25° W 28<sup>50</sup> ft  
dist mkd N 1/16 Sec 30 BT

John H. Markham Jr.

Raymond Brown - witness

Jim McDaniels - " "

Van Allen. - " "

John H. Markham Jr

P.O. Box 802

Myrtle Cr., Or.

97457

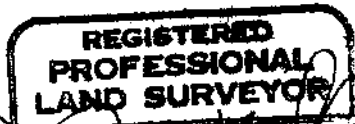

*John H. Markham Jr*

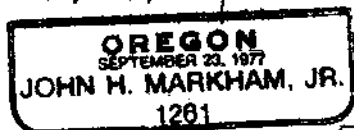

S. File No. 58/229

Oct 20, 1982

N 1/16 cor. between Sec 29 & 30,  
Township 30 South, Range 5 West, W. M.  
AT CORN. Pt. set 1 1/2" x 36" galv pipe  
with Brass Cap mkd

L 5 1261  
N 1/16  
530 | 529  
1982

From which

A 40" Madrova Bears S48°E 36<sup>00</sup>ft  
dist mkd. N 1/16 529 BT

A 10" W OAK Bears N26°E 18<sup>00</sup>ft dist  
MKD. N 1/16 530 BT

John H. Markham Jr -

Raymond Brown - Witness

Jim McDaniels - "

Van Allen - "

John H. Markham Jr.

P.O. Box 802

Myrtle Cr., OR.

97459

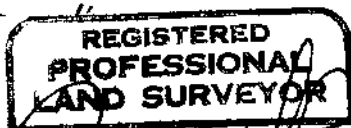

*John H. Markham Jr*

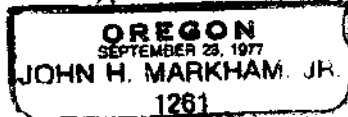

C. & File No. 58/229

Oct. 20, 1982

NE 1/16 CORN Sec 30, Township 30  
South, Range 5 West, W. M.

AT CORN. pt sat 1 1/2" x 3/8" galv. pipe  
with Brass Cap mkd. L.S. 1261

NE 1/16 S30

1982

From which

A 12" cedar Bears S25°W 9<sup>80</sup>ft dist  
mkd NE 1/16 S30 BT

A 18" W OAK Bears N45°W 21<sup>70</sup>ft dist  
mkd NE 1/16 S30 BT

John H. Markham Jr.

Raymond Brown witness

Jim Mc Daniels - " "

Van Allen - " "

John H. Markham Jr

P.O. Box 802

Myrtle Cr., OR

97457



*John H. Markham Jr*

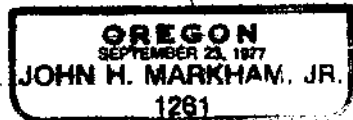

U.S. File No. 58/229

✓

Oct 20 1982

C 1/4 cor. SEC 30, Township 30 South,  
Range 5 West, W.M.

AT CORN. PT. set 1 1/2" X 36" galv.  
pipe w/brass cap MKD 25 126'

C 1/4. S30

1982

From Which

A 14" Pine Bears due West 272<sup>00</sup> ft  
dist MKD C 1/4 S30 BT

A 30" W OAK Bears N 70<sup>00</sup> E 213<sup>60</sup> ft  
dist MKD C 1/4 S30 BT

John H. Markham Jr.

Raymond Brown - witness

Jim McDaniels - "

Van Allen - "

John H. Markham Jr.

P.O. Box 802

Myrtle Cr. OR.

97457



*John H. Markham Jr.*



#302 X

C. S. File No. 58/229

Oct 20, 1982

E  $\frac{1}{16}$ " "CC" Sec. 30, Township 30 South,  
Range 5 West, W.M.

AT corner pt. set 1  $\frac{1}{2}$ " X 36" galv. pipe  
with Brass Cap mkd. AS 1261

C E  $\frac{1}{16}$ " C

S 30

1982

from which

A 8" W. OAK Bears N60°E 3.5 ft dist  
mkd E  $\frac{1}{16}$  S 30 BT

A 20" W. OAK Bears S15°W 16 <sup>50</sup> ft dist  
mkd E  $\frac{1}{16}$  S 30 BT

John H. Markham Jr

Raymond Brown - Witness

Jim McDaniels - "

Van Allen - "

John H. Markham Jr.

P.O. Box 802

Myrtle Cr., Or.

27457



*John H. Markham Jr.*

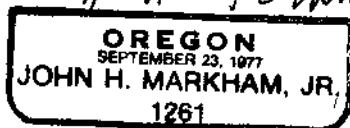

File No. 58/229

Information of

$\frac{1}{4}$  Corner &  $\frac{1}{16}$  Corner

as determined by the Survey

for William Stobridge

See Map Recorded in  
Douglas County Surveyor's Office

M - 92 - 33

May 24, 1982

1/4 cor. between Sec. 19 & 30, Township  
30 South, Range 5 West, W.M.

AT cor pt. set 1 1/4" x 36" galv pipe  
with Brass cap mkd. L.S. 1261

1/4  $\frac{S 19}{S 30}$

1982

from which

A 18" maple bears S 22° E 4.0 feet  
dist. mkd 1/4 S S 30 BT

A 24" Fir bears N 25° E 38<sup>30</sup> feet  
dist mkd 1/4 S S 19 BT

Road & bears East 47 ft

John H. Markham Jr. -

Raymond Brown - witness

Jim McDaniel - witness

John H. Markham Jr.  
P.O. Box 802  
Myrtle Cr., Ore  
97457

REGISTERED  
PROFESSIONAL  
LAND SURVEYOR

OREGON  
SEPTEMBER 23, 1977  
JOHN H. MARKHAM, JR.  
1261

#301 (from survey)

S. File No.

59/229

May 24, 1982

E  $\frac{1}{16}$  cor. between Sec. 19 & 30, Township  
30 South, Range 5 West, W. M.

At cor. pt. set  $1\frac{1}{4}$ " x 36" galv. pipe  
with Brass cap mkd. L.S. 1261

E  $\frac{1}{16}$   $\frac{S19}{S30}$   
1982

From which

A 12" white Oak bears N64°W 8.6 feet  
dist mkd  $\frac{1}{16}$  S S19 BT

A 8" white Oak bears S52°E 16.8 feet  
dist mkd  $\frac{1}{16}$  S S30 BT

John H. Markham Jr

Raymond Brown - Witness

Jim Mc Daniels - Witness

John H. Markham Jr  
P.O. Box 802  
Myrtle Cr., Or.  
97457



*John H. Markham Jr*

