

UNITY SURVEYORS FILE DATA
DO NOT REMOVE FROM OFFICE

FILED α
RECEIVED ϕ

SURVEY TO SET W 1/16 CORNER BETWEEN SECTIONS 11 & 14, T24S, R7W, W1M

AUG 8 1980
COUNTY SURVEYOR
DOUGLAS COUNTY, ORE.
 α

FOR: LEROY STANLEY
BY : BHW ENGINEERING & SURVEYING, INC.
1205 SE COURT
ROSEBURG, OR. 97470

JULY, 1980

SCALE: 1"=300'

LEGEND: ● SET 5/8" x 30" IRON ROD
○ FOUND MONUMENT AS NOTED
⊙ FOUND BRASS CAP

REGISTERED
PROFESSIONAL
LAND SURVEYOR

Romanso E. Ware

OREGON
NOV. 16, 1973
ROMANSO E. WARE
1005

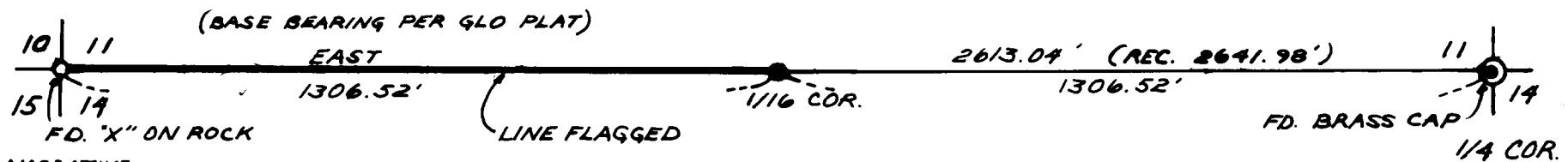

NARRATIVE:

SURVEY FOR THE PURPOSE OF TRAVERSING AND FLAGGING THE WEST 1/4 MILE OF THE NORTH LINE OF SECTION 14. SURVEY ACCOMPLISHED BY RANDOM TRAVERSE FROM THE N.W. CORNER OF SECTION 14 TO THE NORTH 1/4 CORNER, TRUE LINE COMPUTED AND RAN. FIELD CREW CONSISTED OF GREG LANG AND BOB ORTON WITH COMPUTATIONS BY ROMEO WARE AND DRAFTING BY THERESA SWINFORD. EQUIPMENT - WILD-T-1 THEODOLITE MOUNTED WITH LEITZ RED-1 E.D.M.

ESTABLISHED B.T.'S:

- A 12" D. FIR BEARS N 62° W 10.1 FT. SCRIBED "W'1/16 S11 B.T."
- A 28" D. FIR BEARS S 24° E 17.8 FT. SCRIBED "W'1/16 S14 B.T."

C. S. File No. C.S. 58/225