

FILED ϕ
RECEIVED ϕ

DEC 13 1979

WEYERHAEUSER COMPANY
SOUTHWEST OREGON REGION
SURVEY IN
SECTION 35, T.27S., R.8W., W.M.
DOUGLAS COUNTY, OREGON

COUNTY SURVEYOR
DOUGLAS COUNTY, ORE
 ϕ

NOVEMBER 26, 1979

SCALE 1" = 500'

COUNTY SURVEYORS FILE DATA
DO NOT REMOVE FROM OFFICE

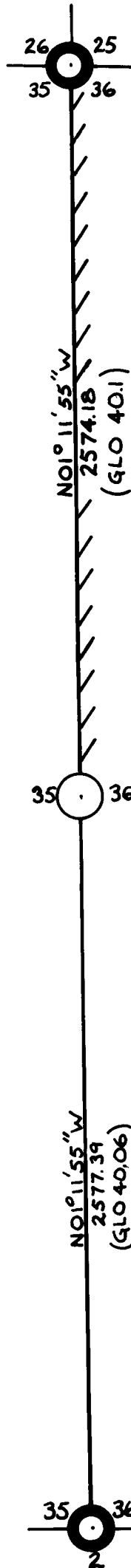

LEGEND

CORNERS FOUND



CORNER SET



LINE MARKED



BASIS OF BEARING: SOLAR
OBSERVATION



REGISTERED
PROFESSIONAL
SURVEYOR

Henry G. Roberts

NOV 12 1979
HENRY G. ROBERTS
618

DRN:T.H. 12-7-79

COUNTY SURVEYORS FILE DATA
DO NOT REMOVE FROM OFFICE

WEYERHAEUSER COMPANY

SOUTHWEST OREGON REGION

Survey in
Section 35, Township 27 South, Range 8 West, W.M.
Douglas County, Oregon

November 26, 1979

This survey was conducted to establish the E 1/4 corner of Section 35, T27S, R8W, W.M. and to mark company ownership along the section line. Traverse closure through control points exceeded 1:9000 using a Jena 020A theodolite with a Mac I electronic distance meter.

The bearings on the accompanying plat are based on solar observation. Off-sets to true line were calculated and the lines marked are shown on the plat.

Corner Information:

The following is a record of all corners found or set. Weyerhaeuser company tags nailed on BT's list the distance and bearing from the "W" nails, set in the root collars, to the corner monument. Bearing tree information bearings and measurements are horizontal to center of tree.

NE Corner Section 35

Found: iron pipe, brass cap, and accessories as restored by Douglas County Surveyor in 1971.

SE Corner Section 35

Found: Marking on rock wall at the base of 100' high bluff, including "B0, T27S, R8W," and "S46E, 16" which is the bearing and distance listed by Johnson in 1955 (C.S. file 42-194). No evidence of piton with circular ring, but evidence where originally driven in crack in rock face. Found no trace of 3/4" iron rod for corner.

Set: 1 1/2" iron pipe with brass cap using Johnson's bearing and distance measured from rock wall described above from which:
6" Douglas fir, scribed BT, bears N52 1/2°E, 16.0 feet.

E 1/4 Corner Section 35

Found: No evidence of corner or accessories.

Set: 1 1/2" iron pipe with brass cap, from which:
10" Douglas fir, scribed BT, bears N49°E, 12.4 feet.
12" Douglas fir, scribed BT, bears S89°W, 5.7 feet.

Respectfully Submitted,

Henry R. Reppeto

REGISTERED
PROFESSIONAL
LAND SURVEYOR

OREGON
JULY 12, 1963
HENRY R. REPPETO
618