

M97-60

FILED  
RECEIVED *RS*  
NOV 28 1984

COUNTY SURVEYOR  
DOUGLAS COUNTY, ORE.



Survey Narrative

Survey of Property Lines for U.S. Forest Service

Location: Homestead Entry Survey #182, SE $\frac{1}{4}$  & SW $\frac{1}{4}$  Sec. 18 & NE $\frac{1}{4}$  & NW $\frac{1}{4}$  Sec. 19, T.26 S., R.2 E., W.M. Douglas County, Oregon.

Date of Survey: Nov. 11, 1984

Purpose: To mark the lines of the Umpqua National Forest.

History: August 25, 1916--Homestead Entry Survey #182 by Frederick W. Rase.

August 11, 1930--Township subdivision survey by Otto L. Draper.

October 1969--Corner renewals by Vernon "Ray" Tracy, CS 52743

Procedure: Bearings are based on solar observations using the hour angle method.

A perimeter control traverse was run using Topcon DMC2 E.D.M. & Topcon TL60B Theodolite. Boundary posts were set, by offsets from control traverse stations using 100' steel tape and hand compass, to within 1 foot of the true line between the monumented corners found.

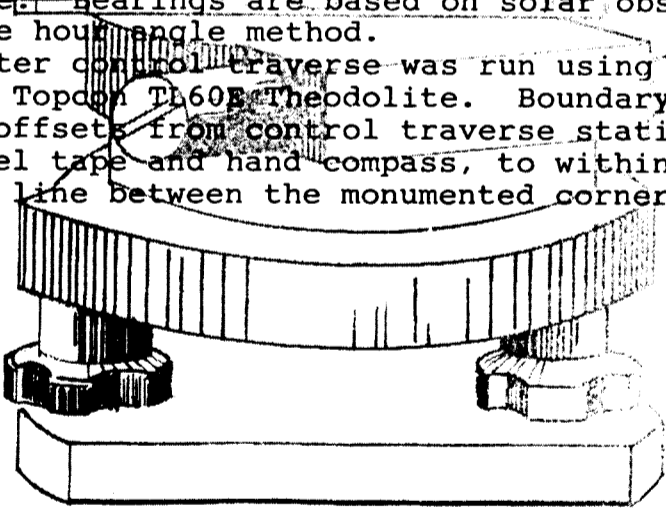

REGISTERED  
PROFESSIONAL  
LAND SURVEYOR

*RS*  
ROBERT G. DEAN  
1984



FILED  
RECEIVED *rh*

NOV 28 1969  
COUNTY SURVEYOR  
DOUGLAS COUNTY, ORE.

Monumented Corners: 18|17 T.26 S., R.2 E., W.M.--  
19|20

Found 1½" galvanized iron pipe and 2½" brass cap, marked as shown, in a 36" cairn, from which:

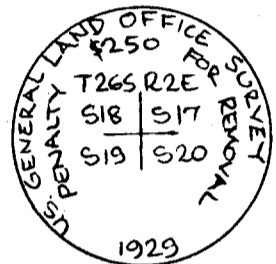

A 54" Douglas Fir, good scar, bears N. 84\*-08'W. 154.7' (record N.85\*W. 155.76' per G.L.O.);

A 25" Ponderosa Pine, scribing visible in low face, bears N. 17\*-22'E. 52.6' (record N.17\*E. 52.14' per G.L.O.);

A 45" Douglas Fir, good scar, bears S. 1\*-00'W. 78.0' (record S.1½\*E. 78.54' per G.L.O.);

A 47" dead Douglas Fir, rotted scar, bears S.8\*-42'W. 100.3' (record S.9\*W. 99.66' per G.L.O.);

New B.T.--A 13" Douglas Fir, scribed "T26S R2E S19 BT" bears S.52\*-54'W. 41.3'. A ¾" brass disc stamped "RLS 1808" is nailed low to the face.

1 H.E.S. 182--

Found 42" Douglas Fir, good scar, facing N. 55\*W., from which:

A 1" galvanized iron pipe with 2½" brass cap, marked as shown, bears N.55\*-00'W. 4.00' (record N.45\*W. 4 ft. per Ren. #34);

A 50" Ponderosa Pine burnt and rotted stump bears N.3\*-45'W. 100.5' (record N.3\*-15'W. 100.32' per H.E.S. 182);

A 38" Ponderosa Pine, scribing visible, bears N.12\*-15'E. 127.6' (record N.13\*-45'E. 126.06' per H.E.S. 182);

A 16" Douglas Fir, good scar, bears S.83\*-45'W. 36.8' (record S.84\*W. 26.4' per Ren. #34);

A 13" Douglas Fir, good scar, bears N.42\*-30'W. 27.3' (record N.41\*W. 29.5' per Ren. #34).



I add figures to cap which now appears as shown --

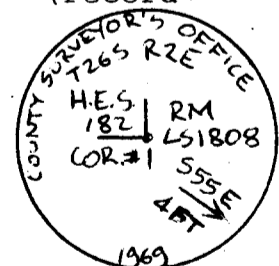
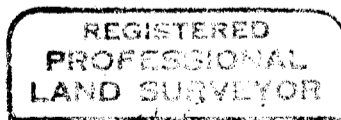

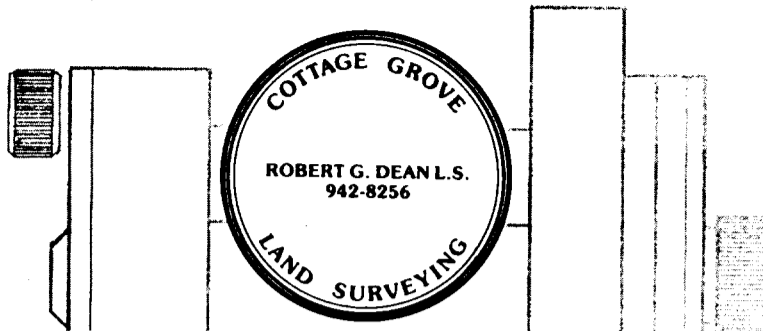

REGISTERED  
PROFESSIONAL  
LAND SURVEYOR

OREGON  
ROBERT G. DEAN  
1969

FILED  
RECEIVED *rl*

VII 24 1969

COUNTY SURVEYOR  
DEPT. COUNTY, ORE.

2 H.E.S. 182--

Found 1" galvanized iron pipe and 2½" brass cap, marked as shown, in 36" cairn on bedrock, from which:

A 48" Douglas Fir, good scar, bears S.29\*-00' W. 106.6' (record S.29\*-20'W. 110.88' per H.E.S. 182);

An 18" Douglas Fir, good scar, bears N.14\*-20'E. 54.3' (record N.16\*E. 53.4' per Ren. #28);

A 21" Douglas Fir, good scar, bears S.84\*-00'E. 40.2' (record S.81\*E. 40.1' per Ren. #28).

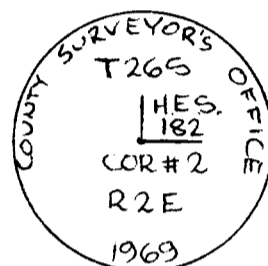

3 H.E.S. 182--

Found 1" galvanized iron pipe with 2½" brass cap, marked as shown, (per Ren. #35) in small cairn, from which:

A 26" Douglas Fir, sawed stump, face visible 6" from center, bears S.60\*-24'E. 33.4' (record S.60\*-45'E. 37.62' per H.E.S. 182);

A 33" sawed Douglas Fir stump, no marks, bears S.40\*-00'W. 30.2' (record S. 39\*-30'W. 28.38' per H.E.S. 182);

A 13" Douglas Fir, good scar, bears N.80\*-30' W. 21.0' (record N.80\*W. 22.5' per Ren. #35);

A 13" Douglas Fir, good scar, bears N.2\*-20'E. 25.5' (record N.3\*E. 25.5' per Ren. #35);

A 13" Maple, scribing visible, bears S.84\*-00'E. 11.8' (record S.84\*E. 12.3' per Ren. #35).

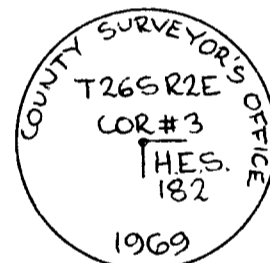

4 H.E.S. 182--

Found 1" galvanized iron pipe with 2½" brass cap, marked as shown, (per Ren. #36) from which:

A 23" x 16" x 8" sandstone, marked "4 HES 182", bears East 1.0', lying on its side;

An earth mound bears west 3.5';

A 48" Douglas Fir, good scar, bears N.72\*-40'W. 24.2' (record N.69\*-45'W. 23.76' per H.E.S. 182);

A 44" Douglas Fir, good scar, bears N.29\*-45'W. 50.2' (record N.26\*-30'W. 42.90' per H.E.S. 182);

An 8" Douglas Fir, scribing visible, bears N.20\*-20'E. 25.4' (record N.21\*E. 25.5' per Ren. #36);

A 6" Douglas Fir, scribing visible, bears S.87\*-40'E. 19.2' (record S.87\*E. 19.2' per Ren. #36).

