

SURVEY IN SECTION 2, T29S, R7W, W.M.

FILED *BS*  
RECEIVED *BS*

MAR 10 1983

COUNTY SURVEYOR  
DOUGLAS COUNTY, ORE.

*BS*

SURVEY FOR: VEL & JOHN KOOPMANS

BY: AA SURVEYING SERVICE, INC.  
P.O. BOX 130  
ROSEBURG, OR 97470

COUNTY SURVEYORS FILE DATA  
DO NOT REMOVE FROM OFFICE

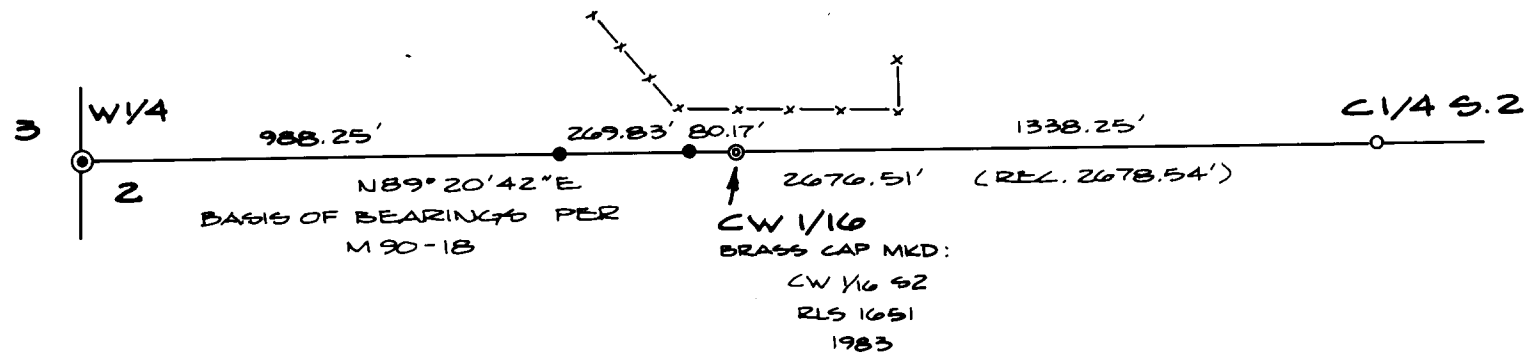

SCALE: 1" = 400'  
MARCH 1983

LEGEND:

- ⊙ FOUND 1" IRON PIPE WITH BRASS CAP MARKED "RLS 536 1980"
- FOUND 5/8" IRON ROD WITH BRASS WASHER MKD. "LS 1903" PER M 90-18
- SET 5/8" x 30" IRON ROD WITH ALUM. CAP MKD "AA SURVEYING SERVICE"
- ⊙ SET 1" x 36" IRON PIPE WITH 2 1/2" BRASS CAP FLUSH WITH GROUND, FROM WHICH DESCRIBED NEW BT.'S:  
12" OAK BEARS N 30° 30' W 113.64 FT. SCRIBED "CW 1/16 S2 BT"  
10" OAK BEARS N 18° 45' E 106.19 FT. SCRIBED "CW 1/16 S2 BT"

NARRATIVE:

THE PURPOSE OF THIS SURVEY IS TO ESTABLISH THE CW 1/16 CORNER AND SET MONUMENTS ON THE SOUTH LINE OF THE SW 1/4 OF THE NW 1/4 OF SECTION 2.  
THE SURVEY M 90-18 WAS USED AS THE BASIS OF THIS SURVEY.  
INSTRUMENT USED WAS A TOPCON TOTAL STATION GUPPY.

x-x-x-x FENCE LINE

REGISTERED  
PROFESSIONAL  
LAND SURVEYOR

*Herman A. Pieske*

OREGON  
JULY 14, 1978  
HERMAN A. PIESKE  
1651

323-83