

CERTIFIED RECORD OF LAND CORNER MONUMENTATION

History of original corner establishment:

August, 1857, Hathorn

- Set Post 16, 17, 20 & 21
- 18" Cedar, N45°W, 4 Lks
- 12" Yew, N5°E, 40 Lks
- 15" Hemlock, S2°E, 29 Lks
- 12" Fir, S65°W, 153 Lks

June, 1908, Mensch

- Destroyed bearing trees for 17, 20 & 21
- Set 18"x8"x8" stone, 4 notches one East
- 10" Fir N35°E 60 Lks, T31S, R2W, S16

June, 1961, County Surveyor

- Set Iron pipe with Brass cap marked "T31S, R2W, S16 SW Cor Sec 16 BT"
- Scribed 15" D. Fir, N82°E, 65.2 ft "T31S, R2W, S16 BT"

Description of corner evidence found:

Found 1" pipe with 2½" brass cap marked as shown

- 36" Cedar, N82°W, 3.0 ft. scars
- 20" D. Fir, N81°E, 65.0 ft good scar

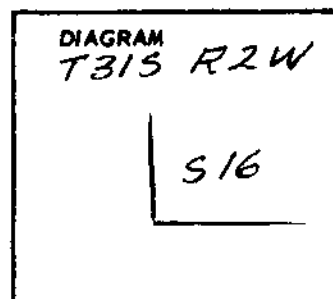

FILED
RECEIVED *✓*

FEB 22 1979

COUNTY SURVEYOR
DOUGLAS COUNTY, OR.

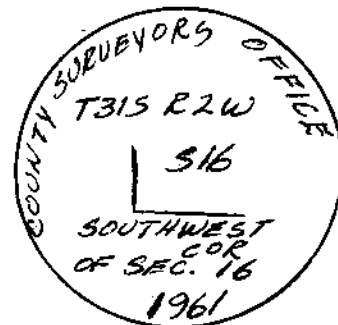

Description of monument and accessories I established to perpetuate the original location of this corner

Scribed "T31S, R2W, S16 BT" on 16" D. Fir N29½°E, 34.5 ft.
Attached brass washer "LS 866" to lower blaze.

Bearing based on solar observation
Mag. decl. approx. 21° East

[Signature]

Office of County Surveyor County of Douglas
 State of Oregon, I hereby certify that the within instrument was filed in this office
 for record on the 22 day of February, 1979, at 4 o'clock P.m., (signed)
FRANCIS L. INGRAM by Gregory E. Tubell
 (COUNTY OFFICIAL) (DEPUTY)

#197 X