

CERTIFIED RECORD OF CORNER PERPETUATION

This corner was originally established by Rufus Moore in 1883 and subsequently re-established by Hans W. Thielsen in 1955 from the original record of Moore.

T32S, R1W, W.M.
310 | 511
515 | 314

I find a 2 inch outside diameter iron pipe, firmly set with a brass cap attached, from which the bearing trees recorded by Thielsen were found as follows:

- A dead and down Hemlock with scribe visible, the root depression of which bears record N 4½° W 53.5 ft.
- A Douglas Fir 24" diam. with healed blaze bears N 83½° E 51.7 ft. (record N 83½° E 52.8 ft.)
- A Hemlock, dead and standing with unhealed blaze and scribe visible bears S 41° E 33.7 ft. (record S 41° E 35 ft.)
- A Hemlock, dead and standing with scribe visible in unhealed blaze bears S 74½° W 63.7ft. (record S 74½° W 64 ft.)

I perpetuate the corner position by taking the following new bearing trees and place a brass washer bearing my registration No. in the lower blaze:

- A Douglas Fir 6 inch diam. marked "T32S R1W S10 BT" bears N 30° W 8.6 ft.
- A Hemlock 6 inch diam. marked "T32S R1W S 14 BT" bears S 17½° E 12.3 ft.
- A Douglas Fir 6 inch diam. marked "T32S R1W S 15 BT" bears S 38½° W. 20.9 ft.

Va. = 23°

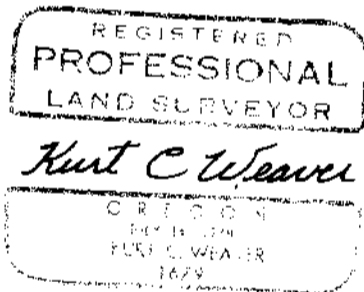

I hereby certify the above corner perpetuated as herein described on November 17, 1978.

Witnesses:

Herb Farber
Reg Harding

Office of Surveyor County of Douglas, State of Oregon, I hereby certify that the within instrument was filed in this office for record on 8th day of December, 1978.

Francis L. Ingram by *Virginia C. Rugon*
County Surveyor Deputy

JK

#67 X