

**COUNTY SURVEYORS FILE DATA  
DO NOT REMOVE FROM OFFICE**

**SURVEY TO SET S 1/16 CORNER TO SECTIONS  
11 AND 12, T28 S, R5 W, WILLAMETTE MERIDIAN  
SURVEYED FOR LEWIS A. HOWE AND VIRGINIA L. HOWE  
BY HOWARD W. JOHNSTONE, 1891 S.W. LINNELL, ROSEBURG, ORE.  
February 28, 1980 Scale: 1" = 400'**

I traversed between the Corner to Sec. 11, 12, 13 & 14 and the 1/4 Corner to Sec. 11 & 12 using a Jona 1 Second theodolite and a Mac 1E EDM. I set the 1/16 Cor. at the midpoint.

- Monument Found
- Monument Set

Bearing Based on Byrons 1957 Survey

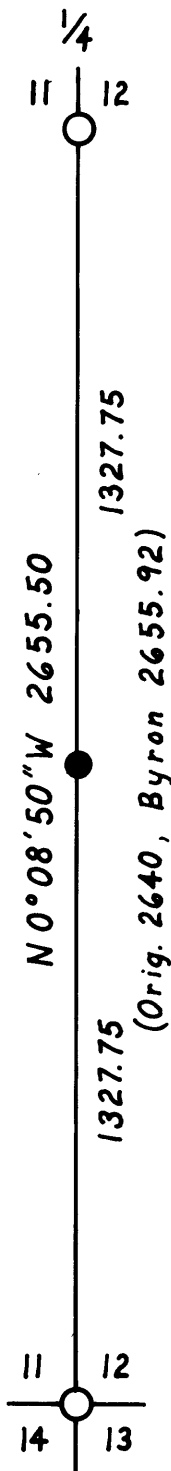

Found 1977 County Surveyor BCIP  
Fd. 3/4" IR in Fence S74°W 41.3  
BTs: 16" Fork of Oak S74°W 162.0  
30" Oak S16°W 340.7

Set 5/8" x 36" IR  
BTs: 8" Oak N42°E 43.8  
11" Oak S11°W 18.7

Found 1957 County Surveyor BCIP  
BTs: 16" Oak West 39.6  
12" Oak N40°W 58.6  
No trees East within reasonable distance



REGISTERED  
PROFESSIONAL  
LAND SURVEYOR

*Howard W. Johnstone*

OREGON  
MAY 13, 1980  
HOWARD W. JOHNSTONE  
498

FILED &  
RECEIVED *v/h*  
MAR 3 1980 *dh*

COUNTY SURVEYOR  
DOUGLAS COUNTY, ORE.  
&