

HEWITT LANE 60'

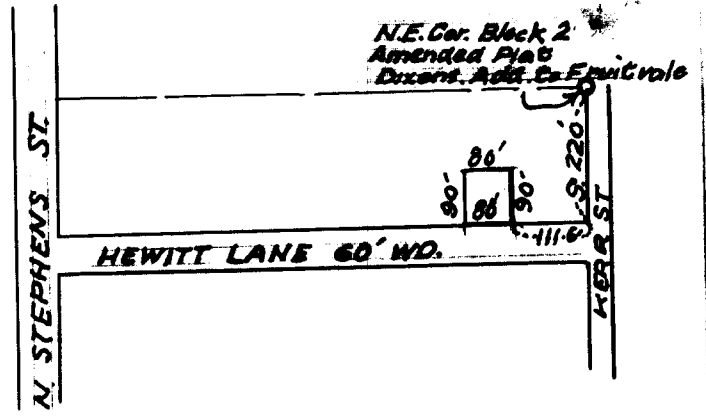
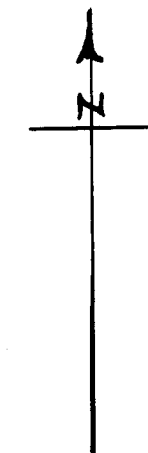

This point is 220's & 111.6' W. of the N.E. Cor. Block 2 Amended Plat of Dixon's Add. to Fruitvale.

FILED ✓
RECEIVED ✓/L

APR 7 1978

COUNTY SURVEYOR
DOUGLAS COUNTY, ORE.

**COUNTY SURVEYORS FILE DAT
DO NOT REMOVE FROM OFFICE**

L.J. HEWITT PROPERTY
IN BLOCK 2, AMENDED PLAT
OF DIXONS ADD. TO FRUITVALE
IN SEC. 12, T.27S; R.6W; W.M.
DEC. 1956 AB. 1" = 20' 1" = 300'