

M 71-79

RESTORED CORNER FOR STATE OF OREGON--DEPARTMENT OF FORESTRY

One quarter corner common to Sections 19 and 24, T32S, R6 & 7W, W.M., Douglas County, Oregon.

ORIGINAL

2-7-19

Laurel Post (remains of point found) from which a:

- 36" Fir bears S48°E 45 lks.; now 52" x 25' high burnt and shattered snag in place, 48 lks. to center, exposed axe work at top of face and chaining notch at bottom of face.
- 38" Fir bears N52°W 30 lks.; now stump hole with portions of roots remaining, 32½ lks. to center of stump hole.

RESTORED

Set 1½" x 36" galvanized iron pipe with 3" bronze cap marked "OREGON STATE BOARD OF FORESTRY T32S 1/4 R7W R6W S24 S19 1978 RS1101", 34 inches in ground, and from which a:

- 27" Fir bears S35°W 23.8 ft. to face; scribed 1/4 S24 BT RS1101.
- 10" Madrone bears S72°E 21.1 ft. to face; scribed 1/4 S19 BT RS1101.

Set 4" x 4" x 72" white painted Cedar post N58°E 2.9 ft. from corner pipe. Oregon State Forestry Department metal location poster on 11" Madrone N40°W 3.2 ft.

B.L.M. pipe and cap N06° 53'W 21.3 ft., to be obliterated by B.L.M.

Dated March 13, 1978

Restored by James M. McIntosh under my direction.
James M. McIntosh, Engineer

Present and witnessed by David B. Buchholz
Christopher L. Hughes

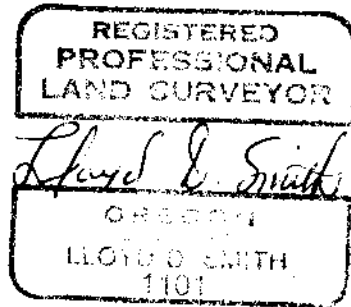

FILED
RECEIVED *dl*

COUNTY SURVEYOR
DOUGLAS COUNTY, ORE.

#150 T32-6 X
#151 T32-7 X

O.S. File No. 58/167-2c