

6-5T/85

LAND SURVEY of SOUTH LINE

COUNTY SURVEYORS FILE DATA
DO NOT REMOVE FROM OFFICE

Sec. 23, T. 32 S., R. 6 W., W.M., Douglas County, Oregon

BY: Ronald A. Brandt, P.S. 841
THE ROBERT DOLLAR CO.
P.O. Box C, Glendale, Ore. 97442

SCALE:
1 in. = 500 ft.

Purpose: to establish the 1/4 Corner common to Sections 23 and 26.

Equipment: 30 Sec. Gurley Transit.

Basis-of-Bearing: Solar Observation, July 6, 1977.

Date of Survey: July 6-27, 1977.

Witnesses: Rodney Evens, Mallory Hicklin, Clyde Anderson.

Monuments: as indicated.

REGISTERED
PROFESSIONAL
LAND SURVEYOR

Ronald A. Brandt

OREGON
JULY 12, 1968
RONALD A. BRANDT
841



(ORIGINAL SURVEY, 1881
S 89° 26' E, 5227.86' = 79.21 Ch.)
N 89° 54' 47" E, 5226.74 ft.

1/4 CORNER
SET by
SINGLE-PROPORTION

SET 1" x 36" I. Rod, 6" high in Rock Pile
8" MAPLE, S 72° 30' E, 9.51', ser. 1/4 S 26 PS 841 BT
10" D.F., N 74° W, 30.26', ser. 1/4 S 23 PS 841 BT

EVIDENCE of ORIG. 1881 SURV. NOT FOUND, which was -

MAPLE POST
14" Madrone, N 34° E, 48 lbs.
16" D.F., S 50° W, 37 lbs.

— 3 MAN-DAYS search plus earlier SURVEYOR SEARCH = LOST.
Corner area not logged, but old burn left only burned stabs
and snags which have since become totally rotted-out.

AS PER C.S. FILES 51/262 and 40/306.

AS PER
C.S. FILE 53/21

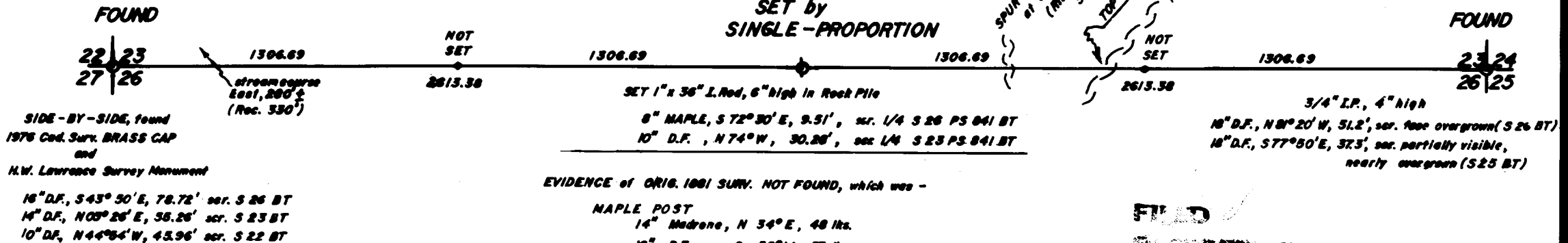

SIDE-BY-SIDE, found
1976 Cal. Surv. BRASS CAP
and
H.W. Lawrence Survey Monument

16" D.F., S 43° 50' E, 78.72' ser. S 26 BT
14" D.F., N 05° 26' E, 38.26' ser. S 23 BT
10" D.F., N 44° 04' W, 43.96' ser. S 22 BT

3/4" I.P., 4" high
16" D.F., N 01° 20' W, 51.2', ser. face overgrown (S 26 BT)
16" D.F., S 77° 50' E, 37.5', ser. partially visible,
nearly overgrown (S 25 BT)

NOTE: dist. and bearing meas. to face centers.
tree size is DBH.

FILED
RECORDED MLL

AUG 8 1977

COUNTY SURVEYOR
DOUGLAS COUNTY, ORE.