

M 97-79

FILED
RECEIVED *B*

DEC 18 1984

OREGON CORNER RESTORATION FORM

Section 7 Township 21 S Range 11 W

County DOUGLAS Date 12.3.84

COUNTY SURVEYOR
DOUGLAS COUNTY, ORE.

Corner Designation

12 | 7
13 | 18

- Condition Report Only
- Not Found
- Renewed
- Unrecorded
- Surveyed In
- Referenced Out

Previous Renewals/Surveys, etc. ORIGINAL SURVEY BY GORDON, 1857
DOUGLAS COUNTY RENEWAL # 59, 1970

Monument(s) & Accessories Found: (Condition and Source)

FOUND 2 1/2 IN BCIP, 5/8" IRON ROD, & 2" IRON PIPE

11" CEDAR BEARS N 33° 00' E, 26.0 FT (1970 BT)

18" FIR BEARS S 51° 00' E, 16.5 FT (1970 BT)

15" CEDAR BEARS S 15° 00' W, 4.9 FT (1970 BT)

24" CEDAR BEARS N 60° 00' W, 14.1 FT (1970 BT)

ROTTED REMAINS OF 1857 BT'S EXIST EXIST AS PER RECORD

Monument Detail

Sketch

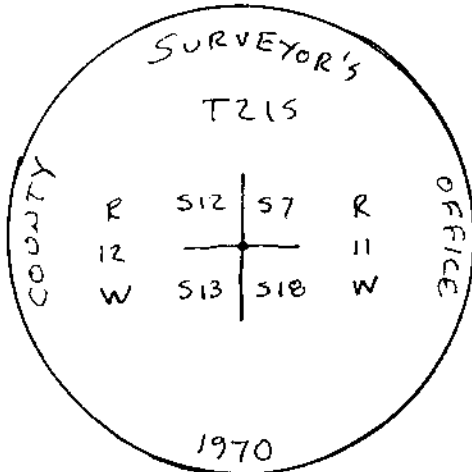

Monument Set (Procedures and Description)

NONE

New Accessories

NONE

Location & Comments

Surveyor's Seal

Compass Declination 20°E

Firm/Agency CHAMPION INTERNATIONAL CORP

Address P.O. BOX 37
MAPLETON, OR 97453

Party Chief G. MILLER

Notes R. RICE

Witness _____

