

WEYERHAEUSER COMPANY  
 S.W. OREGON REGION  
 SURVEY IN SECTION 8, T.25 S., R. 8 W., W.M.  
 DOUGLAS COUNTY, OREGON  
 MARCH 16, 1977

FILED ✓  
 RECEIVED *TH*  
 MAR 29 1977  
 COUNTY SURVEYOR  
 DOUGLAS COUNTY, ORE.  
 ✓

COUNTY SURVEYORS FILE DATA  
 DO NOT REMOVE FROM OFFICE

SCALE: 1" = 600'

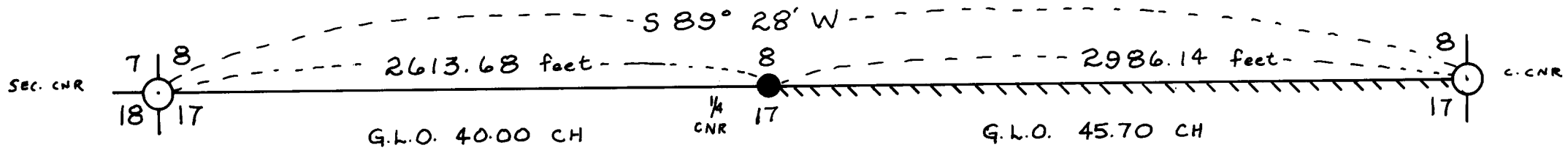

LEGEND

- CORNERS FOUND
- CORNERS SET
- LINE SURVEYED
- ▨ LINE BLAZED

REGISTERED  
 PROFESSIONAL  
 LAND SURVEYOR

*Michael S. McDowell*

OREGON  
 AUGUST 22, 1975  
 MICHAEL S. McDOWELL  
 1032

DRN: 3/15/77 MSM

APPROVED: *V. B. Reppets*

C. S. File No. 58/141 A

May 1, 1980

FILED  
RECEIVED *JH*  
MAY 6 1980  
COUNTY SURVEYOR  
DOUGLAS COUNTY, ORE.

Mr. Francis Ingram  
Douglas County Surveyor  
Justice Hall, Room 205  
Roseburg, Or. 97470

Dear Sir:

During March, 1977, Weyerhaeuser Company surveyed the boundary common to Sections 8 and 17, Twp25S - Rge8W and set the common 1/4 corner at the proportionate distance as described in the original GLO survey and recorded same in your office. Subsequently, cadastral surveyors from the Roseburg BLM office uncovered evidence of the original 1/4 corner at a point 181.1 feet west and remonumented it. 2100

On April 29, 1980, we destroyed all evidence of our set corner. If you haven't received the information on the remonumented BLM 1/4 corner, I will list what we found in the field. Original GLO records called for two alder bearing trees as follows:

OBT: 8" alder S75<sup>0</sup>W, 35 links,  
OBT: 10" alder N30<sup>0</sup>W, 20 links.

Found: BLM brass cap dated 1979 from which:  
12" alder snag OBT with face and BLM tag, S57 1/2<sup>0</sup>W, 35 links.  
16" alder OBT, scribing visible and BLM tag, N50 1/2<sup>0</sup>W, 20 links.  
8" red cedar (scribed 1979), S56 1/2<sup>0</sup>W, 06 1/2 links.  
14" red cedar, (scribed 1979), N49 1/2<sup>0</sup>W, 36 links.

Respectfully submitted,

*Henry R. Reppeto*  
Henry R. Reppeto

ORLS 618

HRR:ab

47.99

The  $\frac{1}{4}$  sec. cor. of secs. 8 and 17, determined at record distance from the remains of the original bearing trees.

An alder snag, 14 ins. diam., bears S.  $57\frac{1}{2}^\circ$  W., 35 lks. dist., (Record bearing S.  $75^\circ$  W.) illegible reverse scribe marks visible on opened blaze.

UNOFFICIAL  
35

Dependent Resurvey, Portion of Subdivision, T. 25 S., R. 8 W.

CHAINS

An alder, 16 ins. diam., bears N.  $53^\circ$  W., 20 lks. dist., (Record bearing N.  $30^\circ$  W.) illegible scribe marks visible on opened blaze.

At the corner point

Set an iron post, 28 ins. long,  $2\frac{1}{2}$  ins. diam., 24 ins. in the ground, with brass cap marked

T 25 S R 8 W

$\frac{1}{4}$   $\frac{S 8}{S 17}$

1979

from which new bearing trees

A cedar, 10 ins. diam., bears S.  $56\frac{1}{2}^\circ$  W.,  $6\frac{1}{2}$  lks. dist., marked  $\frac{1}{4}$  S17 BT.

A cedar, 15 ins. diam., bears N.  $49\frac{1}{2}^\circ$  W., 36 lks. dist., marked  $\frac{1}{4}$  S8 BT.

Corner is located on SW. slope 1.50 chs North of a graveled road, 25 lks. wide, bears N.  $45^\circ$  W. and S.  $45^\circ$  E.

Land, mountainous.

Soil, rocky clay.

Timber, yew, cedar, fir, hemlock, maple, alder, chincquapin, and dogwood; undergrowth, blackberry, huckleberry, salal, Oregon grape, vine maple, rhododendron, fern, manzanita, hazel, arrowwood, wild rose, and young timber.

Notes rec'd 4/30/80 - NOT APPROVED  
SURVEY -

- PENDING -

1979 FIELD WORK - B.L.M.

V.P.

UNITED STATES  
DEPARTMENT OF THE INTERIOR  
BUREAU OF LAND MANAGEMENT  
TOWNSHIP DIAGRAM  
SCALE: 1 INCH = 1 MILE

1979 ✓  
Rec'd  
11/14/80  
J.P.

TOWNSHIP 25 South, RANGE 8 West, Willamette MER.  
STATE Oregon

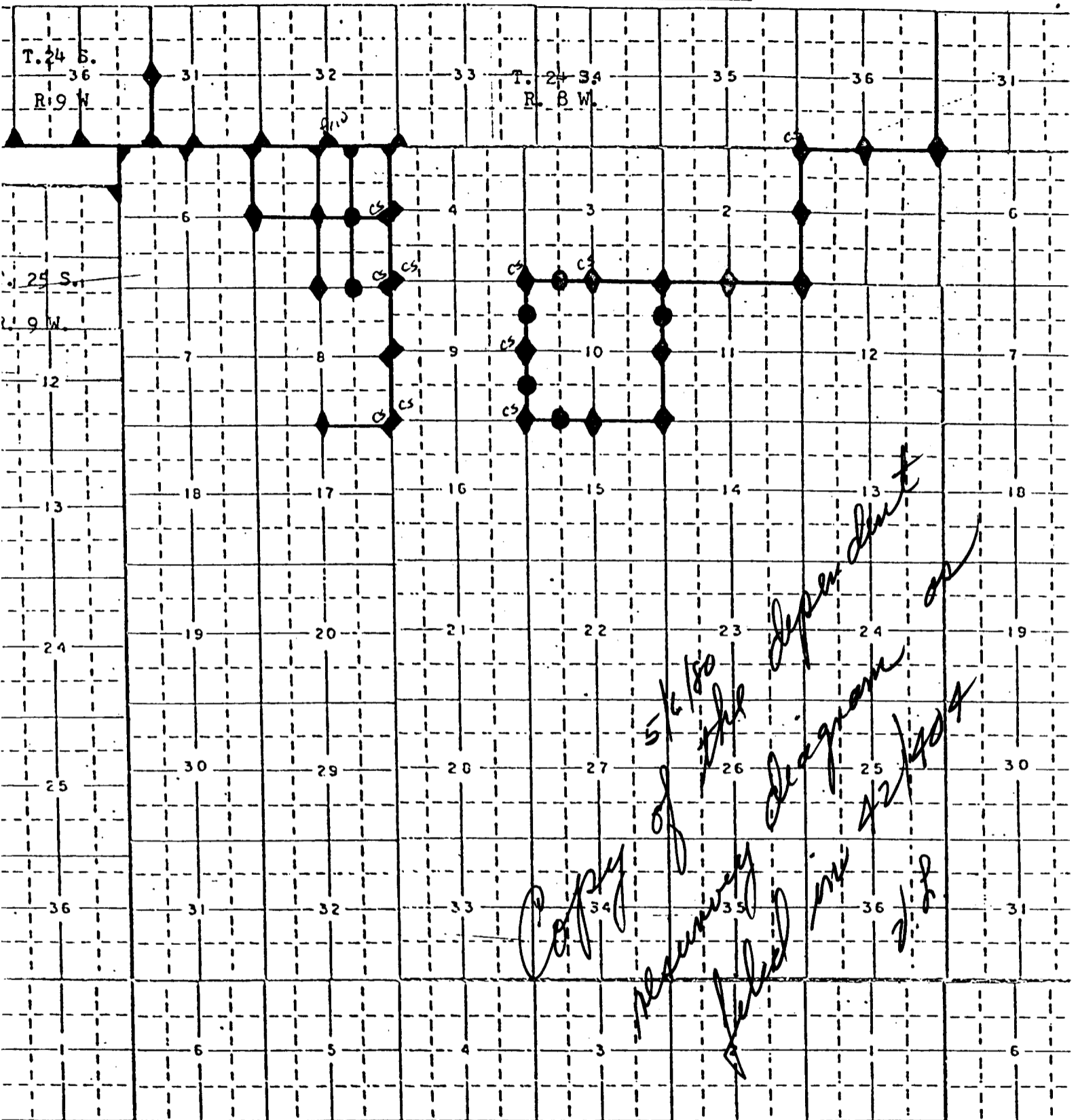

- ◆ Corner accepted or established
- 1/16 corner accepted or established
- Lines ran

TO:

Roseburg District Office

Coos Bay District Office

Douglas County Surveyors Office

G. S. File No. 58/141

G. S. File No. ~~12/141~~

WEYERHAEUSER COMPANY  
S. W. Oregon Region  
Survey in Sections 8 & 17, T. 25 S., R. 8 W., W.M.  
Douglas County, Oregon  
March 16, 1977

FILED  
RECEIVED *JK*

MAR 20 1977

COUNTY SURVEYOR  
DOUGLAS COUNTY, ORE.

General Information

This survey was conducted to re-establish the 1/4 corner between Sections 8 and 17, in order to establish company ownership boundaries. A closed traverse was run between control points, and the closure error was approximately 1/5500. Offsets to true line were calculated, and the property line was marked with blazes, aluminum strips, and candy-striped ribbon. Equipment used included a Wild T-16 theodolite and 300 foot steel tape.

Corner Record

The following information is a record of all corners either found or set in the course of this survey.

SE Corner Section 8 (common to sections 8 & 17 only)

Found: a 2 1/2" iron pipe with brass cap, from which:

a 14" hemlock BT (BLM tag and visible scribing) bears S. 46° W,  
21.3 feet

a 12" hemlock BT (BLM tag and visible scribing) bears N. 69° W,  
16.7 feet.

a 40" fir OBT (scribing visible) bears N. 51° W, 38.3 feet.

SW Corner Section 8 (common to sections 7,8,17 & 18)

Found: a 3/4" galvanized iron pipe, from which:

a 20" fir OBT (face evident) bears N. 02° E., 13.8 feet.

a 36" fir OBT (face evident) bears N. 43° W., 9.2 feet.

a "W" nail RP in the base of a 10" maple bears S. 04° E, 23.7 feet.

a "W" nail RP in the base of a 10" maple bears S. 74° W, 22.4 feet.

S 1/4\* Corner Section:

Set a 1 3/4" galvanized iron pipe with brass cap, from which:

a 40" fir BT bark scribed bears S. 15° E., 20.3 feet.

a 24" incense-cedar scribed BT bears N., 81° E, 61.5 feet.

#100 ✓

FILED  
RECEIVED *MS*

Respectfully Submitted,

MAR 20 1977

*Michael S. McDowell*

COUNTY SURVEYOR  
DOUGLAS COUNTY, ORE.

Michael S. McDowell  
L.S. 1032

Approved by:

*H.R. Reppeto*

H.R. Reppeto  
Region Engineer

REGISTERED  
PROFESSIONAL  
LAND SURVEYOR

*Michael S. McDowell*

OREGON  
AUGUST 22, 1975  
MICHAEL S. McDOWELL  
1032

MSD/tlb