

Survey of West 1/2 of North Line
 Sec. 2 T21S R4W W.M.
 Douglas County Oregon

by
 Weyerhaeuser Company April 1979

FILED ✓
 RECEIVED ✓
 JUN 18 1979
 COUNTY SURVEYOR
 DOUGLAS COUNTY, ORE.

COUNTY SURVEYORS FILE DATA
 DO NOT REMOVE FROM OFFICE

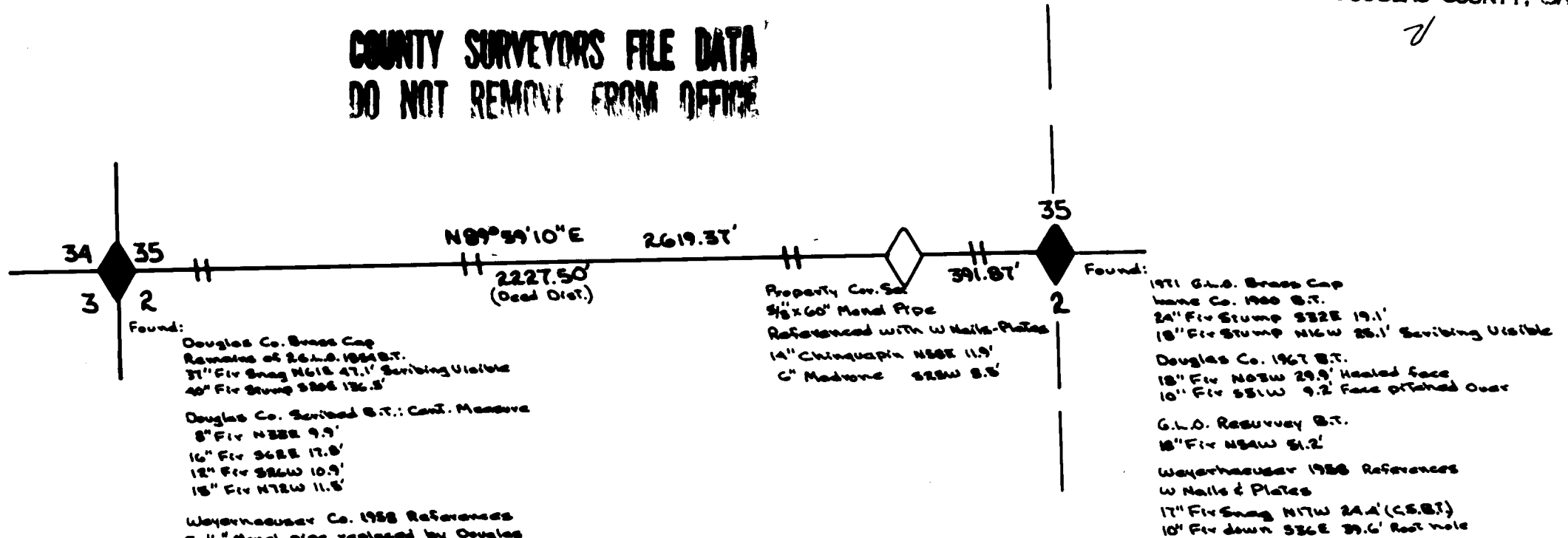

Found:
 Douglas Co. Brass Cap
 Remains of 26 L.S. 1964 B.T.
 31" Fir Snag N61E 47.1' Scribing Visible
 40" Fir Stump S80E 126.5'

Douglas Co. Scribed B.T.: Cont. Measure
 8" Fir N32E 9.9'
 16" Fir S62E 17.8'
 12" Fir S26W 10.9'
 15" Fir N72W 11.5'



Weyerhaeuser Co. 1958 References
 To 1/2" Monel pipe, replaced by Douglas
 Co. Brass Cap, Pipe now along side
 Bearings & Distances To W Nails
 31" Fir Snag N59E 46.0'
 16" Fir 360E 17.4'
 12" Fir S25W 10.3'
 15" Fir N71W 10.9'

Property Co. Set
 3/8" x 60" Monel Pipe
 Referenced with W Nails-Plates
 14" Chinquapin N58E 11.9'
 C Madrone S25W 8.5'

Found:
 1971 G.L.O. Brass Cap
 Lane Co. 1960 B.T.
 24" Fir Stump S22E 19.1'
 18" Fir Stump N16W 25.1' Scribing Visible
 Douglas Co. 1967 B.T.
 18" Fir N83W 29.9' Healed face
 10" Fir S51W 9.2' Face flattened Over
 G.L.O. Resurvey B.T.
 18" Fir N54W 51.2'
 Weyerhaeuser 1958 References
 W Nails & Plates
 17" Fir Snag N17W 24.4' (C.S.B.T.)
 10" Fir down S36E 39.6' Root hole

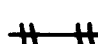

LEGEND

-  Corners found
-  Corners set
-  Property line blazed
Single notch in blaze

Bearing Assumed Decl. 20°E
 Linear Precision: 1 in 7078
 Scale: 1" = 400' D.L.E 5-11-79

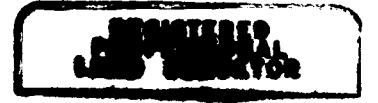

Frank O. Williams

